

**SINGER**

**421W301BA,303BA,307BA,311BA**

Parts  
List

*Odellene*

**SINGER**  
INDUSTRIAL PRODUCTS

*Spring to take out plug  
on button sewer clamp  
# 136961 spring  
# 1241 screw*

**421W301BA**

**421W303BA**

**421W307BA**

**421W311BA**

## CONTENTS

List of Parts for Machine 421W307BA .....	2
List of Parts for Machine 421W301BA .....	20
List of Parts for Machine 421W303BA .....	23
List of Parts for Machine 421W311BA .....	24
Accessories .....	26
Numerical List of Parts .....	31

**THE SINGER COMPANY**

Copyright © 1972 THE SINGER COMPANY  
All Rights Reserved Throughout the World

Memorandum

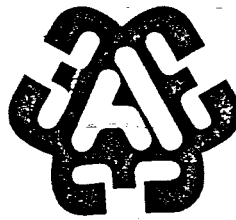

*M. Harper*  
**SINGER**

to: Mr. Z. Smith

from: Mr. S. E. vom Lehn

subject: PARTS LIST FOR SINGER FLAT BUTTON FEEDER  
AND VIBRATOR #2650-1

refer to: 27-M

date: 10-23-74

I am attaching a copy of my letter to Mr. J. Rockerath under this subject as well as a copy of the Parts List. I am also arranging to forward to you fifty of these lists for your use.

*S. E. vom Lehn*  
S. E. vom Lehn, Director  
Technical Services - IS&KPD

SEvL/jbm

enc.

**SINGER**

INDUSTRIAL SEWING PRODUCTS DIVISION

October 23, 1974  
27-M

Mr. J. L. Rockerath, President  
JET SEW, INC.  
Route 12  
P. O. Box 326  
Barneveld, New York

Dear Mr. Rockerath:

PARTS LIST FOR SINGER FLAT BUTTON FEEDER  
WITH VIBRATOR #2650-1

We recently discussed with you and with Murfreesboro the necessity of having a Parts List, which would be developed quickly, for Singer Flat Button Feeder and Vibrator #2650-1. It was agreed that I would develop such a Parts List, and it was further agreed that numbers would be assigned to the Jet Sew Clamp and Driving Units, as well as the Vibrator beginning with #JS 10001. A copy of the list is attached. We will make additional copies of this list and within the next week or so forward to you fifty copies. I am certain you will agree that a copy should accompany each unit shipped. It is hoped that in time, more effective Parts Lists including drawings or photographs can be made available.

Very truly yours,

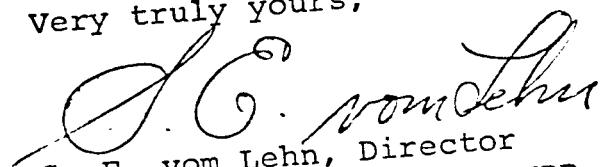
  
S. E. vom Lehn, Director  
Technical Services - IS&KPD

SEvL/jbm

enclosure

PARTS LIST 2650-1  
SINGER FLAT BUTTON FEEDER  
INCLUDING VIBRATOR (FOR 421X14, 15, 16 MACHINES)

page 1 of 4

JS10001	Button Clamp Arm with 17714
17714	Clamp Pressure Spring Guide Block
JS10002	Button Clamp Platform
JS10003	Button Clamp Platform Bushing Small
JS10004	Button Clamp Platform Bushing Large
JS10005	(4) Button Clamp Arm Attaching Screw
JS10006	Clamp Lifting Arm
JS10007	Clamp Lifting Arm Set Screw
JS10008	Clamp Lifting Connection
JS10009	(4) Clamp Lifting Connection and Chute Holding Screw
JS10010	(4) Clamp Lifting Connection and Chute Holding Screw Lock Washer
JS10011-13	Button Chute, 13 Ligne Button
JS10011-14	Button Chute, 14 Ligne Button
JS10011-15	Button Chute, 15 Ligne Button
JS10011-16	Button Chute, 16 Ligne Button
JS10011-17	Button Chute, 17 Ligne Button
JS10011-18	Button Chute, 18 Ligne Button
JS10011-19	Button Chute, 19 Ligne Button
JS10011-21	Button Chute, 21 Ligne Button
JS10012	Button Chute Rail Left
JS10013	Button Chute Rail Right
JS10014	(5) Button Chute Rail Set Screw
JS10015	Lower Oval Spring Button Guide Plate
JS10016	(2) Lower Oval Spring Button Guide Plate Screw
JS10017	Button Retainer Spring
JS10018	Button Retainer Spring Plate
JS10019	(2) Button Retainer Spring Set Screw
JS10020	(2) Button Retainer Spring Set Screw Lock Washer
JS10021	Button Feeder and Orientor Return Plunger Complete
JS10022	Button Feeder and Orientor Return Plunger Housing
JS10023	Button Feeder and Orientor Return Plunger Housing Bushing
JS10024	Button Feeder and Orientor Return Plunger
JS10025	Button Feeder and Orientor Return Plunger Spring
JS10026	Button Feeder and Orientor Return Plunger Spring Stop
JS10027	Button Feeder and Orientor Return Plunger Spring Stop Screw
JS10028	(2) Button Feeder and Orientor Return Plunger Housing Pinch Screw
JS10029	Button Feeder and Orientor Housing

JS10030 Button Orienter Driving Gear  
 JS10031-34 Button Orienter Driven Gear with Orienting Pins, 2-Hole, 13  
 JS10031-54 Button Orienter Driven Gear with Orienting Pins, 2-Hole, 15  
 JS10031-08 Button Orienter Driven Gear with Orienting Pins, 2-Hole, 10  
 JS10031-21 Button Orienter Driven Gear with Orienting Pins, 2-Hole, 12  
 JS10031-34 Button Orienter Driven Gear with Orienting Pins, 4-Hole, 13  
 JS10031-54 Button Orienter Driven Gear with Orienting Pins, 4-Hole, 15  
 JS10031-63 Button Orienter Driven Gear with Orienting Pins, 4-Hole, 16  
 JS10031-51 Button Orienter Driven Gear with Orienting Pins, 4-Hole, 15  
 JS10031-88 Button Orienter Driven Gear with Orienting Pins, 4-Hole, 18  
 JS10031-01 Button Orienter Driven Gear with Orienting Pins, 4-Hole, 20  
 JS10032 Button Feeder and Orienter Housing Cover  
 JS10033 (3) Button Feeder and Orienter Housing Cover Set Screw  
 JS10034 Button Orienter Driving Gear Actuator with Pin  
 JS10035 Button Orienter Driving Gear Actuator Retaining Screw  
 JS10036 (2) Button Feeder and Orienter Set Screw  
 JS10037 Button Orienter Drive Shaft  
 JS10038 Button Orienter Return Spring  
 JS10039 Button Orienter Return Spring Screw  
 JS10040 Button Feeder and Lifter Return Spring  
 JS10041 Button Feeder and Lifter Return Spring Screw  
 JS10042 Button Feeder and Orienter Return and Lifter Springs Screw  
 JS10043 Button Orienter Drive Shaft Lever  
 JS10044 (2) Button Orienter Drive Shaft Lever Set Screw  
 JS10045 Button Orienter Drive Shaft Lever Ball Connection  
 JS10046 Button Orienter Drive Shaft Lever Ball Connection Lock Washer  
 JS10047 Button Orienter Drive Shaft Lever Ball Connection Nut  
 JS10048 Button Feeder and Orienter Drive Shaft and Lifting Shaft  
 JS10049 Button Feeder and Orienter Drive Shaft and Lifting Shaft  
 JS10050 Button Feeder and Orienter Drive Shaft and Lifting Shaft  
 JS10051 Button Feeder Lifter Shaft  
 JS10052 Button Feeder Lifter Lever  
 JS10053 (2) Button Feeder Lifter Lever Set Screw  
 JS10054 Button Feeder Lifter Shaft Collar  
 JS10055 (2) Button Feeder Lifter Shaft Collar Set Screw  
 JS10056 Air Wiper Complete  
 JS10057 Air Wiper Block  
 JS10058 Air Wiper Tube  
 JS10059 Air Wiper Holding Bracket  
 JS10060 Air Wiper Air Adjusting Screw  
 JS10061 Air Wiper Bracket Set Screw  
 JS10062 (2) Air Wiper Set Screw  
 JS10063 Button Orienter Drive Rod  
 JS10064 Button Orienter Drive Rod Collar (Front)  
 JS10065 Button Orienter Drive Rod Collar (Front) Set Screw

JS10066 (2) Button Orientor Drive Rod (Rear) Collar  
JS10067 (2) Button Orientor Drive Rod (Rear) Collar Set Screw  
JS10068 Button Orientor Drive Lever (Upper)  
JS10069 Button Orientor Drive Lever Upper Ball Connector  
JS10070 Button Orientor Drive Lever Upper Ball Connector Lock Washer

JS10071 Button Orientor Drive Lever Upper Ball Connector Nut  
JS10072 (2) Button Orientor Drive Lever Set Screw  
JS10073 Button Orientor Drive Shaft  
JS10074 Button Orientor Drive Shaft Sleeve  
JS10075 Button Orientor Drive Lever (Lower)  
JS10076 (2) Button Orientor Drive Lever (Lower) Set Screw  
JS10077 Button Orientor Drive Follower Roller  
JS10078 Button Orientor Drive Follower Roller Screw  
JS10079 (2) Button Orientor Drive Cam  
JS10080 (4) Button Orientor Drive Cam Spacer  
JS10081 (4) Button Orientor Drive Cam Clamping Screw  
JS10082 (4) Button Orientor Drive Cam Washer  
JS10083 Button Feeder Driving Bracket  
JS10084 (2) Button Feeder Driving Bracket Set Screw  
JS10085 Button Feeder Driving Shaft  
JS10086 Button Feeder Driving Shaft Collar (Upper)  
JS10087 (2) Button Feeder Driving Shaft Collar (Upper) Set Screw  
JS10088 Button Feeder Driving Shaft Sleeve  
JS10089 (2) Button Feeder Driving Shaft Sleeve Set Screw  
JS10090 Button Feeder Driving Shaft Collar (Lower)  
JS10091 (2) Button Feeder Driving Shaft Collar (Lower) Set Screw  
JS10092 Button Feeder Drive Lever  
JS10093 Button Feeder Drive Lever Adjusting Screw  
JS10094 Button Feeder Drive Cable  
JS10095 Button Feeder Drive Cable Sleeve  
JS10096 Button Feeder Drive Cable Roller Bracket  
JS10097 (2) Button Feeder Drive Cable Roller Bracket Set Screw  
JS10098 Button Feeder Drive Cable Roller  
JS10099 Button Feeder Drive Cable Roller Shaft  
JS10100 (2) Button Feeder Drive Cable Roller Shaft Screw  
JS10101 (2) Button Feeder Drive Cable Roller Shaft Washer  
JS10102 Button Feeder Drive Cable Collar (Upper)  
JS10103 (2) Button Feeder Drive Cable Collar (Upper) Set Screw  
JS10104 Button Feeder Drive Cable Connector  
JS10105 (2) Button Feeder Drive Cable Connector Nut  
JS10106 Button Feeder Drive Cable Overload Spring  
JS10107 Button Feeder Drive Cable Adjusting Collar  
JS10108 (4) Button Feeder Drive Cable Adjusting Collar Set Screw  
JS10109 (2) Button Feeder Drive Cable Adjusting Collar Adjusting Nut



JS10110 Button Feeder Lifting Bracket  
JS10111 (2) Button Feeder Lifting Bracket Set Screw  
JS10112 Button Feeder Lifting Actuating Arm  
JS10113 Button Feeder Lifting Actuating Arm Set Screw  
JS10114 Button Feeder Lifting Actuating Arm Adjusting Extension  
JS10115 Button Feeder Lifting Actuating Arm Adjusting Extension Nut  
JS10116 Button Oval Spring Guide  
JS10117 Button Hopper Complete  
JS10118 Syntron Button Hopper Vibrator Complete  
JS10119 Button Hopper Body  
JS10120 Button Hopper Body Holding Screw  
JS10121 Button Hopper Body Holding Washer  
JS10122 Button Hopper Body Baffle  
JS10123 Button Hopper Guide Plate  
JS10124 (2) Button Hopper Guide Plate Screw  
JS10125 Button Orientor Plate  
JS10126 Button Orientor Plate Screw  
JS10127 Button Guide (Plastic)  
JS10128 (2) Button Guide Screw  
JS10129 Upper Oval Spring Button Guide Plate  
JS10130 Upper Oval Spring Button Guide Plate Screw  
JS10131 Button Hopper Vibrator Mounting Plate  
JS10132 (3) Button Hopper Vibrator Mounting Plate Support  
JS10133 (3) Button Hopper Vibrator Mounting Plate Support Screw  
JS10134 (3) Button Hopper Vibrator Mounting Plate Support Bolt  
JS10135 (3) Button Hopper Vibrator Mounting Plate Support Washer

**LIST OF PARTS COMPLETE  
FOR  
MACHINE NO. 421W307BA**

For sewing two- or four-hole flat buttons (size 13 ligne through 50 ligne) and snap fasteners (size 0 through 000) with 16 stitches. The work clamp moves alternately back and forth lengthwise of the cylinder.

No.	Plate	Description	No.	Plate	Description
			175065	7201-2	Arm Cover (front) Thread Guide Roller Pin.....
			223710	7201-2	Arm Cover (front) Thread Retainer with 200397(833).....
			185(809)	7201-2	Arm Cover (front) Thread Retainer Screw (2).....
			136818	7201-2	Arm Cover (front) Thread Retainer Screw Washer (2).....
			210993	7201-2	Arm Cover (front) Thread Retainer Sleeve.....
			223844	7201-2	Arm Cover (front) Thread Retainer Spring.....
			210957	7201-2	Arm Cover (front) Thread Retainer Stud.....
			210958	7201-2	Arm Cover (front) Thread Retainer Stud Collar.....
			200397(833)	7201-2	Arm Cover (front) Thread Retainer Stud Set Screw.....
			223711	7201-2	Arm Cover (front) Thread Retainer complete, Nos. 210957, 210958, 210993, 223710 and 223844
			239223-451	7201-1	Arm Cover (side).....
			141060(819)	7201-1	Arm Cover (side) Screw (4).....
			136846	-----	Arm Plug (right).....
			998(830)	-----	Arm Plug (right) Set Screw.....
			16532	7201-19	Arm Position Pin (2).....
			141069(869)	7201-19	Arm Screw (3).....
			136861	-----	Arm Shaft (horizontal) with 23477
			136792	7201-3	Arm Shaft (horizontal) Bevel Gear with two 141469(869).....
			141469(869)	7201-3	Arm Shaft (horizontal) Bevel Gear Set Screw (2).....
			167012	7201-3	Arm Shaft (horizontal) Bushing (back).....
			167013	7201-3	Arm Shaft (horizontal) Bushing (back) 167012 with 53618(805), 141128(833), 202299, 239374 and two 239383.....
			202299	7201-3	Arm Shaft (horizontal) Bushing (back) Oil Packing (wick).....
			141061(803)	7201-3	Arm Shaft (horizontal) Bushing (back) Set Screw.....
			141128(833)	7201-3	Arm Shaft (horizontal) Bushing (back) Support Screw.....
			53618(805)	7201-3	Arm Shaft (horizontal) Bushing (back) Support Screw Lock Nut....
			167049	7201-3	Arm Shaft (horizontal) Bushing (center).....
			223847	7201-3	Arm Shaft (horizontal) Bushing (center) Oil Packing (wick).....
			141076(830)	7201-3	Arm Shaft (horizontal) Bushing (center) Set Screw.....
167330	7201-12	Adjusting Device complete, Nos. 1654(803), 2018, 141550(803), 167329, 239533, 239534, 239536, two each 1620(905), 53626(803), 141545(803), 167335, 167449, 350812-869, and three each 167459 and 202622.....			
239221	7201-1	Arm Cover (center).....			
140082(819)	7201-1	Arm Cover (center) Screw (2).....			
136806	7201-2	Arm Cover (front).....			
136858	7201-2	Arm Cover (front) complete, Nos. 230(805), 136806, 136888, 140438(819), 175062, 175063, 175065, 202098, 223711, 228739, two each 185(809) and 136818.....			
792(819)	7201-2	Arm Cover (front) Screw (2).....			
228739	7201-2	Arm Cover (front) Thread Eyelet..			
136888	7201-2	Arm Cover (front) Thread Guide (wire).....			
140438(819)	7201-2	Arm Cover (front) Thread Guide (wire) Screw.....			
175062	7201-2	Arm Cover (front) Thread Guide Plate.....			
230(805)	7201-2	Arm Cover (front) Thread Guide Plate Screw.....			
175063	7201-2	Arm Cover (front) Thread Guide Plate Screw Spacing Collar.....			
202098	7201-2	Arm Cover (front) Thread Guide Roller.....			

No.	Plate	Description	No.	Plate	Description
239228	7201-3	Arm Shaft (horizontal) Bushing (front).....	650(803)	7201-7	Button Clamp Guiding Screw (2 Hole Buttons).....
223847	7201-3	Arm Shaft (horizontal) Bushing (front) Oil Packing (wick).....	136802	7201-7	Button Clamp Guiding Screw (2 Hole Buttons) Drag Spring.....
59704	7201-3	Arm Shaft (upright).....	136898	7201-7	Button Clamp Guiding Screw (2 Hole Buttons) Guide Block.....
136719	7201-3	Arm Shaft (upright) 59704 with 59707 and 59708.....	792(819)	7201-7	Button Clamp Guiding Screw (2 Hole Buttons) Guide Block Fastening Screw (2).....
59707	7201-3	Arm Shaft (upright) Bevel Gear (lower) with two 1253(830).....	136827	7201-7	Button Clamp Guiding Screw (2 Hole Buttons) Holder.....
1253(830)	7201-3	Arm Shaft (upright) Bevel Gear (lower) Set Screw (2).....	136828	7201-7	Button Clamp Guiding Screw (2 Hole Buttons) Stop.....
59708	7201-3	Arm Shaft (upright) Bevel Gear (upper) with two 1253(830).....	1175(850)	7201-7	Button Clamp Hinge Screw (2).....
1253(830)	7201-3	Arm Shaft (upright) Bevel Gear (upper) Set Screw (2).....	239211	7201-4	Clamp Lifting Bar with 176(819)...
136793	7201-3	Arm Shaft (upright) Bushing (lower).....	239212	7201-4	Clamp Lifting Bar Bushing (lower).
136794	7201-3	Arm Shaft (upright) Bushing (upper).....	239213	7201-4	Clamp Lifting Bar Position Guide with 167007, 200072(803) and 239515.....
167017	7201-3	Arm Shaft (upright) Hole Cover...	200072(803)	7201-4	Clamp Lifting Bar Position Guide Clamping Screw.....
136598	7201-5	Button Clamp (left) with 17723, 45329 and three 36696.....	350799(819)	7201-4	Clamp Lifting Bar Pressure Regulating Screw.....
167317	7201-5	Button Clamp (left) Adjusting Spring.....	239214	7201-4	Clamp Lifting Bar Spring.....
36696	7201-5	Button Clamp (left) Pad Pin (3)..	141061(803)	7201-4	Clamp Lifting Bar Stop Screw.....
17723	7201-5	Button Clamp (left) Screw Stud...	1662(805)	7201-4	Clamp Lifting Bar Stop Screw Nut..
136600	7201-5	Button Clamp (left) Spring.....	167004	7201-4	Clamp Lifting Rock Shaft with 141059(830).....
45329	7201-5	Button Clamp (left) Spring Position Pin.....	259470	7201-4	Clamp Lifting Rock Shaft Collar with 201188(803).....
230(819)	7201-5	Button Clamp (left) Spring Screw.	201188(803)	7201-4	Clamp Lifting Rock Shaft Collar Set Screw.....
136601	7201-5	Button Clamp (right) with 17723, 45329 and three 36696.....	167277	7201-4	Clamp Lifting Rock Shaft Collar (knurled) with 465(830).....
167319	7201-5	Button Clamp (right) Adjusting Spring.....	465(830)	7201-4	Clamp Lifting Rock Shaft Collar (knurled) Set Screw.....
36696	7201-5	Button Clamp (right) Pad Pin (3).	167278	7201-4	Clamp Lifting Rock Shaft Collar (knurled) Spring.....
17723	7201-5	Button Clamp (right) Screw Stud..	167006	7201-4	Clamp Lifting Rock Shaft Lifting Arm with 350604(869).....
136603	7201-5	Button Clamp (right) Spring.....	350604(869)	7201-4	Clamp Lifting Rock Shaft Lifting Arm Clamping Screw.....
45329	7201-5	Button Clamp (right) Spring Position Pin.....	167007	7201-4	Clamp Lifting Rock Shaft Lifting Link.....
230(819)	7201-5	Button Clamp (right) Spring Screw	239218	7201-4	Clamp Lifting Rock Shaft Lifting Link Connection.....
167320	7201-5	Button Clamp Arm with 17714.....	141059(830)	7201-4	Clamp Lifting Rock Shaft Lifting Link Connection Screw.....
167321	7201-5	Button Clamp Arm complete, Nos. 202(819), 1182(819), 167320 and 167322.....	239515	7201-4	Clamp Lifting Rock Shaft Lifting Link Hinge Pin.....
17710	7201-7	Clamp Arm Hinge Plate.....	124733	7201-5	Button Clamp Opening Lever.....
1176(819)	7201-7	Clamp Arm Hinge Plate Screw.....	167323	7201-5	Button Clamp Opening Lever Bracket
167322	7201-5	Clamp Arm Hook with 63825.....			
202(819)	7201-5	Clamp Arm Hook Screw (left).....			
1182(819)	7201-5	Clamp Arm Hook Screw (right).....			
63825	7201-5	Clamp Arm Hook Stud.....			
136890	7201-4	Clamp Foot Lifter.....			
176(819)	7201-4	Clamp Foot Lifter Screw.....			

No.	Plate	Description	No.	Plate	Description
1182(819)	7201-5	Button Clamp Opening Lever Bracket Screw (2).....	167325	7201-5	Button Clamp complete, Nos. 99(819), 202(819), 1181(819), 1183(819), 1199(819), 39242, 50237(833), 63741, 124733, 124737, 124738, 124739, 136598, 136600, 136601, 136603, 136608, 167317, 167319, 167320, 167322, 167323, 167324, two each 230(819), 1175(850), 17718 and four 1184(819).....
124735	7201-4	Clamp Opening Lever Contact Piece	127470	-----	Button Clamp complete for 13 to 50 Ligne Thin Buttons (Optional Equip.)
239123	7201-4	Clamp Opening Lever Contact Piece Arm.....	141066(803)	7201-19	Cylinder Base Locating Screw (4)...
50117(833)	7201-4	Clamp Opening Lever Contact Piece Arm Screw.....	141067(805)	7201-19	Cylinder Base Locking Screw.....
1484(809)	7201-4	Clamp Opening Lever Contact Piece Screw.....	136854	7201-1	Cylinder Cover (bottom).....
17718	7201-4	Clamp Opening Lever Contact Piece Screw Washer.....	141140(819)	7201-1	Cylinder Cover (bottom) Screw (2)...
99(819)	7201-5	Button Clamp Opening Lever Hinge Screw.....	239533	7201-12	Cylinder Cover (side).....
39241	7201-7	Button Clamp Pressure Spring.....	1454(830)	7201-12	Cylinder Cover (side) Screw (2)...
239572	7201-7	Clamp Pressure Spring Bracket.....	136899	7201-7	Cylinder Cover Plate (top).....
1177(819)	7201-7	Clamp Pressure Spring Bracket Screw.....	691(819)	7201-7	Cylinder Cover Plate (top) Screw (5).....
17714	7201-5	Clamp Pressure Spring Guide Block	16532	7201-19	Cylinder Position Pin (2).....
141211(869)	7201-7	Clamp Pressure Spring Screw.....	141069(869)	7201-19	Cylinder Screw (2).....
39242	7201-5	Button Clamp Spreader.....	136863	7201-18	Feed Cam with two 167234 and four each 140352(830) and 167235.....
124737	7201-5	Button Clamp Spreader Lever.....	350600(869)	7201-18	Feed Cam Mounting Screw (3).....
124738	7201-5	Button Clamp Spreader Lever Adjusting Plate.....	210805	7201-18	Feed Cam Mounting Screw Washer (3)
1182(819)	7201-5	Button Clamp Spreader Lever Adjusting Plate Screw.....	239522	7201-17	Feed Cam Supporting Gear with 239245.....
17718	7201-5	Button Clamp Spreader Lever Adjusting Plate Screw Washer.....	167050	7201-17	Feed Cam Supporting Gear Bracket..
124739	7201-5	Button Clamp Spreader Lever Stop..	141069(869)	7201-17	Feed Cam Supporting Gear Bracket Screw.....
50237(833)	7201-5	Button Clamp Spreader Lever Stop Position Screw.....	202005	7201-17	Feed Cam Supporting Gear Bracket Washer.....
1182(819)	7201-5	Button Clamp Spreader Lever Stop Screw.....	239245	7201-17	Feed Cam Supporting Gear Cam Locating Pin.....
17718	7201-5	Button Clamp Spreader Lever Stop Screw Washer.....	141070(803)	7201-17	Feed Cam Supporting Gear Screw....
167324	7201-5	Button Clamp Spreader Spring.....	167234	7201-18	Feed Cam Tripping Point (2) (NOTE: For 421W301 (4).....
1181(819)	7201-5	Button Clamp Spreader Spring Screw Stud.....	140352(830)	7201-18	Feed Cam Tripping Point Screw (4) (NOTE: For 421W301 (8).....
63742	7201-5	Button Clamp Spreader Steady Pin (long).....	167235	7201-18	Feed Cam Tripping Point Screw Washer (4) (NOTE: For 421W301 (8)...
17720	7201-5	Button Clamp Spreader Steady Pin (short).....	136893	7201-7	Feed Plate.....
63741	7201-5	Button Clamp Spreader Thumb Plate	167029	7201-7	Feed Plate Carrier Bar.....
1199(819)	7201-5	Button Clamp Spreader Thumb Plate Screw.....	136904	7201-7	Feed Plate Carrier Bar 167029 with 136899, 141071(819), and 167055...
136608	7201-5	Button Clamp Stop with 17720 and 63742.....	167054	7201-7	Feed Plate Carrier Bar Driving Block with 239501.....
1183(819)	7201-5	Button Clamp Stop Screw.....	167055	7201-7	Feed Plate Carrier Bar Driving Block complete, Nos. 167054 and 167056.....
			239250	7201-7	Feed Plate Carrier Bar Driving Block Oscillating Slide Stud.....

No.	Plate	Description	No.	Plate	Description
239501	7201-7	Feed Plate Carrier Bar Driving Block Pin.....	190(805)	7201-8	Knife Driving Bar Stop (in bracket) Screw (2).....
141071(819)	7201-7	Feed Plate Carrier Bar Driving Block Screw.....	136892	7201-8	Knife Driving Bar Stop (nylon)...
167056	7201-7	Feed Plate Carrier Bar Driving Block Spacer.....	140049(805)	7201-8	Knife Driving Bar Stop Screw.....
239448	7201-7	Feed Plate Carrier Bar Driving Block Spacer Position Pin (2)....	136823	7201-8	Knife Holder.....
136907	7201-8	Knife (thread cutting).....	50018(806)	7201-8	Knife Holder Screw.....
136908	7201-8	Knife (thread cutting) Mounting Fork.....	1547(803)	7201-8	Knife Holder Screw Nut.....
1034(805)	7201-8	Knife (thread cutting) Screw....	59739	7201-8	Knife Holder Stud.....
136820	7201-8	Knife Cocking Lever with 769(850) and 1698(805).....	239534	7201-12	Lateral Adjusting Lever.....
136815	7201-8	Knife Cocking Lever Multiplier with 1226(803).....	141545(803)	7201-12	Lateral Adjusting Lever Hinge Screw.....
350805(803)	7201-8	Knife Cocking Lever Multiplier Hinge Screw.....	167459	7201-12	Lateral Adjusting Lever Hinge Screw Friction Washer.....
140159(830)	7201-8	Knife Cocking Lever Screw (2)....	1620(805)	7201-12	Lateral Adjusting Lever Hinge Screw Nut.....
175175	7201-8	Knife Cocking Lever Screw Washer (2).....	202622	7201-12	Lateral Adjusting Lever Hinge Screw Nut Washer
136821	7201-8	Knife Driver (adjustable).....	2018	7201-12	Lateral Adjusting Lever Spacing Washer.....
207(805)	7201-8	Knife Driver (adjustable) Screw (2).....	136824	7201-10	Lateral Pivot and Feed Plate Carrier Bar Connecting Arm.....
136857	7201-8	Knife Driving Bar.....	136826	7201-10	Lateral Feed Throw-out Collar....
136894	7201-8	Knife Driving Bar Bumper (Nylon).	350800(869)	7201-10	Lateral Feed Throw-out Collar Positioning Screw (3).....
1289(819)	7201-8	Knife Driving Bar Bumper Screw...	149797	7201-10	Lateral Feed Throw-out Collar Retaining Ring.....
136895	7201-8	Knife Driving Bar Bumper Screw Nut.....	350802(830)	7201-10	Lateral Feed Throw-out Screw....
7071	7201-8	Knife Driving Bar Bumper Screw washer.....	214529	7201-10	Lateral Feed Throw-out Screw Drag Spring.....
136896	7201-8	Knife Driving Bar Bumper Complete, Nos. 1289(819), 7071, 136894 and 136895.....	136829	7201-10	Lateral Pivot Driving Arm.....
136816	7201-8	Knife Driving Bar Latch with 171(819) and 51701(819).....	136830	7201-10	Lateral Pivot Driving Arm 136829 with 1519(805), 136826, 141075(803), 214529, 239266, 350802(830) and three 350800(869).
350805(803)	7201-8	Knife Driving Bar Latch Hinge Screw.....	239264	7201-11	Lateral Rock Shaft.....
136868	7201-8	Knife Driving Bar Latch Spring...	239160	7201-11	Lateral Rock Shaft 239264 with 51951.....
1226(803)	7201-8	Knife Driving Bar Latch Spring Stud Screw (lower).....	51951	7201-11	Lateral Rock Shaft Cam Follower
171(819)	7201-8	Knife Driving Bar Latch Spring Stud Screw (upper).....	1655(803)	7201-21	Roller and Screw Stud, Nos. 1655(803), 5968 and 37310.....
51701(819)	7201-8	Knife Driving Bar Latch Spring Stud Screw (upper) Lock Nut.....	37310	7201-11	Lateral Rock Shaft Cam Follower
769(850)	7201-8	Knife Driving Bar Latch Tripping Screw.....	5968	7201-21	Roller Screw Stud Nut.....
1698(805)	7201-8	Knife Driving Bar Latch Tripping Screw Nut.....	167416	7201-11	Lateral Rock Shaft Cam Follower Roller Screw Stud Nut Washer....
136801	7201-8	Knife Driving Bar Spring.....	140321(830)	7201-11	Lateral Rock Shaft Cam Follower Roller Washer.....
1226(803)	7201-8	Knife Driving Bar Spring Stud Screw (2).....	239265	7201-11	Lateral Rock Shaft Collar with two 140321(830).....
136856	7201-8	Knife Driving Bar Stop (in bracket).....	239266	7201-10	Lateral Rock Shaft Collar Set Screw (2).....
			239266	7201-10	Lateral Rock Shaft Driven Arm....
				7201-21	Lateral Rock Shaft Driven Arm Driving Link.....

350820  
New #

No.	Plate	Description	No.	Plate	Description
141075(803)	7201-10	Lateral Rock Shaft Driven Arm	1655(803)	7201-11	Longitudinal Rock Shaft Cam Follower Roller Screw Stud Nut.....
	7201-21	Driving Link Screw.....	37310	7201-11	Longitudinal Rock Shaft Cam Follower Roller Screw Stud Nut Washer.....
1519(805)	7201-10	Lateral Rock Shaft Driven Arm			
	7201-21	Driving Link Screw Nut.....			
239267	7201-11	Lateral Rock Shaft Driven Arm Hinge Stud with 202423.....	167416	7201-11	Longitudinal Rock Shaft Collar with two 140321(830)
202423	7201-11	Lateral Rock Shaft Driven Arm Hinge Stud Oil Packing (wick)....	140321(830)	7201-11	Longitudinal Rock Shaft Collar Set Screw (2).....
141076(830)	7201-11	Lateral Rock Shaft Driven Arm Hinge Stud Set Screw.....	239265	7201-11	Longitudinal Rock Shaft Driven Arm
239623	7201-11	Lateral Rock Shaft Driving Arm with 350604(869).....	239267	7201-11	Longitudinal Rock Shaft Driven Arm Hinge Stud with 202423.....
350604(869)	7201-11	Lateral Rock Shaft Driving Arm Clamping Screw.....	202423	7201-11	Longitudinal Rock Shaft Driven Arm Hinge Stud Oil Packing (wick) ....
167335	7201-12	Lateral Rock Shaft Driving Arm Screw Stud.....	141076(830)	7201-11	Longitudinal Rock Shaft Driven Arm Hinge Stud Set Screw.....
239574	7201-11	Lateral Rock Shaft Driving Arm Screw Stud Guide Block.....	239623	7201-11	Longitudinal Rock Shaft Driving Arm with 350604(869).....
350812(869)	7201-12	Lateral Rock Shaft Driving Arm Screw Stud Locking Screw.....	350604(869)	7201-11	Longitudinal Rock Shaft Driving Arm Clamping Screw.....
53626(803)	7201-12	Lateral Rock Shaft Driving Arm Screw Stud Nut.....	167335	7201-12	Longitudinal Rock Shaft Driving Arm Screw Stud.....
167449	7201-12	Lateral Rock Shaft Driving Arm Screw Stud Nut Washer.....	239574	7201-11	Longitudinal Rock Shaft Driving Arm Screw Stud Guide Block.....
167329	7201-12	Longitudinal Adjusting Lever....	350812(869)	7201-12	Longitudinal Rock Shaft Driving Arm Screw Stud Locking Screw.....
239536	7201-12	Longitudinal Adjusting Lever Handle.....	53626(803)	7201-12	Longitudinal Rock Shaft Driving Arm Screw Stud Nut.....
141545(803)	7201-12	Longitudinal Adjusting Lever Handle Hinge Screw.....	167449	7201-12	Longitudinal Rock Shaft Driving Arm Screw Stud Nut Washer.....
167459	7201-12	Longitudinal Adjusting Lever Handle Hinge Screw Friction Washer.....	136618	7201-3	Looper.....
1620(805)	7201-12	Longitudinal Adjusting Lever Handle Hinge Screw Nut.....	50150(830)	7201-3	Looper Set Screw.....
202622	7201-12	Longitudinal Adjusting Lever Handle Hinge Screw Nut Washer....	136831	7201-3	Looper Shaft with 50150(830).....
202622	7201-12	Longitudinal Adjusting Lever Handle Spacing Washer.....	59707	7201-3	Looper Shaft Bevel Gear with two... 1253(830).....
141550(803)	7201-12	Longitudinal Adjusting Lever Hinge Screw.....	1253(830)	7201-3	Looper Shaft Bevel Gear Set Screw . (2).....
167459	7201-12	Longitudinal Adjusting Lever Hinge Screw Friction Washer.....	124764	7201-3	Looper Shaft Bushing (front).....
1654(803)	7201-12	Longitudinal Adjusting Lever Hinge Screw Nut.....	440(830)	7201-3	Looper Shaft Bushing (front) Set Screw.....
239384	7201-11	Longitudinal Rock Shaft (driving)	136807	7201-3	Looper Shaft Bushing (rear).....
239144	7201-11	Longitudinal Rock Shaft (driving) 239384 with 51951.....	440(830)	7201-3	Looper Shaft Bushing (rear) Set Screw.....
51951	7201-11	Longitudinal Rock Shaft Cam Follower Roller and Stud. Nos. 1655(803), 5968 and 37310.....	239317	7201-15	Machine Pulley (loose).....
5968	7201-11	Longitudinal Rock Shaft Cam Follower Roller Washer.....	239318	7201-15	Machine Pulley (loose) 239317 with 239322.....
			239379	7201-15	Machine Pulley (loose) Engaging Arm with 239320, 239321 and 350600(869)
			350600(869)	7201-15	Machine Pulley (loose) Engaging Arm Clamping Screw.....
			167084	7201-15	Machine Pulley (loose) Engaging Arm Stud.....

No.	Plate	Description	No.	Plate	Description
1513(819)	7201-15	Machine Pulley (loose) Engaging Arm Stud Lock Nut.....	160(805)	7201-6	Needle Bar Take-up Clamping Screw..
239320	7201-15	Machine Pulley (loose) Engaging Arm Wear Block.....	136847	7201-6	Needle Bar Take-up complete, Nos. 1492(819), 136848, 175100 and 175101.....
239321	7201-15	Machine Pulley (loose) Engaging Arm Wear Block Pin.....	175100	7201-6	Needle Bar Take-up Thread Guide Plate.....
239322	7201-15	Machine Pulley (loose) Needle Bearing.....	175101	7201-6	Needle Bar Take-up Thread Guide Plate Roller.....
239315	7201-3	Machine Pulley (loose) Retaining Ring.....	1492(819)	7201-6	Needle Bar Take-up Thread Guide Plate Screw.....
239524	7201-15	Machine Pulley (loose) Starting Cap.....	239376	7201-6	Needle Bar Thread Guide.....
239525	7201-15	Machine Pulley (loose) Starting Cap Needle Button.....	50169(819)	7201-6	Needle Bar Thread Guide Screw.....
239526	7201-15	Machine Pulley (loose) Starting Cap Needle Thrust Bearing.....	136842	7201-3	Needle Guide complete with Thread Finger, Nos. 136889, 175131 and two 218(804).....
239382	7201-15	Machine Pulley (loose) Starting Cap Needle Plate.....	136622	7201-3	Needle Guide Cam with two 195(803).
239486-001	7201-15	Machine Pulley (tight).....	195(803)	7201-3	Needle Guide Cam Set Screw (2)....
239314	7201-3	Machine Pulley (tight) Key.....	136909	7201-3	Needle Guide Oscillating Crank with 1057(830) and 51933.....
239374	7201-3	Machine Pulley (tight) Needle Thrust Bearing.....	1057(830)	7201-3	Needle Guide Oscillating Crank Clamping Screw.....
239383	7201-3	Machine Pulley (tight) Needle Thrust Bearing Washer (2).....	51933	7201-3	Needle Guide Oscillating Crank Roller and Stud.....
239315	7201-3	Machine Pulley (tight) Retaining Ring.....	175131	7201-3	Needle Guide Pin.....
167086	7201-6	Needle Bar.....	136808	7201-3	Needle Guide Shaft Bushing.....
167087	7201-6	Needle Bar 167086 with 209(833), 50169(819) and 239376.....	440(830)	7201-3	Needle Guide Shaft Bushing Set Screw.....
239273	7201-6	Needle Bar Bushing (lower).....	136889	7201-3	Needle Guide Thread Finger.....
136795	7201-6	Needle Bar Bushing (upper).....	218(804)	7201-3	Needle Guide Thread Finger Screw (2).....
271597	7201-6	Needle Bar Connecting Link.....	209(833)	7201-6	Needle Set Screw.....
167088	7201-6	Needle Bar Connecting Link 271597 with 50650(803), 167089-001 and 239385.....	136809	--	Pair of Gears, for upper Shaft, Nos. 59708 and 136792.....
50650(803)	7201-6	Needle Bar Connecting Link Cap Screw.....	167143	7201-9	Starting Bell Crank.....
239385	7201-6	Needle Bar Connecting Link Crank...	167144	7201-9	Starting Bell Crank 167143 with 51657(803), 53617(805), 167154 and 167155.....
350812(869)	7201-3	Needle Bar Connecting Link Crank Set Screw (2).....	141450(803)	7201-9	Starting Bell Crank Hinge Screw....
167089-001	7201-6	Needle Bar Connecting Stud with 175(830) and 239277.....	1662(805)	7201-9	Starting Bell Crank Hinge Screw Nut
175(830)	7201-6	Needle Bar Connecting Stud Clamping Screw.....	167415	7201-9	Starting Bell Crank Hinge Screw 141450(803) with 1662(805).....
239277	7201-6	Needle Bar Connecting Stud Oil Packing (wick).....	239294	7201-9	Starting Bell Crank Pawl.....
23477	7201-3	Needle Bar Crank with 858(830), 1065(830) and two 350812(869).....	141449(803)	7201-9	Starting Bell Crank Pawl Hinge Screw.....
203172	7201-3	Needle Bar Crank Friction Washer...	1662(805)	7201-9	Starting Bell Crank Pawl Hinge Screw Nut.....
1065(830)	7201-3	Needle Bar Crank Position Screw....	167414	7201-9	Starting Bell Crank Pawl Hinge Screw 141449(803) with 1662(805)...
858(830)	7201-3	Needle Bar Crank Set Screw.....	239295	7201-9	Starting Bell Crank Pawl Hinge Screw Return Spring.....
136848	7201-6	Needle Bar Take-up with 160(805)...	167145	7201-14	Starting Lever with 141077(830)....
			167146	7201-14	Starting Lever 167145 with 239159, 239307 and two each 141099(805) and 214053.....

No.	Plate	Description
167458	7201-14	Starting Lever with Starting Lever Stop Cam Interlocking Arm Stop Rod Complete, Nos. 167145, 167157, 167160, 167445, 202342, 239159, 239307, 239518, 239519, two each 1518(805) 141099(805), 214053, three 131022 and four 2807.....
136903	7201-16	Starting Lever Arm (operated) with 350600(869).....
140427(830)	7201-16	Starting Lever Arm and Rock Shaft Stop Screw.....
1664(803)	7201-16	Starting Lever Arm and Rock Shaft Stop Screw Lock Nut.....
239299	7201-9	Starting Lever Arm Lifting Rod.....
167148	7201-16	Starting Lever Arm (operated) Key..
350600(869)	7201-16	Starting Lever Arm (operated) Key Clamping Screw.....
239301	7201-14	Starting Lever Bushing.....
136902	7201-16	Starting Lever Arm and Rock Shaft with 170(850), 1664(803) and 140427(830).....
141077(830)	7201-14	Starting Lever Bushing Set Screw...
239487	7201-4	Starting Lever Lifting Rod.....
239303	7201-4	Starting Lever Lifting Rod Operating Lever Arm.....
201356(805)	7201-4	Starting Lever Lifting Rod Operating Lever Arm Screw Stud.....
214053	7201-14	Starting Lever Return Spring (2) ..
170(805)	7201-16	Starting Lever Return Spring Screw Stud (lower).....
141099(805)	7201-14	Starting Lever Return Spring Screw Stud (upper) (2).....
167154	7201-9	Starting Lever Starting Rod.....
167155	7201-9	Starting Lever Starting Rod Adjuster.....
141100(850)	7201-16	Starting Lever Starting Rod Adjuster Hinge Screw.....
51657(803)	7201-9	Starting Lever Starting Rod Lock Nut.....
53617(805)	7201-9	Starting Lever Starting Rod Swivel Stud Lock Nut.....
239159	7201-14	Starting Lever Stop Cam Interlocking Arm.....
239307	7201-14	Starting Lever Stop Cam Interlocking Arm Retaining Ring.....
167445	7201-14	Starting Lever Stop Cam Interlocking Arm Stop Rod.....
167447	7201-14	Starting Lever Stop Cam Interlocking Arm Stop Rod complete, Nos. 167157, 167445, 202342, 239518, 239519, two 1518(805) three 131022 and four 2807.....

No.	Plate	Description
131022	7201-14	Starting Lever Stop Cam Interlocking Arm Stop Rod Bumper (rubber) (3).....
2807	7201-14	Starting Lever Stop Cam Interlocking Arm Stop Rod Bumper Separating Washer (4).....
239518	7201-14	Starting Lever Stop Cam Interlocking Arm Stop Rod Hinge Pin.....
239519	7201-14	Starting Lever Stop Cam Interlocking Arm Stop Rod Hinge Pin Retainer.....
202342	7201-14	Starting Lever Stop Cam Interlocking Arm Stop Rod Hinge Pin Tension Spring.....
1518(805)	7201-14	Starting Lever Stop Cam Interlocking Arm Stop Rod Nut (2).....
167157	7201-14	Starting Lever Stop Cam Interlocking Arm Stop Rod Swivel.....
167160	7201-14	Starting Lever Stop Cam Interlocking Arm Stop Rod Swivel Retaining Ring.....
167446	7201-14	Starting Lever Stop Cam Interlocking Arm Stop Rod complete, Nos. 167445, 202342, 239518 and 239519..
239554	7201-16	Stop Motion Brake Shoe (leather)...
239555	7201-16	Stop Motion Brake Shoe Rivet (2)...
239556	7201-16	Stop Motion Brake Shoe Support.....
239557	7201-16	Stop Motion Brake Shoe Support complete, Nos. 239554, 239556 and two 239555.....
167159	7201-16	Stop Motion Brake Shoe Support Bracket with 171(830) and 201(804)
167161	7201-16	Stop Motion Brake Shoe Support Bracket 167159 with 50446(803), 141101(803), 223812, 239513 and 239557.....
167229	7201-16	Stop Motion Brake Shoe Support Bracket Pressure Spring.....
141101(803)	7201-16	Stop Motion Brake Shoe Support Bracket Pressure Spring Adjusting Screw.....
171(830)	7201-16	Stop Motion Brake Shoe Support Bracket Pressure Spring Adjusting Screw Clamping Screw.....
239512	7201-16	Stop Motion Brake Shoe Support Bracket Pressure Spring Sleeve....
239513	7201-16	Stop Motion Brake Shoe Support Bracket Stud (eccentric).....
201(804)	7201-16	Stop Motion Brake Shoe Support Bracket Stud Screw.....
50446(803)	7201-16	Stop Motion Brake Shoe Support Hinge Screw.....
223812	7201-16	Stop Motion Brake Shoe Support Spring.....



No.	Plate	Description
239549	7201-16	Stop Motion Brake Complete, Nos. 141100(850), 167161, 167229 and 239512.....
2102	7201-13	Tension Disc (2).....
1560(803)	7201-13	Tension Regulating Thumb Nut.....
1110(803)	7201-13	Tension Screw Stud.....
20972	7201-13	Tension Screw Stud 1110(803) with 1560(803).....
156376	7201-13	Tension Spring.....
156316	7201-13	Tension Thread Guide.....
136810	7201-6	Thread Nipper (back) Adapter Block with 1454(830).....
1454(830)	7201-6	Thread Nipper (back) Adapter Block Screw (2).....
1743(809)	7201-6	Thread Nipper (back) Adjusting Thumb Nut.....
136849	7201-6	Thread Nipper (back) Body.....
1454(830)	7201-6	Thread Nipper (back) Body Set Screw.....
136811	7201-3	Thread Nipper (back) Cam with two 50150(830).....
167017	7201-3	Thread Nipper (back) Cam Access Hole Cover.....
50150(830)	7201-3	Thread Nipper (back) Cam Set Screw (2).....
2921	7201-6	Thread Nipper (back) Disc (2).....
12162	7201-6	Thread Nipper (back) Disc Guide Pin.....
136701	7201-6	Thread Nipper (back) Eyelet.....
1654(809)	7201-6	Thread Nipper (back) Lock Nut.....
59776	7201-6	Thread Nipper (back) Stud with 13538.....
13538	7201-6	Thread Nipper (back) Stud Position Pin.....
13539	7201-6	Thread Nipper (back) Stud Roller..
13540	7201-6	Thread Nipper (back) Stud Roller Pin.....
2026	7201-6	Thread Nipper (back) Stud Spring..
59777	7201-6	Thread Nipper (back) Stud complete, Nos. 13539, 13540 and 59776
136850	7201-6	Thread Nipper (back) complete, Nos. 1654(809), 1743(809), 2026, 12162, 59777, 136701, 136810, and 136849, and two 2921.....
136864	7201-13	Thread Nipper (front) and Thread Pull-off complete, Nos. 176(819), 846(803), 1282(803), 1454(830), 1747(809), 20972, 50087(830), 136677, 136778, 136791, 136796, 136799, 136800, 136803, 136804, 136805, 136812, 136842, 136870, 136871, 136872, 140431(803), 156316, 156376, 175032, 175179, 175182 and two 2102.....

No.	Plate	Description
136870	7201-13	Thread Nipper (front) Lever.....
136871	7201-13	Thread Nipper (front) Lever Block..
136872	7201-13	Thread Nipper (front) Lever Block Pivot Pin.....
846(803)	7201-13	Thread Nipper (front) Lever Hinge Screw (left).....
50087(830)	7201-13	Thread Nipper (front) Lever Hinge Screw (right).....
136852	7201-13	Thread Nipper (front) Lever Rod....
136799	7201-13	Thread Nipper (front) Lever Rod Cam (driven) with 202(805).....
202(805)	7201-13	Thread Nipper (front) Lever Rod Cam (driven) Set Screw.....
136803	7201-13	Thread Nipper (front) Lever Rod Cam (driving) with 237(830).....
176(819)	7201-13	Thread Nipper (front) Lever Rod Cam (driving) Screw.....
175179	7201-13	Thread Nipper (front) Lever Rod Spring.....
175182	7201-13	Thread Nipper (front) Lever Rod Spring Collar with 465(830).....
465(830)	7201-13	Thread Nipper (front) Lever Rod Spring Collar Set Screw.....
175032	7201-13	Thread Nipper (front) Lever Rod Spring Washer.....
136778	7201-13	Thread Nipper (front) Thread Guide..
140431(803)	7201-13	Thread Nipper (front) Thread Guide Screw.....
1747(809)	7201-13	Thread Nipper (front) Thread Guide Screw Nut.....
136780	7201-13	Thread Pull-off (front).....
237(830)	7201-13	Thread Pull-off (front) Set Screw...
136677	7201-13	Thread Pull-off (rear).....
624(830)	7201-13	Thread Pull-off (rear) Set Screw....
136804	7201-13	Thread Pull-off Bell Crank with 624(830).....
136800	7201-13	Thread Pull-off Bell Crank Bracket..
140220(819)	7201-13	Thread Pull-off Bell Crank Bracket Mounting Screw.....
136813	7201-13	Thread Pull-off Bell Crank Bracket Mounting Screw Spacer.....
136839	7201-13	Thread Pull-off Bell Crank Bracket Stabilizing Pin.....
136812	7201-13	Thread Pull-off Bell Crank Connection.....
194(803)	7201-4	Thread Pull-off Bell Crank Connection Screw (lower).....
1282(803)	7201-13	Thread Pull-off Bell Crank Connection Screw (upper).....
136805	7201-13	Thread Pull-off Bell Crank Extension.....
1454(830)	7201-13	Thread Pull-off Bell Crank Extension Screw.....

No.	Plate	Description	No.	Plate	Description
136796	7201-13	Thread Pull-off Bell Crank Hinge Stud.....	460(830)	7201-9	Tripping Rock Shaft Collar Set Screw (2).....
136859	7201-4	Thread Pull-off Driving Lever with 208(830) and two 140321(830) (NOTE: Screw 208(830) has no application for this machine.)....	239341	7201-9	Tripping Rock Shaft Connection with 350606(869).....
140321(830)	7201-4	Thread Pull-off Driving Lever Set Screw (2).....	350606(869)	7201-9	Tripping Rock Shaft Connection Pinch Screw.....
167168	7201-6	Thread Retainer (back).....	239342	7201-9	Tripping Rock Shaft Connection Rod
853(830)	7201-6	Thread Retainer (back) Set Screw..	239343	7201-9	Tripping Rock Shaft Lever Arm.....
167292	7201-19	Thread Unwinder Mounting Bracket with 462(830) (NOTE: Screw 462(830) has no application for this machine.).....	51119(805)	7201-9	Tripping Rock Shaft Lever Arm Screw.....
136911	7201-8	Thread Separator.....	136797	7201-9	Tripping Rock Shaft Spacer.....
1034(805)	7201-8	Thread Separator Screw.....	239344	7201-9	Tripping Rock Shaft Support.....
136912	7201-8	Thread Separator Screw Washer.....	141093(830)	7201-9	Tripping Rock Shaft Support Screw.
641(850)	7201-19	Thread Unwinder Mounting Bracket Set Screw.....	239345	7201-17	Vertical Drive Shaft.....
239387	7201-4	Thread Wiper Body.....	239346	7201-17	Vertical Drive Shaft Bushing (lower).....
39453	7201-4	Thread Wiper Body Finger.....	239346	7201-17	Vertical Drive Shaft Bushing (upper).....
330(809)	7201-4	Thread Wiper Body Finger Screw....	167044	7201-3	Vertical Drive Shaft Worm with 141407(869) and 141408(869).....
141084(803)	7201-4	Thread Wiper Body Hinge Screw.....	167073	7201-17	Vertical Drive Shaft Worm Gear with 141407(869) and 141408(869)..
167174	7201-4	Thread Wiper Body Support.....	141407(869)	7201-17	Vertical Drive Shaft Worm Gear Position Screw.....
167038	7201-4	Thread Wiper Body Support 167174 with 141084(803), 141574(803), 167354, 239336 and 239387.....	141408(869)	7201-17	Vertical Drive Shaft Worm Gear Set Screw.....
141406(830)	7201-4	Thread Wiper Body Support Set Screw.....	141407(869)	7201-3	Vertical Drive Shaft Worm Position Screw.....
167354	7201-4	Thread Wiper Body Wire (adjustable).....	141408(869)	7201-3	Vertical Drive Shaft Worm Set Screw.....
239336	7201-4	Thread Wiper Body Wire Clamping Plate.....			
141574(803)	7201-4	Thread Wiper Body Wire Clamping Plate Screw.....			
136891	7201-4	Thread Wiper complete, Nos. 330(809), 39453, 136890, 141084(803), 141574(803), 167174, 167354, 239336 and 239387.....			
136886	7201-8	Throat Plate.....			
136910	7201-8	Throat Plate complete, Nos. 1547(803), 50018(806), 59739, 136823, 136886, 136907, 136908, 136911, 136912, and two 1034(805)..			
51369(805)	7201-8	Throat Plate Screw (4).....			
167181	7201-9	Tripping Rock Shaft.....			
136855	7201-8	Tripping Rock Shaft Bracket.....			
1177(803)	7201-8	Tripping Rock Shaft Bracket Screw (2).....			
167182	7201-9	Tripping Rock Shaft Collar with two 460(830).....			

**LIST OF PARTS  
FOR  
MACHINE NO. 421W301BA**

For tacking paper tickets on clothing, spot tacking, and tacking trouser cuffs. Machine produces a tack up to 3/16" (4.763 mm) in length consisting of 7 stitches.

**NOTE: Parts for this machine are the same as Machine 421W307BA, with the following exceptions:**

No.	Plate	Description
239223-452	7201-1	Arm Cover (side) in place of 239223-451.....
32803	7201-20	Clamp complete, Nos. 202(819), 1182(819), 1656(819), 124646, 136873 and 167322 in place of 167325.....
202(819)	7201-20	Clamp Arm Hook Screw (left).....
1182(819)	7201-20	Clamp Arm Hook Screw (right).....
1656(819)	7201-20	Clamp Screw Stud Nut.....
124646	7201-20	Clamp with 1220(805) and 17928.....
136873	7201-20	Clamp Arm with 17714.....
167322	7201-20	Clamp Arm Hook with 63825 (NOTE: 63825 has no application for this machine.).....
1220(805)	7201-20	Clamp Screw Stud.....
17928	7201-20	Clamp Position Stud.....
17712	7201-20	Clamp Pressure Spring in place of 39241.....
1178(819)	7201-20	Clamp Pressure Spring Screw in place of 141211(869).....
39335	7201-20	Clamp Pressure Spring Screw Plate in place of 136827.....
167426	-----	Clamp complete 32803 with 1176(819), 1177(819), 1178(819), 17710, 17712, 39335, 136875 and 239572.....
239234	7201-20	Cylinder Cover (side) in place of 239533.....
167041	7201-20	Cylinder Cover (top) in place of 136899.....

No.	Plate	Description
136876	-----	Feed Cam with four 167234 and eight each 140352(830) and 167235 in place of 136863.....
167234	7201-18	Feed Cam Tripping Point (4).....
140352(830)	7201-18	Feed Cam Tripping Point Screw (8).
167235	7201-18	Feed Cam Tripping Point Screw Washer (8).....
136874	7201-20	Feed Plate in place of 136893.....
136875	-----	Feed Plate Carrier Bar 167029 with 136874, 141071(819), 167041 and 167055 in place of 136904.....
167029	7201-7	Feed Plate Carrier Bar.....
141071(819)	7201-7	Feed Plate Carrier Bar Driving Block Screw.....
167055	7201-7	Feed Plate Carrier Bar Driving Block complete, Nos. 167054 and 167056.....
167076	7201-21	Lateral Pivot Driving Arm 167075 with 1519(805), 141075(803) and 239266 in place of 136830.....
167075	7201-21	Lateral Pivot Driving Arm with 350600(869) in place of 136829.....
350600(869)	7201-21	Lateral Pivot Driving Arm Clamping Screw.....
239266	7201-21	Lateral Rock Shaft Driven Arm Driving Link.....
239268	7201-11	Lateral Rock Shaft Driving Arm with 350604(869) in place of 239623.....
167048	7201-20	Lateral Rock Shaft Driving Arm Screw Stud in place of 167335.....
210805	7201-20	Lateral Rock Shaft Driving Arm Screw Stud Nut Washer in place of 167449.....
53612(805)	7201-20	Lateral Rock Shaft Driving Arm Screw Stud Nut in place of 53626(803).....
167048	7201-20	Longitudinal Rock Shaft Driving Arm Screw Stud in place of 167335.
210805	7201-20	Longitudinal Rock Shaft Driving Arm Screw Stud Nut Washer in place of 167449.....
53612(805)	7201-20	Longitudinal Rock Shaft Driving Arm Screw Stud Nut in place of 53626(803).....
239268	7201-11	Longitudinal Rock Shaft Driving Arm with 350604(869) in place of 239623.....
167077	7201-19	Vertical Drive Shaft Worm with 141407(869) and 141408(869) in place of 167044.....

No.	Plate	Description
167079	7201-19	Vertical Drive Shaft Worm Gear with 141407(869) and 141408(869) in place of 167073.....

PARTS REMOVED

167330	7201-12	Adjusting Device complete.....
650(803)	7201-7	Button Clamp Guiding Screw (2 hole buttons).....
136802	7201-7	Button Clamp Guiding Screw (2 hole buttons) Drag Spring.....
136898	7201-7	Button Clamp Guiding Screw (2 hole buttons) Guide Block.....
792(819)	7201-7	Button Clamp Guiding Screw (2 hole buttons) Guide Block Fastening Screw (2).....
136827	7201-7	Button Clamp Guiding Screw (2 hole buttons) Holder.....
136828	7201-7	Button Clamp Guiding Screw (2 hole buttons) Stop.....
136826	7201-10	Lateral Feed Throw-out Collar.....
350800(869)	7201-10	Lateral Feed Throw-out Collar Positioning Screw (3).....
149797	7201-10	Lateral Feed Throw-out Collar Retaining Ring.....
350802(830)	7201-10	Lateral Feed Throw-out Screw.....
214529	7201-10	Lateral Feed Throw-out Screw Drag Spring.....
350812(869)	7201-12	Lateral Rock Shaft Driving Arm Screw Stud Locking Screw.....
350812(869)	7201-12	Longitudinal Rock Shaft Driving Arm Screw Stud Locking Screw.....

LIST OF PARTS  
FOR  
MACHINE NO. 421W303BA

For sewing two- or four-hole flat buttons (size 13 ligne through 50 ligne) and snap fasteners (size 0 through 000) with 14 stitches. The work clamp moves alternately back and forth lengthwise of the cylinder.

**NOTE: Parts for this machine are the same as Machine 421W307BA, with the following exceptions:**

No.	Plate	Description
239223-453	7201-1	Arm Cover (side) in place of 239223-451.....
136877	-----	Feed Cam with two 167234 and four each 140352(830) and 167235 in place of 136863.....
167077	7201-19	Vertical Drive Shaft Worm with 141407(869) and 141408(869) in place of 167044.....
167079	7201-19	Vertical Drive Shaft Worm Gear with 141407(869) and 141408(869) in place of 167073.....

**LIST OF PARTS  
FOR  
MACHINE NO. 421W311BA**

For sewing two- or four-hole flat buttons (size 13 ligne through 50 ligne) and snap fasteners (size 0 through 000) with 16 stitches. The work clamp moves alternately across the cylinder.

**NOTE: Parts for this machine are the same as Machine 421W307BA, with the following exceptions:**

No.	Plate	Description
239223-454	7201-1	Arm Cover (side) in place of 239223-451.....
136913	7201-21	Button Clamp Guiding Screw (2 hole buttons) Guide Block in place of 136898.....
1485(833)	7201-21	Button Clamp Guiding Screw (2 hole buttons) Guide Block Fastening Screw (2) in place of 792(819)....
136897	-----	Feed Cam with two 167234 and four each 140352(830) and 167235 in place of 136863.....
167075	7201-21	Lateral Pivot Driving Arm with 350600(869) in place of 136829....
167076	7201-21	Lateral Pivot Driving Arm 167075 with 1519(805), 141075(803) and 239266 in place of 136830.....
350600(869)	7201-21	Lateral Pivot Driving Arm Clamping Screw.....
350802(830)	7201-21	Longitudinal Feed Throw-out Screw.
214529	7201-21	Longitudinal Feed Throw-out Screw Drag Spring.....
136879	7201-21	Longitudinal Rock Shaft (driving) in place of 239384.....
136880	-----	Longitudinal Rock Shaft (driving) 136879 with 51951 in place of 239144.....

No.	Plate	Description
136881	7201-21	Longitudinal Rock Shaft (driven)..
136882	7201-21	Longitudinal Rock Shaft (driven) Coupling with 140409(869).....
140409(869)	7201-21	Longitudinal Rock Shaft (driven) Coupling Set Screw.....

**PARTS REMOVED**

136826	7201-10	Lateral Feed Throw-out Collar.....
350800(869)	7201-10	Lateral Feed Throw-out Collar Positioning Screw (3).....
149797	7201-10	Lateral Feed Throw-out Collar Retaining Ring.....
350802(830)	7201-10	Lateral Feed Throw-out Screw.....
214529	7201-10	Lateral Feed Throw-out Screw Drag Spring.....
167416	7201-11	Longitudinal Rock Shaft Collar with two 140321(830).....
140321(830)	7201-11	Longitudinal Rock Shaft Collar Set Screw (2).....

**ACCESSORIES**  
for  
**Machines 421W301BA, 421W303BA**  
**421W307BA and 421W311BA**

No.	Plate	Description
120342	7201-29	Oiler with 120343.....
120343	7201-29	Oiler Spout (3-1/2 in. long).....
167448	7201-26	Machine Base Oil Drain Jar (plastic).....
228444	7201-26	Machine Cushion (4).....
12361-001	7201-23	Machine Hinge Connection (2).....
228786	7201-26	Machine Support (left).....
228865	7201-26	Machine Support (left) 228786 with two wood screws 1-1/4 in. No. 12 F.H.....
228809	7201-26	Machine Support (right) with two wood screws 1-1/4 in. No. 12 F.H... Machine Tilting Latch Lever com- plete.....
228788	7201-26	Machine Tilting Latch Lever com- plete.....
200246(803)	7201-26	Machine Tilting Latch Lever Screw..
228789	7201-26	Machine Tilting Latch Lever Spring.
239350	7201-29	Pliers.....
225498	7201-29	Screwdriver.....
228476	7201-29	Screwdriver.....
23308	7201-29	Screwdriver (8 in. blade).....
149426	7201-22	Starting Lever Return Spring (not for 421W301 Machine).....
239371	7201-29	Wrench.....
23535	7201-29	Wrench.....
225554	7201-29	Wrench.....
239353	7201-29	Wrench.....
255540	7201-29	Wrench.....
10875	7201-29	Wrench.....
17905	7201-29	Wrench.....
167260	7201-29	Wrench.....
154308	7201-22	Set of Gauges for Centralizing Feed Mechanism, Nos. 154306, 154307 and 154354 (furnished upon request only)
154305	7201-22	Gauge Pin.....
154354	7201-22	Gauge Pin 154305 with 154355.....
154306	7201-22	Gauge Pin Extension.....
154307	7201-22	Gauge Pin Setting Cam.....
154355	7201-22	Gauge Pin Spring Plunger.....
239394	-----	Work Plate complete (furnished upon request only).....

**Belt Guard**

No.	Plate	Description
167187	7201-23	Belt Guard with 141093(830).....
239355	7201-23	Belt Guard Base.....
239444-001	7201-23	Belt Guard Base 239355 with wood screws 1-1/4 in. No. 12 R.H.....
239356	7201-23	Belt Guard Hinge Pin.....
141093(830)	7201-23	Belt Guard Hinge Pin Set Screw....
239357	7201-23	Belt Guard Lock Spring.....
167188	7201-23	Belt Guard Lock Spring Plate.....
141103(850)	7201-23	Belt Guard Lock Spring Plate Screw (2).....
167189	7201-23	Belt Guard complete, Nos. 167187, 167188, 239356, 239357 and two 141103(850).....

**Drip Pan**

No.	Plate	Description
228785	7201-26	Drip Pan.....
2001308(805)	7201-26	Drip Pan Screw (4).....
203637	7201-26	Drip Pan Screw Washer (4).....
52843	7201-26	Drip Pan Screw Washer (leather) (4).....

**Eye Guard**

No.	Plate	Description
259830	7201-22	Eye Guard Deflector.....
259831	7201-22	Eye Guard Bracket.....
200273(819)	7201-22	Eye Guard Bracket Hinge Screw.....
200184(819)	7201-22	Eye Guard Bracket Screw (2).....
226467	7201-22	Eye Guard Bracket Spring Washer...
259832	7201-22	Eye Guard complete, Nos. 200273(819), 226467, 259830, 259831 and two 200184(819).....

## Driving Accessories for Head-on Installation

No.	Plate	Description
151223	7201-27	Belt Tightener complete, Nos. 51655(819), 150783, 151066, 151219, 151220, 151221, 151222, two each 9281, 151068, four each 50807(819), 151369 and eight each 1778(819), 9842 and 126150.....
150701	7201-27	Belt Tightener Hinge Plate Adjusting Screw.....
150783	7201-27	Belt Tightener Hinge Plate Adjusting Screw 150701 with 51655(819)...
151220	7201-27	Belt Tightener Hinge Plate Adjusting Screw Hinge Bracket.....
151066	7201-27	Belt Tightener Hinge Plate Adjusting Screw Hinge Pin.....
151068	7201-27	Belt Tightener Hinge Plate Adjusting Screw Hinge Pin Retaining Ring (2).....
51655(819)	7201-27	Belt Tightener Hinge Plate Adjusting Screw Nut (2).....
9281	7201-27	Belt Tightener Hinge Plate Adjusting Screw Nut Washer (2).....
151219	7201-27	Belt Tightener Motor Plate.....
151221	7201-27	Belt Tightener Motor Plate Hinge Bracket.....
151222	7201-27	Belt Tightener Motor Plate Hinge Bracket Pin.....
50807(819)	7201-27	Motor Bolt (4).....
1778(819)	7201-27	Motor Bolt Nut (4).....
126150	7201-27	Motor Bolt Nut Lock Washer (4).....
9842	7201-27	Motor Bolt Washer.....
151369	7201-27	Table Screw Stud (4).....
1778(819)	7201-27	Table Screw Stud Nut (4).....
126150	7201-27	Table Screw Stud Nut Lock Washer (4).....
9842	7201-27	Table Screw Stud Washer (4).....
228822	7201-25	Treadle complete, Nos. 2718(819), 14372, 14373, 14375, 22666, 50581(819) and two each 13288, 23180, 51074(819) and 67425 (2)....
14372	7201-25	Treadle (2).....
14373	7201-25	Treadle Extension (2).....
50581(819)	7201-25	Treadle Extension Screw (2).....
2718(819)	7201-25	Treadle Extension Screw Washer (2).....
22666	7201-25	Treadle Shaft (2).....
13288	7201-25	Treadle Shaft Retaining Ring (4)....
14375	7201-25	Treadle Stand (2).....
51074(819)	7201-25	Treadle Stand Bolt (4).....

No.	Plate	Description
67425	7201-25	Treadle Stand Bolt Lock Washer (4).
23180	7201-25	Treadle Stand Bolt Washer.....
150750	-----	Machine Driving Belt 50 inch outside length for "V" Drive Machine Pulleys.....

## OPERATING EQUIPMENT

228807	7201-24	Operating Equipment complete, Nos. two each 2770, 32134, 167416, 228802, 228811, 228861 and four each 228805 and 228806.....
167226-001	7201-24	Operating Equipment Cable (long) (2).....
228861	7201-24	Operating Equipment Cable (adjustable) complete, Nos. 1521(819), 151633, 167226-001 and 228858 (2).
1521(819)	7201-24	Operating Equipment Cable Lock Nut (2).....
228858	7201-24	Operating Equipment Cable Yoke End (2).....
151633	7201-24	Operating Equipment Cable Yoke End Pin (2).....
228910	7201-24	Operating Equipment Chain (24 in. long) (2).....
228802	7201-24	Operating Equipment Chain with two 202784 (2).....
202784	7201-24	Operating Equipment Chain Hook (4)
228811	7201-24	Operating Equipment Rock Shaft (2)
167416	7201-24	Operating Equipment Rock Shaft Collar with two 140321(830) (2)....
140321(830)	7201-24	Operating Equipment Rock Shaft Collar Set Screw (4).....
228805	7201-24	Operating Equipment Rock Shaft Lever Arm (4).....
228806	7201-24	Operating Equipment Rock Shaft Lever Arm Bracket with two 356(803) (4).....
356(803)	7201-24	Operating Equipment Rock Shaft Lever Arm Bracket Set Screw (8)....
32134	7201-24	Operating Equipment Rock Shaft Spring (2).....
2270	7201-24	Operating Equipment Rock Shaft Stop Dog with 140219(803) (2).....
140219(803)	7201-24	Operating Equipment Rock Shaft Stop Dog Set Screw (2).....

## THREAD UNWINDER

No.	Plate	Description
167261	7201-28	Thread Unwinder (for one spool) complete, Nos. 150203, 167186, 228764, 228765, 228767, 228768, 228770, 228774 and three wood screws 7/8 in. No. 12 R.H.B.....
228764	7201-28	Thread Unwinder Spool Pin.....
228765	7201-28	Thread Unwinder Spool Rest with 201254(830).....
150203	7201-28	Thread Unwinder Spool Rest Cushion (felt).....
228767	7201-28	Thread Unwinder Spool Rest Rod....
201254(830)	7201-28	Thread Unwinder Spool Rest Set Screw.....
228768	7201-28	Thread Unwinder Spool Stand.....
167186	7201-28	Thread Unwinder Thread Guide.....
228770	7201-28	Thread Unwinder Thread Guide Holder (for one or two guides)....
228774	7201-28	Thread Unwinder Thread Guide Rod..

## NUMERICAL LIST OF PARTS



No.	Plate	Description
99(819)	7201-5	Button Clamp Opening Lever Hinge Screw (For 421W303BA, 421W307BA and 421W311BA).....
160(805)	7201-6	Needle Bar Take-up Clamping Screw.....
170(805)	7201-16	Starting Lever Return Spring Stud (lower).....
171(819)	7201-8	Knife Driving Bar Latch Spring Stud Screw (upper).....
171(830)	7201-16	Stop Motion Brake Shoe Support Bracket Pressure Spring Adjusting Screw Clamping Screw.....
175(830)	7201-6	Needle Bar Connecting Stud Clamping Screw.....
176(819)	7201-4	Clamp Foot Lifter Screw.....
176(819)	7201-13	Thread Nipper (front) Lever Rod Cam (driving) Screw.....
185(809)	7201-2	Arm Cover (front) Thread Retainer Screw (2).....
190(805)	7201-8	Knife Driving Bar Stop (in bracket) Screw (2).....
194(803)	7201-4	Thread Pull-off Bell Crank Connection Screw (lower).....
195(803)	7201-3	Needle Guide Cam Set Screw (2).....
201(804)	7201-16	Stop Motion Brake Shoe Support Bracket Stud Screw.....
202(805)	7201-13	Thread Nipper (front) Lever Rod Cam (driven) Set Screw.....
202(819)	7201-5	Clamp Arm Hook Screw (left).....
207(805)	7201-8	Knife Driver (adjustable) Screw (2).....
209(833)	7201-6	Needle Set Screw.....
218(804)	7201-3	Needle Guide Thread Finger Screw (2).....
230(805)	7201-2	Arm Cover (front) Thread Guide Plate Screw.....
230(819)	7201-5	Button Clamp (left) Spring Screw (For 421W303BA, 421W307BA and 421W311BA).....
230(819)	7201-5	Button Clamp (right) Spring Screw (For 421W303BA, 421W307BA and 421W311BA).....
237(830)	7201-13	Thread Pull-off (front) Set Screw..
330(809)	7201-4	Thread Wiper Body Finger Screw....
356(803)	7201-24	Operating Equipment Rock Shaft Lever Arm Bracket Set Screw (8)....
440(830)	7201-3	Looper Shaft Bushing (front) Set Screw.....
440(830)	7201-3	Looper Shaft Bushing (rear) Set Screw.....
440(830)	7201-3	Needle Guide Shaft Bushing Set Screw.....
460(830)	7201-9	Tripping Rock Shaft Collar Set Screw (2).....

No.	Plate	Description
465(830)	7201-4	Clamp Lifting Rock Shaft Collar (knurled) Set Screw.....
465(830)	7201-13	Thread Nipper (front) Lever Rod Spring Collar Set Screw.....
624(830)	7201-13	Thread Pull-off (rear) Set Screw...
641(850)	7201-19	Thread Unwinder Mounting Bracket Set Screw.....
650(803)	7201-7	Button Clamp Guiding Screw (2 Hole buttons) (For 421W303BA, 421W307BA and 421W311BA).....
691(819)	7201-7	Cylinder Cover Plate (top) Screw (5).....
769(850)	7201-8	Knife Driving Bar Latch Tripping Screw.....
792(819)	7201-2	Arm Cover (front) Screw (2).....
792(819)	7201-7	Button Clamp Guiding Screw (2 hole buttons) Guide Block Fastening Screw (2) (For 421W303BA and 421W307BA).....
846(803)	7201-13	Thread Nipper (front) Lever Hinge Screw (left).....
853(830)	7201-6	Thread Retainer (back) Set Screw...
858(830)	7201-3	Needle Bar Crank Set Screw.....
998(830)	-----	Arm Plug (right) Set Screw.....
1034(805)	7201-8	Knife (thread cutter) Screw.....
1034(805)	7201-8	Thread Separator Screw.....
1057(830)	7201-3	Needle Guide Oscillating Crank Clamping Screw.....
1065(830)	7201-3	Needle Bar Crank Position Screw....
1110(803)	7201-13	Tension Screw Stud.....
1175(850)	7201-7	Button Clamp Hinge Screw (2).....
1176(819)	7201-7	Clamp Arm Hinge Plate Screw.....
1177(803)	7201-8	Tripping Rock Shaft Bracket Screw (2).....
1177(819)	7201-7	Clamp Pressure Spring Bracket Screw.....
1178(819)	7201-20	Clamp Pressure Spring Screw (For 421W301BA).....
1181(819)	7201-5	Button Clamp Spreader Spring Screw Stud (For 421W303BA, 421W307BA and 421W311BA).....
1182(819)	7201-5	Button Clamp Opening Lever Bracket Screw (2) (For 421W303BA, 421W307BA and 421W311BA).....
1182(819)	7201-5	Button Clamp Spreader Lever Adjusting Plate Screw (For 421W303BA, 421W307BA and 421W311BA).....
1182(819)	7201-5	Button Clamp Spreader Lever Stop Screw (For 421W303BA, 421W307BA and 421W311BA).....
1182(819)	7201-5	Clamp Arm Hook Screw (right).....
1182(819)	7201-20	Clamp Arm Hook Screw (right) (For 421W301BA).....

No.	Plate	Description	No.	Plate	Description
1183(819)	7201-5	Button Clamp Stop Screw (For 421W303BA, 421W307BA and 421W311BA).....	1654(809)	7201-6	Thread Nipper (back) Lock Nut.....
1199(819)	7201-5	Button Clamp Spreader Thrust Plate Screw (For 421W303BA, 421W307BA and 421W311BA).....	1655(803)	7201-11	Lateral Rock Shaft Cam Follower
1220(805)	7201-20	Clamp Screw Stud (For 421W301BA)....	1655(803)	7201-21	Roller Screw Stud Nut.....
1226(803)	7201-8	Knife Driving Bar Latch Spring Stud Screw (lower).....	1656(819)	7201-11	Longitudinal Rock Shaft Cam Follower Roller Screw Stud Nut.....
1226(803)	7201-8	Knife Driving Bar Spring Stud Screw (2).....	1662(805)	7201-20	Clamp Screw Stud Nut (For 421W301BA).....
1253(830)	7201-3	Arm Shaft (upright) Bevel Gear (lower) Set Screw (2).....	1662(805)	7201-4	Clamp Lifting Bar Stop Screw Nut...
1253(830)	7201-3	Arm Shaft (upright) Bevel Gear (upper) Set Screw (2).....	1662(805)	7201-9	Starting Bell Crank Hinge Screw Nut.....
1253(830)	7201-3	Looper Shaft Bevel Gear Set Screw (2).....	1662(805)	7201-9	Starting Bell Crank Pawl Hinge Screw Nut.....
1282(803)	7201-13	Thread Pull-off Bell Crank Connection Screw (upper).....	1664(803)	7201-16	Starting Lever Arm and Rock Shaft Stop Screw Lock Nut.....
1289(819)	7201-8	Knife Driving Bar Bumper Screw....	1698(805)	7201-8	Knife Driving Bar Latch Tripping Screw Nut.....
1454(830)	7201-12	Cylinder Cover (side) Screw (2)....	1743(809)	7201-6	Thread Nipper (back) Adjusting Thumb Nut.....
1454(830)	7201-6	Thread Nipper (back) Adapter Block Screw (2).....	1747(809)	7201-13	Thread Nipper (front) Thread Guide Screw Nut.....
1454(830)	7201-6	Thread Nipper (back) Body Set Screw.....	1778(819)	7201-27	Motor Bolt Nut (4).....
1454(830)	7201-13	Thread Pull-off Bell Crank Extension Screw.....	1778(819)	7201-27	Table Screw Stud Nut (4).....
1484(809)	7201-4	Clamp Opening Lever Contact Piece Screw.....	2018	1201-12	Lateral Adjusting Lever Spacing Washer (For 421W303BA, 421W307BA and 421W311BA).....
1485(833)	7201-21	Button Clamp Guiding Screw (2 hole buttons) Guide Block Fastening Screw (2) (For 421W311BA).....	2026	7201-6	Thread Nipper (back) Stud Spring..
1492(819)	7201-6	Needle Bar Take-up Thread Guide Plate Screw.....	2102	7201-13	Tension Disc (2).....
1513(819)	7201-15	Machine Pulley (loose) Encasing Arm Stud Lock Nut.....	2270	7201-24	Operating Equipment Rock Shaft Stop Dog with 140219(803) (2).....
1518(805)	7201-14	Starting Lever Stop Cam Interlocking Arm Stop Rod Nut (2).....	2718(819)	7201-25	Treadle Extension Screw Washer (2)
1519(805)	7201-10	Lateral Rock Shaft Driven Arm Driving Link Screw Nut.....	2807	7201-14	Starting Lever Stop Cam Interlocking Arm Stop Rod Bumper Separating Washer (4).....
1521(819)	7201-24	Operating Equipment Cable Lock Nut (2).....	2921	7201-6	Thread Nipper (back) Disc (2).....
1547(803)	7201-8	Knife Holder Screw Nut.....	5968	7201-11	Lateral Rock Shaft Cam Follower Roller Washer.....
1560(803)	7201-13	Tension Regulating Thumb Nut.....	5968	7201-11	Longitudinal Rock Shaft Cam Follower Roller Washer.....
1620(805)	7201-12	Lateral Adjusting Lever Hinge Screw Nut (For 421W303BA, 421W307BA and 421W311BA).....	7071	7201-8	Knife Driving Bar Bumper Screw Washer.....
1620(805)	7201-12	Longitudinal Adjusting Lever Handle Hinge Screw Nut (For 421W303BA, 421W307BA and 421W311BA).....	9281	7201-27	Belt Tightener Hinge Plate Adjusting Screw Nut Washer (2).....
1654(803)	7201-12	Longitudinal Adjusting Lever Hinge Screw Nut (For 421W303BA, 421W307BA and 421W311BA).....	9842	7201-27	Motor Bolt Washer.....
			9842	7201-27	Table Screw Stud Washer (4).....
			9875	7201-29	Wrench.....
			2162	7201-6	Thread Nipper (back) Disc Guide Pin.....
			2361-001	7201-23	Machine Hinge Connection (2).....
			3288	7201-25	Treadle Shaft Retaining Ring (4)..
			3538	7201-6	Thread Nipper (back) Stud Position Pin.....
			3539	7201-6	Thread Nipper (back) Stud Roller..
			3540	7201-6	Thread Nipper (back) Stud Roller Pin.....

No.	Plate	Description	No.	Plate	Description
			39241	7201-7	Button Clamp Pressure Spring (For 421W303BA, 421W307BA and 421W311BA).....
14372	7201-25	Treadle (2).....			
14373	7201-25	Treadle Extension (2).....			
14375	7201-25	Treadle Stand (2).....	39242	7201-5	Button Clamp Spreader (For 421W303BA, 421W307BA and 421W311BA).....
16532	7201-19	Arm Position Pin (2).....			
16532	7201-19	Cylinder Position Pin (2).....			
17710	7201-7	Clamp Arm Hinge Plate.....	39335	7201-20	Clamp Pressure Spring Screw Plate (For 421W301BA).....
17712	7201-20	Clamp Pressure Spring (For 421W301BA).....	39453	7201-4	Thread Wiper Body Finger.....
17714	7201-5	Clamp Pressure Spring Guide Block.	45329	7201-5	Button Clamp (left) Spring Position Pin (For 421W303BA, 421W307BA and 421W311BA).....
17718	7201-5	Button Clamp Spreader Lever Adjusting Plate Screw Washer (For 421W303BA, 421W307BA and 421W311BA).....	45329	7201-5	Button Clamp (right) Spring Position Pin (For 421W303BA, 421W307BA and 421W311BA).....
17718	7201-5	Button Clamp Spreader Lever Stop Screw Washer (For 421W303BA, 421W307BA and 421W311BA).....	50018(806)	7201-8	Knife Holder Screw.....
17718	7201-4	Clamp Opening Lever Contact Piece Screw Washer.....	50087(830)	7201-13	Thread Nipper (front) Lever Hinge Screw (right).....
17720	7201-5	Button Clamp Spreader Steady Pin (short) (For 421W303BA, 421W307BA and 421W311BA).....	50117(833)	7201-4	Clamp Opening Lever Contact Piece Arm Screw.....
17723	7201-5	Button Clamp (left) Screw Stud (For 421W303BA, 421W307BA and 421W311BA).....	50150(830)	7201-3	Looper Set Screw.....
17723	7201-5	Button Clamp (right) Screw Stud (For 421W303BA, 421W307BA and 421W311BA).....	50150(830)	7201-3	Thread Nipper (back) Cam Set Screw (2).....
17905	7201-29	Wrench.....	50169(819)	7201-6	Needle Bar Thread Guide Screw.....
17928	7201-20	Clamp Position Stud (For 421W301BA).....	50237(833)	7201-5	Button Clamp Spreader Lever Stop Position Screw (For 421W303BA, 421W307BA and 421W311BA).....
20972	7201-13	Tension Screw Stud 1110(803) with 1560(803).....	50446(803)	7201-16	Stop Motion Brake Shoe Support Hinge Screw.....
22666	7201-25	Treadle Shaft (2).....	50581(819)	7201-25	Treadle Extension Screw (2).....
23180	7201-25	Treadle Stand Bolt Washer.....	50650(803)	7201-6	Needle Bar Connecting Link Cap Screw.....
23308	7201-29	Screwdriver (8 in. blade).....	50807(819)	7201-27	Motor Bolt (4).....
23477	7201-3	Needle Bar Crank with 858(830), 1065(830) and two 350812(869).....	51074(819)	7201-25	Treadle Stand Bolt (4).....
23535	7201-29	Wrench.....	51119(805)	7201-9	Tripping Rock Shaft Lever Arm Screw.....
32134	7201-24	Operating Equipment Rock Shaft Spring (2).....	51369(805)	7201-8	Throat Plate Screw (4).....
32803	7201-20	Clamp complete, Nos. 202(819), 1182(819), 1656(819), 124646, 136873 and 167322 (For 421W301BA).....	51655(819)	7201-27	Belt Tightener Hinge Plate Adjusting Screw Nut (2).....
36696	7201-5	Button Clamp (left) Pad Pin (3) (For 421W303BA, 421W307BA and 421W311BA).....	51657(803)	7201-9	Starting Lever Starting Rod Lock Nut.....
36696	7201-5	Button Clamp (right) Pad Pin (3) (For 421W303BA, 421W307BA and 421W311BA).....	51701(819)	7201-8	Knife Driving Bar Latch Spring Stud Screw (upper) Lock Nut.....
37310	7201-11	Lateral Rock Shaft Cam Follower	51933	7201-3	Needle Guide Oscillating Crank Roller and Stud.....
37310	7201-21	Roller Screw Stud Nut Washer.....	51951	7201-11	Lateral Rock Shaft Cam Follower Roller and Screw Stud, Nos. 1655(803), 5968 and 37310.....
37310	7201-11	Longitudinal Rock Shaft Cam Follower Roller Screw Stud Nut Washer.....	51951	7201-11	Longitudinal Rock Shaft Cam Follower Roller and Stud, Nos. 1655(803), 5968 and 37310.....
			52843	7201-26	Drip Pan Screw Washer (leather) (4).....
			53612(805)	7201-20	Lateral Rock Shaft Driving Arm Screw Stud Nut (For 421W301BA).....

No.	Plate	Description	No.	Plate	Description
53612(805)	7201-20	Longitudinal Rook Shaft Driving Arm Screw Stud Nut (For 421W303PA)	131022	7201-14	Starting Lever Stop Cam Interlocking Arm Stop Rod Bumper (rubber) (3).....
53617(805)	7201-9	Starting Lever Starting Rod Swivel Stud Lock Nut.....	136598	7201-5	Button Clamp (left) with 17723, 45329 and three 36696 (For 421W303BA, 421W307BA and 421W311BA).....
53618(805)	7201-3	Arm Shaft (horizontal) Bushing (back) Support Screw Lock Nut.....		7201-5	Button Clamp (left) Spring (For 421W303BA, 421W307BA and 421W311BA).....
53626(803)	7201-12	Lateral Rook Shaft Driving Arm Screw Stud Nut (For 421W303PA, 421W307BA and 421W311BA).....	136600	7201-5	Button Clamp (right) with 17723, 45329 and three 36696 (For 421W303BA, 421W307BA and 421W311BA).....
53626(803)	7201-12	Longitudinal Rook Shaft Driving Arm Screw Stud Nut (For 421W303PA, 421W307BA and 421W311BA).....	136601	7201-5	Button Clamp (right) Spring (For 421W303BA, 421W307BA and 421W311BA).....
59704	7201-3	Arm Shaft (upright).....		7201-5	Button Clamp (right) Spring (For 421W303BA, 421W307BA and 421W311BA).....
59707	7201-3	Arm Shaft (upright) Bevel Gear (lower) with two 1253(830).....	136603	7201-5	Button Clamp Stop with 17720 and 63742 (For 421W303BA, 421W307BA and 421W311BA).....
59707	7201-3	Looper Shaft Bevel Gear with two 1253(830).....	136608	7201-3	Looper.....
59708	7201-3	Arm Shaft (upright) Bevel Gear (upper) with two 1253(830).....	136618	7201-3	Needle Guide Cam with two 195(803)
59739	7201-8	Knife Holder Stud.....	136622	7201-13	Thread Pull-off (rear).....
59776	7201-6	Thread Nipper (back) Stud with 13538.....	136677	7201-6	Thread Nipper (back) Eyelet.....
59777	7201-6	Thread Nipper (back) Stud complete, Nos. 13539, 13540 and 59776	136701	7201-3	Arm Shaft (upright) 59704 with 59707 and 59708.....
63741	7201-5	Button Clamp Spreader Thumb Plate (For 421W303BA, 421W307BA and 421W311BA).....	136719	7201-13	Thread Nipper (front) Thread Guide
63742	7201-5	Button Clamp Spreader Steady Pin (long) (For 421W303BA, 421W307BA and 421W311BA).....	136778	7201-13	Thread Pull-off (front).....
63825	7201-5	Clamp Arm Hook Stud.....	136780	7201-3	Arm Shaft (horizontal) Bevel Gear with two 141469(869).....
67425	7201-25	Treadle Stand Bolt Lock Washer (4)	136793	7201-3	Arm Shaft (upright) Bushing (lower).....
120342	7201-29	Oiler with 120343.....	136794	7201-3	Arm Shaft (upright) Bushing (upper).....
120343	7201-29	Oiler Spout (3-1/2 in. long).....	136795	7201-6	Needle Bar Bushing (upper).....
124646	7201-20	Clamp with 1220(805) and 17928 (For 421W301BA).....	136796	7201-13	Thread Pull-off Bell Crank Hinge Stud.....
124733	7201-5	Button Clamp Opening Lever (For 421W303BA, 421W307BA and 421W311BA).....	136797	7201-9	Tripping Rock Shaft Spacer.....
124735	7201-4	Clamp Opening Lever Contact Piece.	136799	7201-13	Thread Nipper (front) Lever Rod Cam (driven with 202(805).....
124737	7201-5	Button Clamp Spreader Lever (For 421W303BA, 421W307BA and 421W311BA).....	136800	7201-13	Thread Pull-off Bell Crank Bracket
124738	7201-5	Button Clamp Spreader Lever Adjusting Plate (For 421W303BA, 421W307BA and 421W311BA).....	136801	7201-8	Knife Driving Bar Spring.....
124739	7201-5	Button Clamp Spreader Lever Stop (For 421W303BA, 421W307BA and 421W311BA).....	136802	7201-7	Button Clamp Guiding Screw (2 hole buttons) Drag Spring (For 421W303BA, 421W307BA and 421W311BA).....
124740	-----	Button Clamp complete for 13 to 50 Ligne Thin Buttons (Optional Equip. for 421W303BA, 307BA and 311BA)	136803	7201-13	Thread Nipper (front) Lever Rod Cam (driving) with 237(830).....
124764	7201-3	Looper Shaft Bushing (front).....	136804	7201-13	Thread Pull-off Bell Crank with 624(830).....
126150	7201-27	Motor Bolt Nut Lock Washer (4)....	136805	7201-13	Thread Pull-off Bell Crank Extension.....
126150	7201-27	Table Screw Stud Nut Lock Washer (4).....	136806	7201-2	Arm Cover (front).....
			136807	7201-3	Looper Shaft Bushing (rear).....
			136808	7201-3	Needle Guide Shaft Bushing.....

No.	Plate	Description	No.	Plate	Description
136809	-----	Pair of Gears, for upper shaft, Nos. 59708 and 136792.....	136855	7201-8	Tripping Rock Shaft Bracket.....
136810	7201-6	Thread Nipper (back) Adapter Block with 1454(830).....	136856	7201-8	Knife Driving Bar Stop (in bracket).....
136811	7201-3	Thread Nipper (back) Cam with two 50150(830).....	136857	7201-8	Knife Driving Bar.....
136812	7201-13	Thread Pull-off Bell Crank Connection.....	136858	7201-2	Arm Cover (front) complete, Nos. 230(805), 136806, 136888, 140438(819), 175062, 175063, 175065, 202098, 223711, 228739, two each 185(809) and 136818.....
136813	7201-13	Thread Pull-off Bell Crank Bracket Mounting Screw Spacer.....	136859	7201-4	Thread Pull-off Driving Lever with 208(830) and two 140321(830) (NOTE: Screw 208(830) has no application for this machine.)....
136815	7201-8	Knife Cocking Lever Multiplier with 1226(803).....	136861	-----	Arm Shaft (horizontal) with 23477.
136816	7201-8	Knife Driving Bar Latch with 171(819) and 51701(819).....	136863	7201-18	Feed Cam with two 167234 and four each 140352(830) and 167235 (For 421W307BA).....
136818	7201-2	Arm Cover (front) Thread Retainer Screw Washer (2).....	136864	7201-13	Thread Nipper (front) and Thread Pull-off complete, Nos. 176(819), 846(803), 1282(803), 1454(830), 1747(809), 20972, 50087(830), 136677, 136778, 136780, 136796, 136799, 136800, 136803, 136804, 136805, 136812, 136852, 136870, 136871, 136872, 140431(803), 156316, 156376, 175032, 175179, 175182 and two 2102.....
136820	7201-8	Knife Cocking Lever with 769(850) and 1698(805).....	136868	7201-8	Knife Driving Bar Latch Spring....
136821	7201-8	Knife Driver (adjustable).....	136870	7201-13	Thread Nipper (front) Lever.....
136823	7201-8	Knife Holder.....	136871	7201-13	Thread Nipper (front) Lever Block.
136824	7201-10	Lateral Pivot and Feed Plate.....	136872	7201-13	Thread Nipper (front) Lever Block Pivot Pin.....
136826	7201-10	Carrier Bar Connecting Arm.....	136873	7201-20	Clamp Arm with 17714 (For 421W301BA).....
136827	7201-7	Lateral Feed Throw-out Collar (For 421W303BA and 421W307BA).....	136874	7201-20	Feed Plate (for 421W301BA).....
136828	7201-7	Button Clamp Guiding Screw (2 hole buttons) Holder (For 421W303BA, 421W307BA and 421W311BA).....	136875	-----	Feed Plate Carrier Bar 167029 with 136874, 141071(819), 167041 and 167055 (For 421W301BA).....
136829	7201-10	Button Clamp Guiding Screw (2 hole buttons) Stop (For 421W303BA, 421W307BA and 421W311BA).....	136876	-----	Feed Cam with four 167234 and eight each 140352(830) and 167235 (For 421W301BA).....
136830	7201-10	Lateral Pivot Driving Arm (For 421W303BA and 421W307BA).....	136877	-----	Feed Cam with two 167234 and four each 140352(830) and 167235 (For 421W303BA).....
136831	7201-10	Lateral Pivot Driving Arm 136829 with 1519(805), 136826, 141075(803), 214529, 239266, 350802(830) and three 350800(869) (For 421W303BA and 421W307BA).....	136879	7201-21	Longitudinal Rock Shaft (driving) (For 421W311BA).....
136833	7201-3	Looper Shaft with 50150(830).....	136880	-----	Longitudinal Rock Shaft (driving) 136879 with 51951 (For 421W311BA).
136839	7201-13	Thread Pull-off Bell Crank Bracket Stabilizing Pin.....	136881	7201-21	Longitudinal Rock Shaft (driven) (For 421W311BA).....
136842	7201-3	Needle Guide complete with Thread Finger, Nos. 136889, 175131 and two 218(804).....	136882	7201-21	Longitudinal Rock Shaft (driven) Coupling with 140409(869) (For 421W311BA).....
136846	-----	Arm Plug (right).....			
136847	7201-6	Needle Bar Take-up complete, Nos. 1492(819), 136848, 175100 and 175101.....			
136848	7201-6	Needle Bar Take-up with 160(805)..			
136849	7201-6	Thread Nipper (back) Body.....			
136850	7201-6	Thread Nipper (back) complete, Nos. 1654(809), 1743(809), 2026, 12162, 59777, 136701, 136810, 136849 and two 2921.....			
136852	7201-13	Thread Nipper (front) Lever Rod...			
136854	7201-1	Cylinder Cover (bottom)			

No.	Plate	Description	No.	Plate	Description
136886	7201-8	Throat Plate.....			
136888	7201-2	Arm Cover (front) Thread Guide (wire).....	140321(830)	7201-11	Longitudinal Rock Shaft Collar Set Screw (2) (For 421W301BA, 421W303BA and 421W307BA).....
136889	7201-3	Needle Guide Thread Finger.....			
136890	7201-4	Clamp Foot Lifter.....	140321(830)	7201-24	Operating Equipment Rock Shaft Collar Set Screw (4).....
136891	7201-4	Thread Wiper complete, Nos. 330(809), 39453, 136890, 141084(803), 141574(803), 167174, 167354, 239336 and 239387.....	140321(830)	7201-4	Thread Pull-off Driving Lever Set Screw (2).....
136892	7201-8	Knife Driving Bar Stop (nylon)....	140352(830)	7201-18	Feed Cam Tripping Point Screw (4) (NOTE: For 421W301BA (8).....
136893	7201-7	Feed Plate.....	140409(869)	7201-21	Longitudinal Rock Shaft (driven) Coupling Set Screw (For 421W311BA)
136894	7201-8	Knife Driving Bar Bumper (nylon)..			
136895	7201-8	Knife Driving Bar Bumper Screw Nut	140427(830)	7201-16	Starting Lever Arm and Rock Shaft Stop Screw.....
136896	7201-8	Knife Driving Bar Bumper complete, Nos. 1289(819), 7071, 136894 and 136895.....	140431(803)	7201-13	Thread Nipper (front) Thread Guide Screw.....
136897	-----	Feed Cam with two 167234 and four each 140352(830) and 167235 (For 421W311BA).....	140438(819)	7201-2	Arm Cover (front) Thread Guide (wire) Screw.....
136898	7201-7	Button Clamp Guiding Screw ( 2 hole button) Guide Block.....	141059(830)	7201-4	Clamp Lifting Rock Shaft Lifting Link Connection Screw.....
136899	7201-7	Cylinder Cover Plate (top)	141060(819)	7201-1	Arm Cover (side) Screw (4).....
136902	7201-16	Starting Lever Arm and Rock Shaft with 170(805), 1664(803) and 140427(830).....	141061(803)	7201-3	Arm Shaft (horizontal) Bushing (back) Set Screw.....
136903	7201-16	Starting Lever Arm (operated) with 350600(869).....	141061(803)	7201-4	Clamp Lifting Bar Stop Screw.....
136904	7201-7	Feed Plate Carrier Bar 167029 with 136899, 141071(819) and 167055 (For 421W303BA, 421W307BA and 421W311BA).....	141066(803)	7201-19	Cylinder Base Locating Screw (4)..
136907	7201-8	Knife (thread cutting).....	141067(805)	7201-19	Cylinder Base Locking Screw.....
136908	7201-8	Knife (thread cutting) Mounting Fork.....	141069(869)	7201-19	Arm Screw (3).....
136909	7201-3	Needle Guide Oscillating Crank with 1057(830) and 51933.....	141069(869)	7201-19	Cylinder Screw (2).....
136910	7201-8	Throat Plate Complete, Nos. 1547(803), 50018(806), 59739, 136823, 136886, 136907, 136908 136911, 136912 and two 1034(805)..	141069(869)	7201-17	Feed Cam Supporting Gear Bracket Screw.....
136911	7201-8	Thread Separator.....	141070(803)	7201-17	Feed Cam Supporting Gear Screw....
136912	7201-8	Thread Separator Screw Washer....	141071(819)	7201-7	Feed Plate Carrier Bar Driving Block Screw.....
136913	7201-21	Button Clamp Guiding Screw (2 hole buttons) Guide Block (For 421W311BA).....	141075(803)	7201-10	Lateral Rock Shaft Driven Arm Driving Link Screw.....
140049(805)	7201-8	Knife Driving Bar Stop Screw.....	141076(830)	7201-3	Arm Shaft (horizontal) Bushing (center) Set Screw.....
140082(819)	7201-1	Arm Cover (center) Screw (2).....	141076(830)	7201-11	Lateral Rock Shaft Driven Arm Hinge Stud Set Screw.....
140159(830)	7201-8	Knife Cooking Lever Screw (2).....	141076(830)	7201-11	Longitudinal Rock Shaft Driven Arm Hinge Stud Set Screw.....
140219(803)	7201-24	Operating Equipment Rock Shaft Stop Dog Set Screw (2).....	141077(830)	7201-14	Starting Lever Pushing Set Screw..
140220(819)	7201-13	Thread Pull-off Bell Crank Bracket Mounting Screw.....	141084(803)	7201-4	Thread Wiper Body Hinge Screw.....
140321(830)	7201-11	Lateral Rock Shaft Collar Set Screw (2).....	141093(830)	7201-23	Belt Guard Hinge Pin Set Screw....
			141093(830)	7201-9	Tripping Rock Shaft Support Screw.
			141099(805)	7201-14	Starting Lever Return Spring Screw Stud (upper) (2).....
			41100(850)	7201-16	Starting Lever Starting Rod Adjuster Hinge Screw.....
			41101(803)	7201-16	Stop Motion Brake Shoe Support Bracket Pressure Spring Adjusting Screw.....
			41103(850)	7201-23	Belt Guard Lock Spring Plate Screw (2).....

350819  
7201-8

No.	Plate	Description	No.	Plate	Description
141128(833)	7201-3	Arm Shaft (horizontal) Bushing (back) Support Screw.....	151220	7201-27	Belt Tightener Hinge Plate Adjusting Screw Hinge Bracket.....
141140(819)	7201-1	Cylinder Cover (bottom) Screw (?)	151221	7201-27	Belt Tightener Motor Plate Hinge Bracket.....
141211(869)	7201-7	Clamp Pressure Spring Screw (For 421W303BA, 421W307BA and 421W311BA).....	151222	7201-27	Belt Tightener Motor Plate Hinge Bracket Pin.....
141406(830)	7201-4	Thread Wiper Body Support Set Screw.....	151223	7201-27	Belt Tightener complete, Nos. 51655(819), 150783, 151066, 151219, 151220, 151221, 151222, two each 9281, 151068, four each 50807(819), 151369 and eight each 1778(819), 9842 and 126150.....
141407(869)	7201-3	Vertical Drive Shaft Worm Position Screw.....	151369	7201-27	Table Screw Stud (4).....
141407(869)	7201-17	Vertical Drive Shaft Worm Gear Position Screw.....	151633	7201-24	Operating Equipment Cable Yoke End Pin (2).....
141408(869)	7201-3	Vertical Drive Shaft Worm Set Screw.....	154305	7201-22	Gauge Pin.....
141408(869)	7201-17	Vertical Drive Shaft Worm Gear Set Screw.....	154308	7201-22	Set of Gauges for Centralizing Feed Mechanism (furnished upon request only).....
141449(803)	7201-9	Starting Bell Crank Pawl Hinge Screw.....	154355	7201-22	Gauge Pin Spring Plunger.....
141450(803)	7201-9	Starting Bell Crank Hinge Screw...	156316	7201-13	Tension Thread Guide.....
141469(869)	7201-3	Arm Shaft (horizontal) Bevel Gear Set Screw (2).....	156376	7201-13	Tension Spring.....
141545(803)	7201-12	Lateral Adjusting Lever Hinge Screw (For 421W303BA, 421W307BA and 421W311BA).....	167004	7201-4	Clamp Lifting Rock Shaft with 141059(830).....
141545(803)	7201-12	Longitudinal Adjusting Lever Handle Hinge Screw (For 421W303BA, 421W307BA and 421W311BA).....	167006	7201-4	Clamp Lifting Rock Shaft Lifting Arm with 350604(869).....
141550(803)	7201-12	Longitudinal Adjusting Lever Hinge Screw (For 421W303BA, 421W307BA and 421W311BA).....	167007	7201-4	Clamp Lifting Rock Shaft Lifting Link.....
141574(803)	7201-4	Thread Wiper Body Wire Clamping Plate Screw.....	167012	7201-3	Arm Shaft (horizontal) Bushing (back).....
149426	7201-22	Starting Lever Return Spring (Not for 421W301BA Machine).....	167013	7201-3	Arm Shaft (Horizontal) Bushing back) 167012 with 53618(805), 141128(833), 202299, 239374 and two 239383.....
149797	7201-10	Lateral Feed Throw-out Collar Retaining Ring (For 421W303BA and 421W307BA).....	167017	7201-3	Arm Shaft (upright) Hole Cover....
150203	7201-28	Thread Unwinder Spool Rest Cushion (felt).....	167017	7201-3	Thread Nipper (back) Cam Access Hole Cover.....
150701	7201-27	Belt Tightener Hinge Plate Adjusting Screw.....	167029	7201-7	Feed Plate Carrier Bar.....
150750	-----	Machine Driving Bolt 50 inch outside length for "V" Drive Machine Pulleys.....	167038	7201-4	Thread Wiper Body Support 167174 with 141084(803), 141574(803), 167354, 239336 and 239387.....
150783	7201-27	Belt Tightener Hinge Plate Adjusting Screw 150701 with 51655(819)..	167041	7201-20	Cylinder Cover (top) (For 421W301BA).....
151066	7201-27	Belt Tightener Hinge Plate Adjusting Screw Hinge Pin.....	167044	7201-3	Vertical Drive Shaft Worm with 141407(869) and 141408(869) (For 421W307BA and 421W311BA).....
151068	7201-27	Belt Tightener Hinge Plate Adjusting Screw Hinge Pin Retaining Ring (2).....	167048	7201-20	Lateral Rock Shaft Driving Arm Screw Stud (For 421W301BA).....
151219	7201-27	Belt Tightener Motor Plate.....	167048	7201-20	Longitudinal Rock Shaft Driving Arm Screw Stud (For 421W301BA)....
			167049	7201-3	Arm Shaft (horizontal) Bushing (Center).....
			167050	7201-17	Feed Cam Supporting Gear Bracket..

No.	Plate	Description	No.	Plate	Description
167054	7201-7	Feed Plate Carrier Bar Driving Block with 239501.....	167161	7201-16	Stop Motion Brake Shoe Support Bracket 167159 with 50446(803), 141101(803), 223812, 239513 and 239557.....
167055	7201-7	Feed Plate Carrier Bar Driving Block complete, Nos. 167054 and 167056.....	167168	7201-6	Thread Retainer (back).....
167056	7201-7	Feed Plate Carrier Bar Driving Block Spacer.....	167174	7201-4	Thread Wiper Body Support.....
167073	7201-17	Vertical Drive Shaft Worm Gear with 141407(869) and 141408(869) (For 421W307BA and 421W311BA).....	167181	7201-9	Tripping Rock Shaft.....
167075	7201-21	Lateral Pivot Driving Arm with 350600(869) (For 421W301BA and 421W311BA).....	167182	7201-9	Tripping Rock Shaft Collar with two 460(830).....
167076	7201-21	Lateral Pivot Driving Arm 167055 with 1519(805), 141075(803) and 239266 (For 421W301BA and 421W311BA).....	167186	7201-28	Thread Unwinder Thread Guide.....
167077	7201-19	Vertical Drive Shaft Worm with 141407(869) and 141408(869) (For 421W301BA and 421W303BA).....	167187	7201-23	Belt Guard with 141093(830).....
167079	7201-19	Vertical Drive Shaft Worm Gear with 141407(869) and 141408(869) (For 421W301BA and 421W303BA).....	167188	7201-23	Belt Guard Lock Spring Plate.....
167084	7201-15	Machine Pulley (loose) Engaging Arm Stud.....	167189	7201-23	Belt Guard complete, Nos. 167187, 167188, 239356, 239357 and two 141103(850).....
167086	7201-6	Needle Bar.....	167226-001	7201-24	Operating Equipment Cable (long) (2).....
167087	7201-6	Needle Bar 167086 with 209(833), 50169(819) and 239376.....	167229	7201-16	Stop Motion Brake Shoe Support Bracket Pressure Spring.....
167088	7201-6	Needle Bar Connecting Link 271597 with 50650(803), 167089-001 and 239385.....	167234	7201-18	Feed Cam Tripping Point (2) (NOTE: For 421W301BA (4).....
167089-001	7201-6	Needle Bar Connecting Stud with 175(830) and 239277.....	167235	7201-18	Feed Cam Tripping Point Screw Washer (4) (NOTE: For 421W301BA (8).....
167143	7201-9	Starting Bell Crank.....	167260	7201-29	Wrench.....
167144	7201-9	Starting Bell Crank 167143 with 51657(803), 53617(805), 167154 and 167155.....	167261	7201-28	Thread Unwinder (for one spool) complete, Nos. 150203, 167186, 228764, 228765, 228767, 228768, 228770, 228774 and three wood screws 7/8 in. No. 12 R.H.B.....
167145	7201-14	Starting Lever with 141077(830)....	167277	7201-4	Clamp Lifting Rock Shaft Collar (knurled) with 465(830).....
167146	7201-14	Starting Lever 167145 with 239159, 239307 and two each 141099(805) and 214053.....	167278	7201-4	Clamp Lifting Rock Shaft Collar (knurled) Spring.....
167148	7201-16	Starting Lever Arm (operated) Key.	167292	7201-19	Thread Unwinder Mounting Bracket with 462(830) (NOTE: Screw 462(830) has no application for this machine.).....
167154	7201-9	Starting Lever Starting Rod.....	167317	7201-5	Button Clamp (left) Adjusting Spring (For 421W303BA, 421W307BA and 421W311BA).....
167155	7201-9	Starting Lever Starting Rod Adjuster.....	167319	7201-5	Button Clamp (right) Adjusting Spring (For 421W303BA, 421W307BA and 421W311BA).....
167157	7201-14	Starting Lever Stop Cam Interlocking Arm Stop Rod Swivel.....	167320	7201-5	Button Clamp Arm with 17714 (For 421W303BA, 421W307BA and 421W311BA).....
167159	7201-16	Stop Motion Brake Shoe Support Bracket with 171(830) and 201(804)	167321	7201-5	Button Clamp Arm complete, Nos. 202(819), 1182(819), 167320 and 167322 (For 421W303BA, 421W307BA and 421W311BA).....
167160	7201-14	Starting Lever Stop Cam Interlocking Arm Stop Rod Swivel Retaining Ring.....	167322	7201-5	Clamp Arm Hook with 63825.....
				7201-20	



No.	Plate	Description	No.	Plate	Description
167323	7201-5	Button Clamp Opening Lever Bracket (For 421W303BA, 421W307BA and 421W311BA).....	167446	7201-14	Starting Lever Stop Cam Interlocking Arm Stop Rod complete, Nos. 167445, 202342, 239518 and 239519.
167324	7201-5	Button Clamp Spreader Spring (For 421W303BA, 421W307BA and 421W311BA).....	167447	7201-14	Starting Lever Stop Cam Interlocking Arm Stop Rod complete, Nos. 167157, 167445, 202342, 239518, 239519, two 1518(805), three 131022 and four 2807.....
167325	7201-5	Button Clamp complete, Nos. 99(819), 202(819), 1181(819), 1183(819), 1199(819), 39242, 50237(833), 63741, 124733, 124737, 124738, 124739, 136598, 136600, 136601, 136603, 136608, 167317, 167319, 167320, 167322, 167323, 167324, two each 230(819), 1175(850), 17718 and four 1182(819) (For 421W303BA, 421W307BA and 421W311BA).....	167448	7201-26	Machine Base Oil Drain Jar (plastic).....
			167449	7201-12	Lateral Rock Shaft Driving Arm Screw Stud Nut Washer (For 421W303BA, 421W307BA and 421W311BA).....
167329	7201-12	Longitudinal Adjusting Lever (For 421W303BA, 421W307BA and 421W311BA).....	167449	7201-12	Longitudinal Rock Shaft Driving Arm Screw Stud Nut Washer (For 421W303BA, 421W307BA and 421W311BA).....
167330	7201-12	Adjusting Device complete Nos. 1654(803), 2018, 141550(803), 167329, 239533, 239534, 239536, two each 1620(805), 53626(803), 141545(803), 167335, 167449, 350812(869) and three each 167459 and 202622 (For 421W303BA, 421W307BA and 421W311BA).....	167458	7201-14	Starting Lever with Starting Lever Stop Cam Interlocking Arm Stop Rod complete, Nos. 167145, 167157, 167160, 167445, 202342, 239159, 239307, 239518, 239519, two each 1518(805), 141099(805), 214053, three 131022 and four 2807.....
167335	7201-12	Lateral Rock Shaft Driving Arm Screw Stud (For 421W303BA, 421W307BA and 421W311BA).....	167459	7201-12	Lateral Adjusting Lever Hinge Screw Friction Washer (For 421W303BA, 421W307BA and 421W311BA).....
167335	7201-12	Longitudinal Rock Shaft Driving Arm Screw Stud (For 421W303BA, 421W307BA and 421W311BA).....	167459	7201-12	Longitudinal Adjusting Lever Handle Hinge Screw Friction Washer (For 421W303BA, 421W307BA and 421W311BA).....
167354	7201-4	Thread Wiper Body Wire (adjustable).....	167459	7201-12	Longitudinal Adjusting Lever Hinge Screw Friction Washer (For 421W303BA, 421W307BA and 421W311BA).....
167414	7201-9	Starting Bell Crank Pawl Hinge Screw 141449(803) with 1662(805)....	175032	7201-13	Thread Nipper (front) Lever Rod Spring Washer.....
167415	7201-9	Starting Bell Crank Hinge Screw 141450(803) with 1662(805).....	175062	7201-2	Arm Cover (front) Thread Guide Plate.....
167416	7201-11	Lateral Rock Shaft Collar with two 140321(830).....	175063	7201-2	Arm Cover (front) Thread Guide Plate Screw Spacing Collar.....
167416	7201-11	Longitudinal Rock Shaft Collar with two 140321(830) (For 421W301BA, 421W303BA and 421W307BA).....	175065	7201-2	Arm Cover (front) Thread Guide Roller Pin.....
167416	7201-24	Operating Equipment Rock Shaft Collar with two 140321(830) (2).....	175100	7201-6	Needle Bar Take-up Thread Guide Plate.....
167426	-----	Clamp complete 32803 with 1176(819), 1177(819), 1178(819), 17710, 17712, 39335, 136875 and 239572 (For 421W301BA).....	175101	7201-6	Needle Bar Take-up Thread Guide Plate Roller.....
			175131	7201-3	Needle Guide Pin.....
			175175	7201-8	Knife Cooking Lever Screw Washer (2).....
167445	7201-14	Starting Lever Stop Cam Interlocking Arm Stop Rod.....	175179	7201-13	Thread Nipper (front) Lever Rod Spring.....

No.	Plate	Description	No.	Plate	Description
175182	7201-13	Thread Nipper (front) Lever Rod	210958	7201-2	Arm Cover (front) Thread Retainer Stud Collar.....
		Spring Collar with 465(R30).....	210993	7201-2	Arm Cover (front) Thread Retainer Sleeve.....
200072(803)	7201-4	Clamp Lifting Bar Position Guide Clamping Screw.....	214053	7201-14	Starting Lever Return Spring (2)..
200184(819)	7201-22	Eye Guard Bracket Screw (2).....	214529	7201-10	Lateral Feed Throw-out Screw Drag Spring (For 421W303BA and 421W307BA).....
200246(803)	7201-26	Machine Tilting Latch Lever Screw..		7201-21	Longitudinal Feed Throw-out Screw Drag Spring (For 421W311BA).....
200273(819)	7201-22	Eye Guard Bracket Hinge Screw.....		7201-2	Arm Cover (front) Thread Retainer with 200397(833).....
200397(833)	7201-2	Arm Cover (front) Thread Retainer Stud Set Screw.....	214529	7201-2	Arm Cover (front) Thread Retainer complete, Nos. 210957, 210958, 210993, 223710 and 223844.....
201188(803)	7201-4	Clamp Lifting Rock Shaft Collar Set Screw.....	223710	7201-16	Stop Motion Brake Shoe Support Spring.....
201254(830)	7201-28	Thread Unwinder Spool Rest Set Screw.....	223711	7201-2	Arm Cover (front) Thread Retainer Spring.....
201308(805)	7201-26	Drip Pan Screw (4).....	223812	7201-3	Arm Shaft (horizontal) Bushing (center) Oil Packing (wick).....
201356(805)	7201-4	Starting Lever Lifting Rod Operating Lever Arm Screw Stud.....	223844	7201-3	Arm Shaft (horizontal) Bushing (front) Oil Packing (wick).....
202005	7201-17	Feed Cam Supporting Gear Bracket Washer.....	223847	7201-29	Screwdriver.....
202098	7201-2	Arm Cover (front) Thread Guide Roller.....	223847	7201-29	Wrench.....
202299	7201-3	Arm Shaft (horizontal) Pushing (back) Oil Packing (wick).....	225498	7201-22	Eye Guard Bracket Spring Washer..
202342	7201-14	Starting Lever Stop Cam Interlocking Arm Stop Rod Hinge Pin Tension Spring.....	225554	7201-26	Machine Cushion (4).....
202423	7201-11	Lateral Rock Shaft Driven Arm Hinge Stud Oil Packing (wick).....	226467	7201-29	Screwdriver.....
202423	7201-11	Longitudinal Rock Shaft Driven Arm Hinge Stud Oil Packing (wick).....	228444	7201-2	Arm Cover (front) Thread Eyelet...
202622	7201-12	Lateral Adjusting Lever Hinge Screw Nut Washer (For 421W303BA, 421W307BA and 421W311BA).....	228476	7201-28	Thread Unwinder Spool Pin.....
202622	7201-12	Longitudinal Adjusting Lever Handle Spacing Washer (For 421W303BA, 421W307BA and 421W311BA).....	228739	7201-28	Thread Unwinder Spool Rest with 201254(830).....
202622	7201-12	Longitudinal Adjusting Lever Handle Hinge Screw Nut Washer (For 421W303BA, 421W307BA and 421W311BA).....	228764	7201-28	Thread Unwinder Spool Rest Rod....
202784	7201-24	Operating Equipment Chain Hook (4)	228767	7201-28	Thread Unwinder Thread Guide Holder (for one or two guides)....
203172	7201-3	Needle Bar Crank Friction Washer..	228768	7201-28	Thread Unwinder Thread Guide Rod..
203637	7201-26	Drip Pan Screw Washer (4).....	228770	7201-26	Drip Pan.....
210805	7201-18	Feed Cam Mounting Screw Washer (3)	228774	7201-26	Machine Support (left).....
210805	7201-20	Lateral Rock Shaft Driving Arm Screw Stud Nut Washer (For 421W301BA).....	228785	7201-26	Machine Tilting Latch Lever complete.....
210805	7201-20	Longitudinal Rock Shaft Driving Arm Screw Stud Nut Washer (For 421W301BA).....	228786	7201-26	Machine Tilting Latch Lever Spring
210957	7201-2	Arm Cover (front) Thread Retainer Stud.....	228788	7201-24	Operating Equipment Chain with two 202784 (2).....
			228789	7201-24	Operating Equipment Rock Shaft Lever Arm (4).....
			228802	7201-24	Operating Equipment Rock Shaft Lever Arm Bracket with two 356(803) (4).....
			228805	7201-24	Operating Equipment complete, Nos. two each 2770, 32134, 167416, 228802, 228811, 228861 and four each 228805 and 228806.....

No.	Plate	Description	No.	Plate	Description
228809	7201-26	Machine Support (right) with two wood screws 1-1/4 in. No. 12 F.H..	239267	7201-11	Lateral Rock Shaft Driven Arm Hinge Stud with 202423.....
228811	7201-24	Operating Equipment Rock Shaft (2)	239267	7201-11	Longitudinal Rock Shaft Driven Arm Hinge Stud with 202423.....
228822	7201-25	Treadle complete, Nos. 2718(819), 14372, 14373, 14375, 22666, 50581(819) and two each 13288, 23180, 51074(819) and 67425 (2)...	239268	7201-11	Lateral Rock Shaft Driving Arm with 350604(869) (For 421W301BA)..
228858	7201-24	Operating Equipment Cable Yoke End. (2).....	239268	7201-11	Longitudinal Rock Shaft Driving Arm with 350604(869) (For 421W301BA).....
228861	7201-24	Operating Equipment Cable (adjustable) complete, Nos. 1521(819), 151633, 167226-001 and 228858 (2).	239273	7201-6	Needle Bar Pushing (lower).....
228865	7201-26	Machine Support (left) 228786 with two wood screws 1-1/4 in. No. 12 F.H.....	239277	7201-6	Needle Bar Connecting Stud Oil Packing (wick).....
228910	7201-24	Operating Equipment Chain (24 in. long) (2).....	239294	7201-9	Starting Bell Crank Pawl.....
239123	7201-4	Clamp Opening Lever Contact Piece Arm.....	239295	7201-9	Starting Bell Crank Pawl Hinge Screw Return Spring.....
239144	7201-11	Longitudinal Rock Shaft (driving). 239384 with 51951 (For 421W301BA, 421W303BA and 421W307BA).....	239299	7201-9	Starting Lever Arm Lifting Rod....
239159	7201-14	Starting Lever Stop Cam Interlocking Arm.....	239301	7201-14	Starting Lever Bushing.....
239160	7201-11	Lateral Rock Shaft 239264 with 51951.....	239303	7201-4	Starting Lever Lifting Rod Operating Lever Arm.....
239211	7201-4	Clamp Lifting Bar with 176(819)...	239307	7201-14	Starting Lever Stop Cam Interlocking Arm Retaining Ring.....
239212	7201-4	Clamp Lifting Bar Bushing (lower).	239314	7201-3	Machine Pulley (tight) Key.....
239213	7201-4	Clamp Lifting Bar Position Guide with 167007, 200072(803) and 239515.....	239315	7201-3	Machine Pulley (loose) Retaining Ring.....
239214	7201-4	Clamp Lifting Bar Spring.....	239315	7201-3	Machine Pulley (tight) Retaining Ring.....
239218	7201-4	Clamp Lifting Rock Shaft Lifting Link Connection.....	239317	7201-15	Machine Pulley (loose).....
239221	7201-1	Arm Cover (center).....	239318	7201-15	Machine Pulley (loose) 239317 with 239322.....
239223-451	7201-1	Arm Cover (side) (For 421W307BA)..	239320	7201-15	Machine Pulley (loose) Engaging Arm Wear Block.....
239223-452	7201-1	Arm Cover (side) (For 421W301BA)..	239321	7201-15	Machine Pulley (loose) Engaging Arm Wear Block Pin.....
239223-453	7201-1	Arm Cover (side) (For 421W303BA)..	239322	7201-15	Machine Pulley (loose) Needle Bearing.....
239223-454	7201-1	Arm Cover (side) (For 421W311BA)..	239336	7201-4	Thread Wiper Body Wire Clamping Plate.....
239228	7201-3	Arm Shaft (horizontal) Bushing (front).....	239341	7201-9	Tripping Rock Shaft Connection with 350606(869).....
239234	7201-20	Cylinder Cover (side) (For 421W301BA).....	239342	7201-9	Tripping Rock Shaft Connection Rod
239245	7201-17	Feed Cam Supporting Gear Cam Locating Pin.....	239343	7201-9	Tripping Rock Shaft Lever Arm....
239250	7201-7	Feed Plate Carrier Bar Driving Block Oscillating Slide Stud.....	239344	7201-9	Tripping Rock Shaft Support.....
239264	7201-11	Lateral Rock Shaft.....	239345	7201-17	Vertical Drive Shaft.....
239265	7201-11	Lateral Rock Shaft Driven Arm....	239346	7201-17	Vertical Drive Shaft Bushing (lower).....
239265	7201-11	Longitudinal Rock Shaft Driven Arm	239346	7201-17	Vertical Drive Shaft Bushing (upper).....
239266	7201-10	Lateral Rock Shaft Driven Arm	239350	7201-29	Pliers.....
	7201-21	Driving Link.....	239353	7201-29	Wrench.....
			239355	7201-23	Belt Guard Base.....
			239356	7201-23	Belt Guard Hinge Pin.....
			239357	7201-23	Belt Guard Lock Spring.....

No.	Plate	Description	No.	Plate	Description
239371	7201-29	Wrench.....	239536	7201-12	Longitudinal Adjusting Lever
239374	7201-3	Machine Pulley (tight) Needle Thrust Bearing.....			Handle (For 421W303BA, 421W307BA and 421W311BA).....
239376	7201-6	Needle Bar Thread Guide.....	239549	7201-16	Stop Motion Brake complete, Nos. 141100(850), 167161, 167229 and 239512.....
239379	7201-15	Machine Pulley (loose) Engaging Arm with 239320, 239321 and 350600(869).....	239554	7201-16	Stop Motion Brake Shoe (leather)..
239382	7201-15	Machine Pulley (loose) Starting Cap Needle Plate.....	239555	7201-16	Stop Motion Brake Shoe Rivet (2)..
239383	7201-3	Machine Pulley (tight) Needle Thrust Bearing Washer (2).....	239556	7201-16	Stop Motion Brake Shoe Support....
239384	7201-11	Longitudinal Rock Shaft (driving) (For 421W301BA, 421W303BA and 421W307BA).....	239557	7201-16	Stop Motion Brake Shoe Support complete, Nos. 239554, 239556 and two 239555.....
239385	7201-6	Needle Bar Connecting Link Crank..	239572	7201-7	Clamp Pressure Spring Bracket.....
239387	7201-4	Thread Wiper Body.....	239574	7201-11	Lateral Rock Shaft Driving Arm Screw Stud Guide Block.....
239394	-----	Work Plate complete (furnished upon request only).....	239574	7201-11	Longitudinal Rock Shaft Driving Arm Screw Stud Guide Block.....
239444-001	7201-23	Belt Guard Base 239355 with wood screws 1-1/4 in. No. 12 R.H.....	239623	7201-11	Lateral Rock Shaft Driving Arm with 350604(869) (For 421W303BA, 421W307BA and 421W311BA).....
239448	7201-7	Feed Plate Carrier Bar Driving Block Spacer Position Pin (2).....	239623	7201-11	Longitudinal Rock Shaft Driving Arm with 350604(869) (For 421W303BA, 421W307BA and 421W311BA).....
239486-001	7201-15	Machine Pulley (tight).....	255540	7201-29	Wrench.....
239487	7201-4	Starting Lever Lifting Rod.....	259470	7201-4	Clamp Lifting Rock Shaft Collar with 201188(803).....
239501	7201-7	Feed Plate Carrier Bar Driving Block Pin.....	259830	7201-22	Eye Guard Deflector.....
239512	7201-16	Stop Motion Brake Shoe Support Bracket Pressure Spring Sleeve....	259831	7201-22	Eye Guard Bracket.....
239513	7201-16	Stop Motion Brake Shoe Support Bracket Stud (eccentric).....	259832	7201-22	Eye Guard complete, Nos. 200273(819), 226467, 259830, 259831 and two 200184(819).....
239515	7201-4	Clamp Lifting Rock Shaft Lifting Link Hinge Pin.....	271597	7201-6	Needle Bar Connecting Link.....
239518	7201-14	Starting Lever Stop Cam Interlocking Arm Stop Rod Hinge Pin.....	350600(869)	7201-18	Feed Cam Mounting Screw (3).....
239519	7201-14	Starting Lever Stop Cam Interlocking Arm Stop Rod Hinge Pin Retainer.....	350600(869)	7201-21	Lateral Pivot Driving Arm Clamping Screw (For 421W301BA and 421W311BA).....
239522	7201-17	Feed Cam Supporting Gear with 239245.....	350600(869)	7201-15	Machine Pulley (loose) Engaging Arm Clamping Screw.....
239524	7201-15	Machine Pulley (loose) Starting Cap.....	350600(869)	7201-16	Starting Lever Arm (operated) Key Clamping Screw.....
239525	7201-15	Machine Pulley (loose) Starting Cap Needle Button.....	350604(869)	7201-4	Clamp Lifting Rock Shaft Lifting Arm Clamping Screw.....
239526	7201-15	Machine Pulley (loose) Starting Cap Needle Thrust Bearing.....	350604(869)	7201-11	Lateral Rock Shaft Driving Arm Clamping Screw.....
239533	7201-12	Cylinder Cover (side) (For 421W303BA, 421W307BA and 421W311BA).....	350604(869)	7201-11	Longitudinal Rock Shaft Driving Arm Clamping Screw.....
239534	7201-12	Lateral Adjusting Lever (For 421W303BA, 421W307BA and 421W311BA).....	350606(869)	7201-9	Tripping Rock Shaft Connection Pinch Screw.....
			350799(819)	7201-4	Clamp Lifting Bar Pressure Regulating Screw.....

No.	Plate	Description
350800(869)	7201-10	Lateral Feed Throw-out Collar Positioning Screw (3) (For 421W303BA and 421W307BA).....
350802(830)	7201-10	Lateral Feed Throw-out Screw (For 421W303BA and 421W307BA).....
350802(830)	7201-21	Longitudinal Feed Throw-out Screw (For 421W311BA).....
350805(803)	7201-8	Knife Cooking Lever Multiplier Hinge Screw.....
350805(803)	7201-8	Knife Driving Bar Latch Hinge Screw.....
350812(869)	7201-12	Lateral Rock Shaft Driving Arm Screw Stud Locking Screw.....
350812(869)	7201-12	Longitudinal Rock Shaft Driving Arm Screw Stud Locking Screw.....
350812(869)	7201-3	Needle Bar Connecting Link Crank Set Screw (2).....

ILLUSTRATIONS  
OF  
PARTS

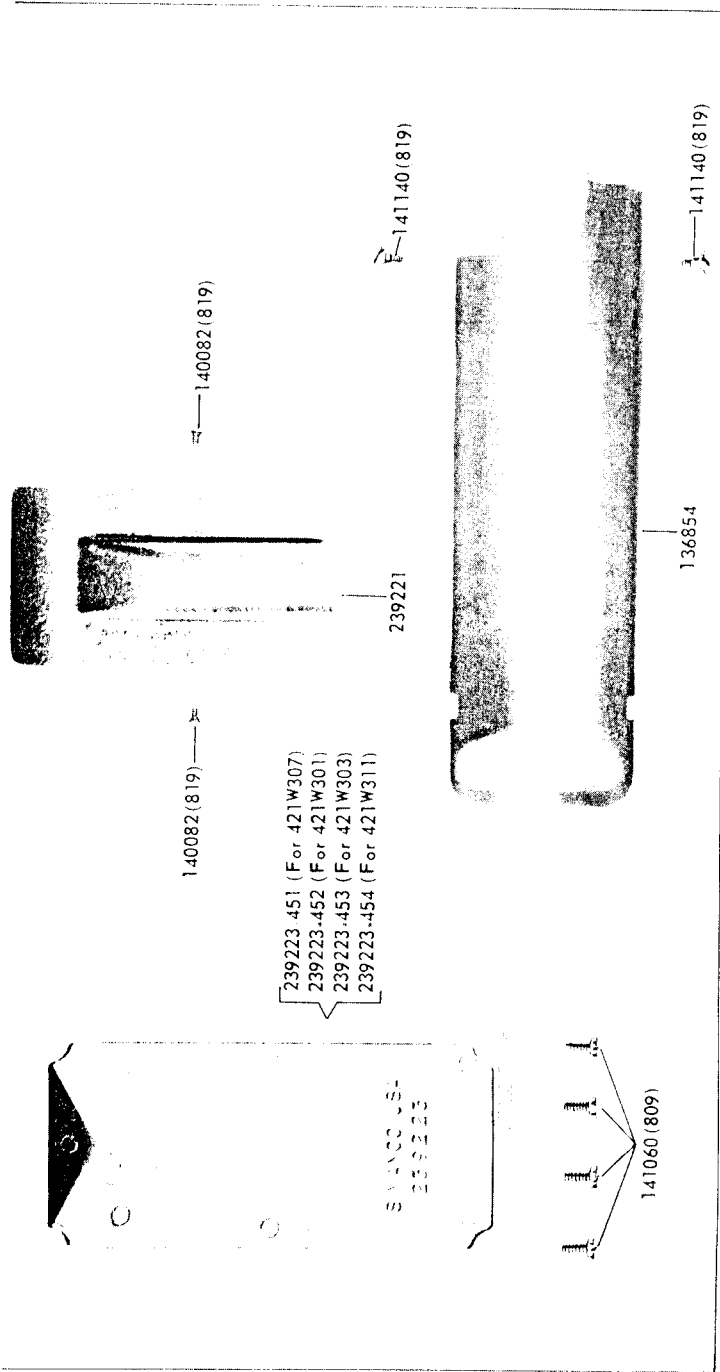

Memorandum

RECEIVED

SINGER

to: Mr. J. J. Kiernan  
from: H. J. Howard  
subject: Input - 421W Machines

1973  
ELIZABETH IND.  
PRODUCT LAB.

*Walt Mendles*

refer to: 390-M-45

date: 10-15-73

Referring to your conversation with Mr. Walt Mendles,  
enclosed is input for a Service Newsletter (World Wide on  
new 421W parts.

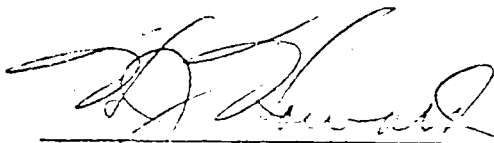

H. J. Howard  
Technical Services - ISPD

HJH:jm

enc.

cc: Mr. W. Mendles ✓

P.S. Mr. Mendles indicated it's urgent that this  
information be distributed as quickly as possible.

421W MACHINES - CHANGES IN KNIFE DRIVING SYSTEM PARTS

To eliminate field complaints on breakage improved parts have been adopted ofr 421W class machines as follows:

<u>New Part</u>	<u>Description</u>	<u>Replacing</u>
✓ 136929	Knife Driving Bar Stop (in Bracket)	136856
✓ 136930 (3)	Knife Driving Bar Stop Screw Lock Washer	--
✓ 136931	Knife Driving Bar Stop (Nylon)	136892
✓ 350819	Knife Driving Bar Stop Screw	140049
✓ 1115 (2)	Knife Driving Bar Stop (in Bracket) Screw	(2) 51047
✓ 350820	Knife Driving Bar Latch Tripping Screw	769



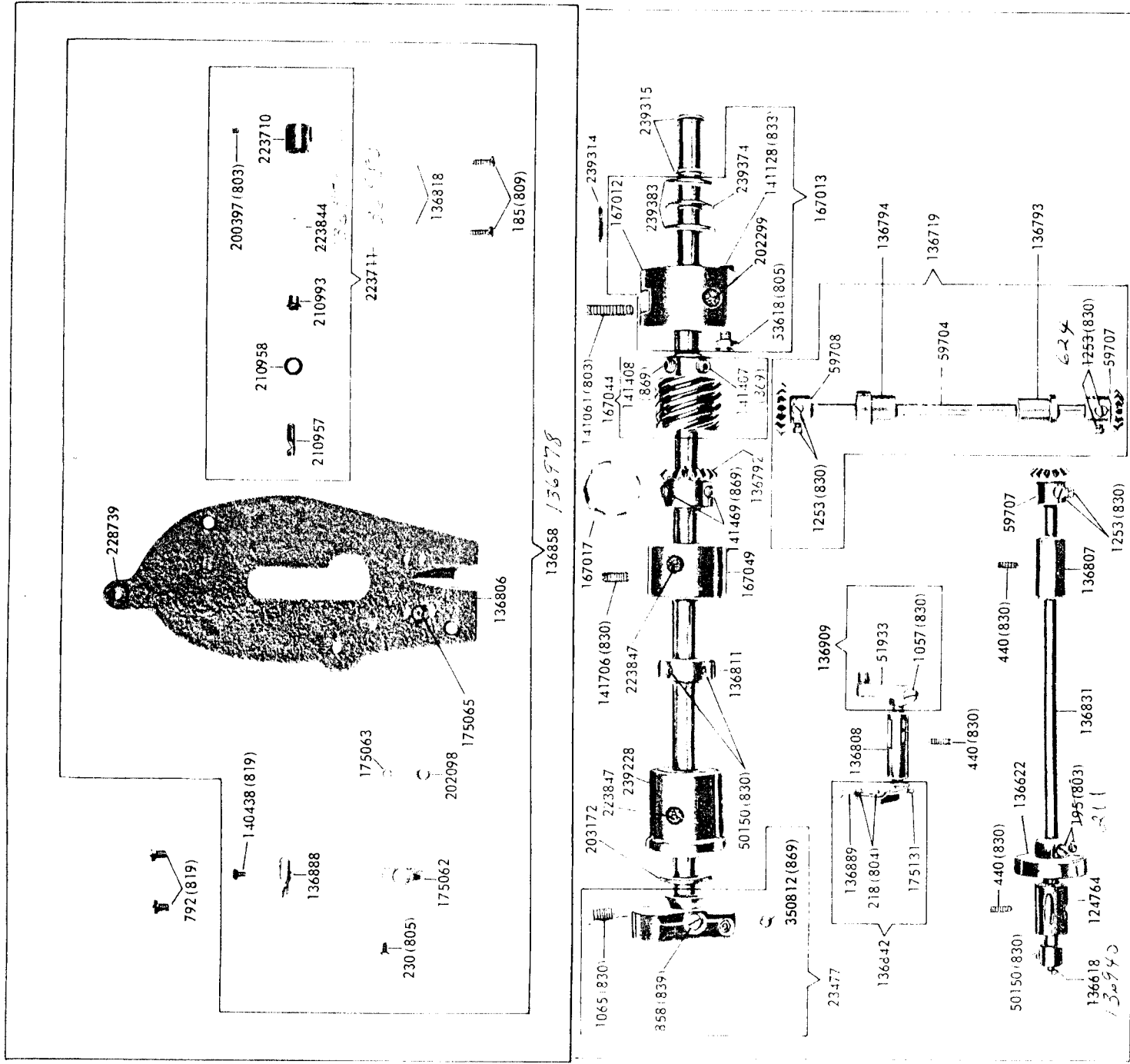

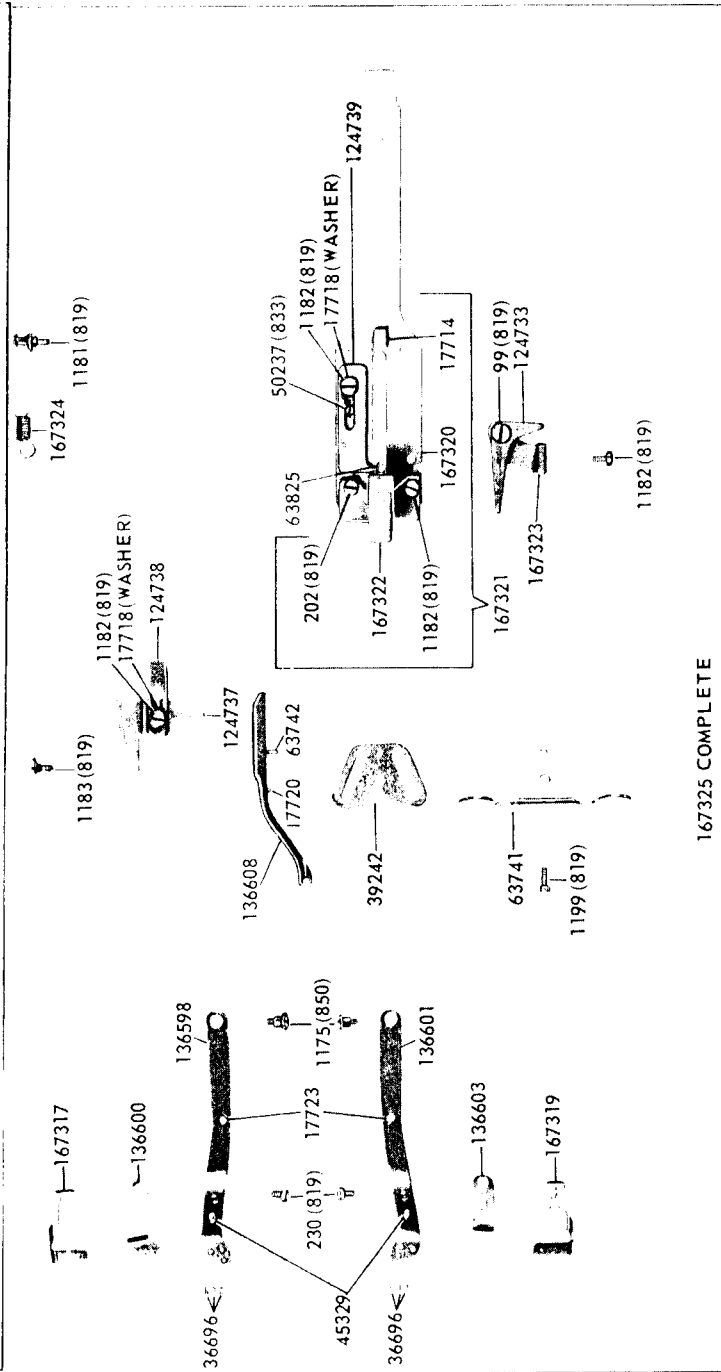
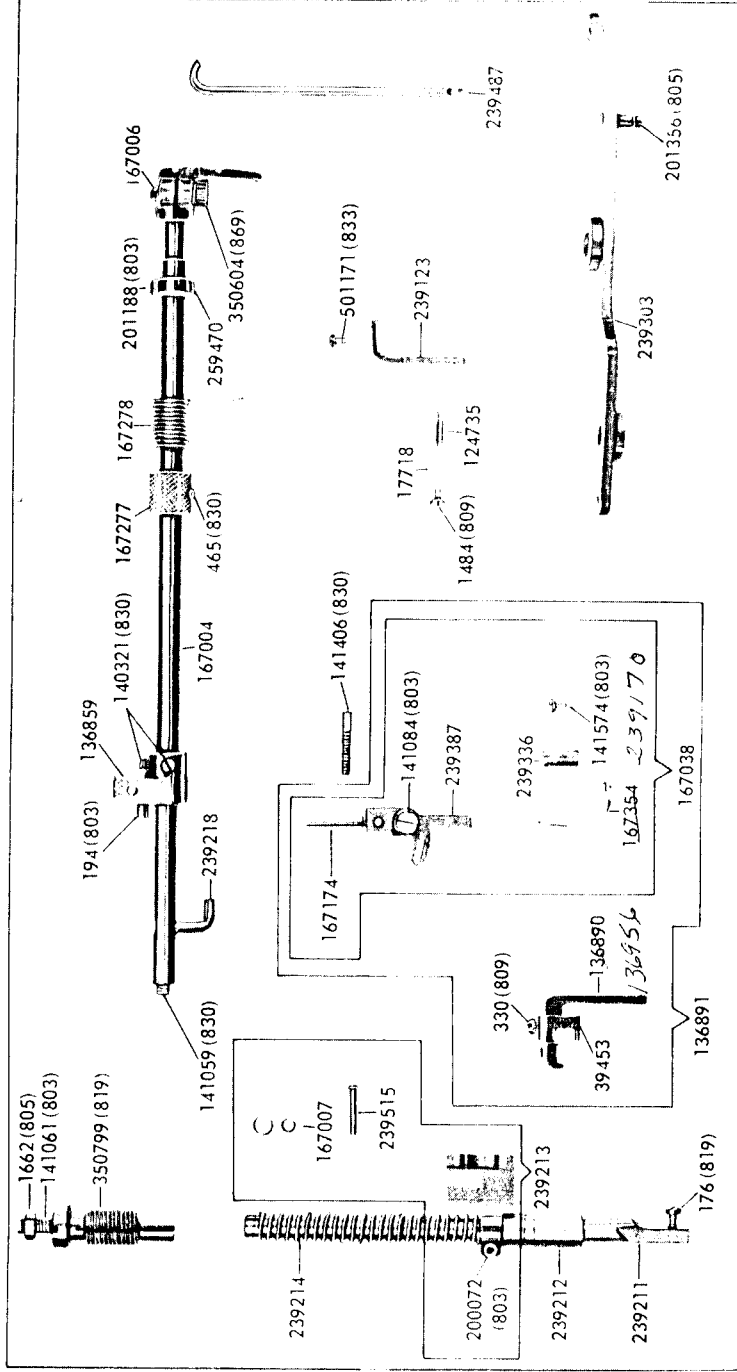

167325 COMPLETE

136926

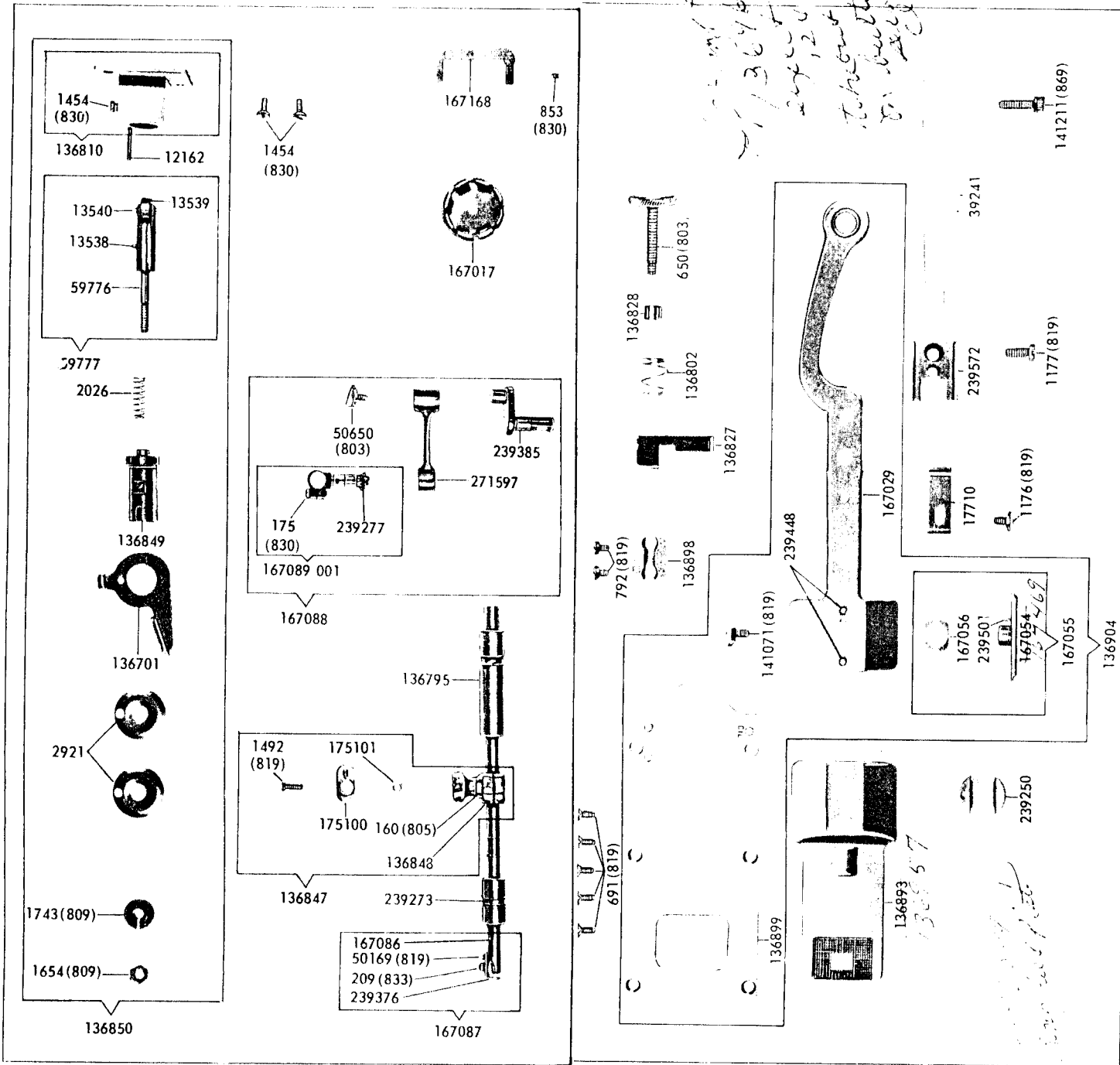

7201-8

7201-9

ch (p (p s p d p lac RI

250519 # 10049  
UN 2004

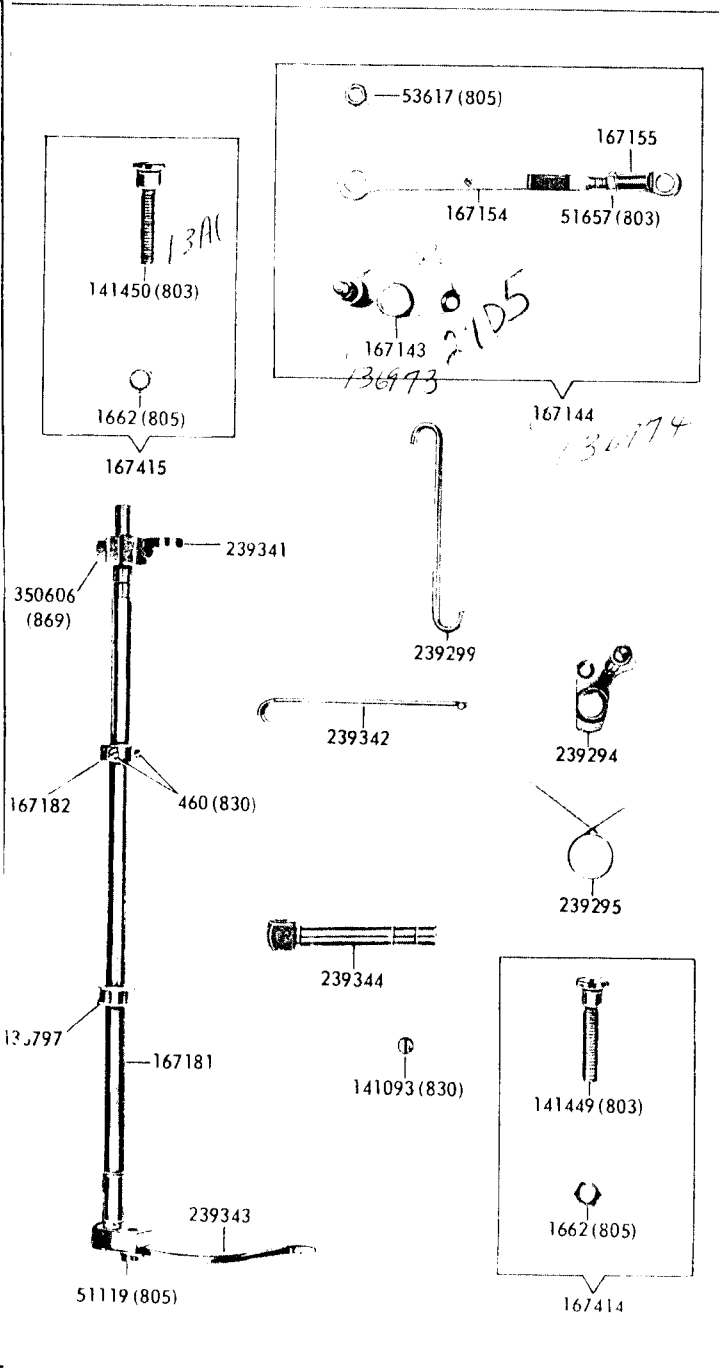
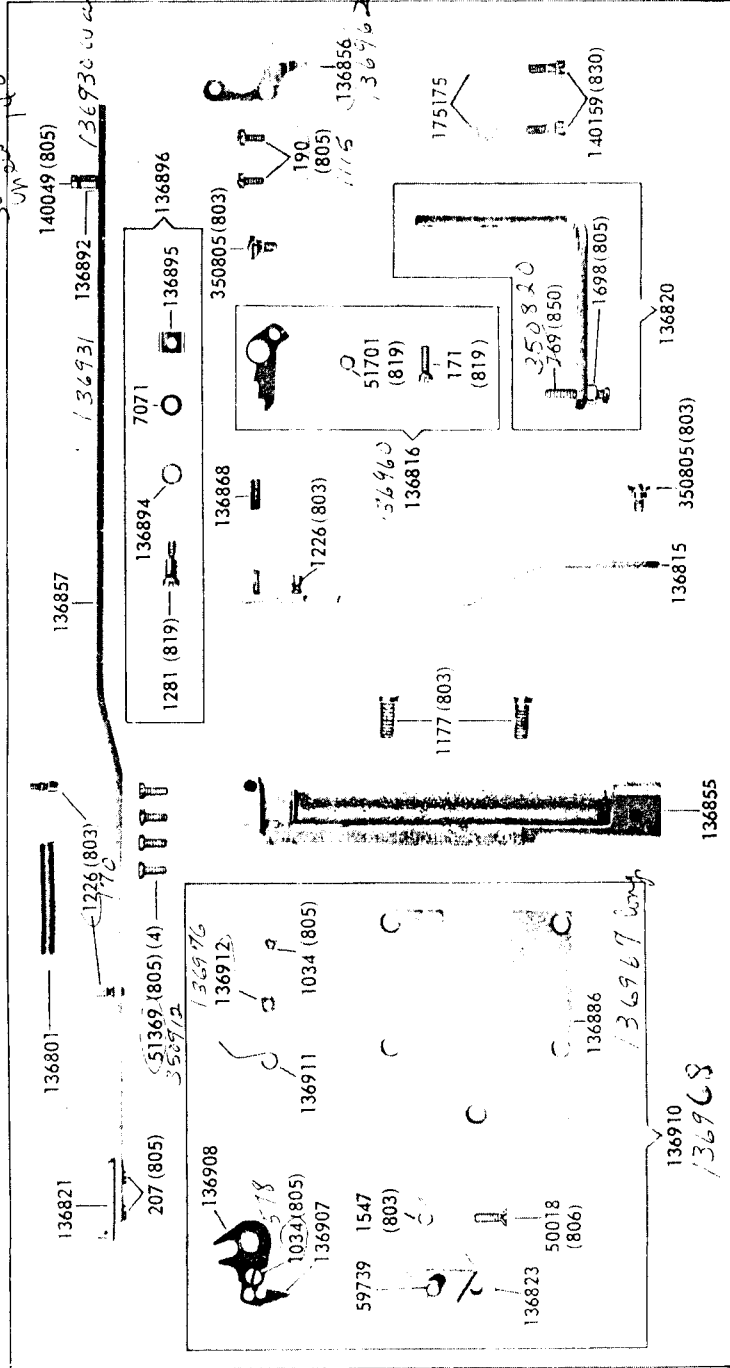

ch  
p  
p  
d  
p  
p  
ac  
re  
RI

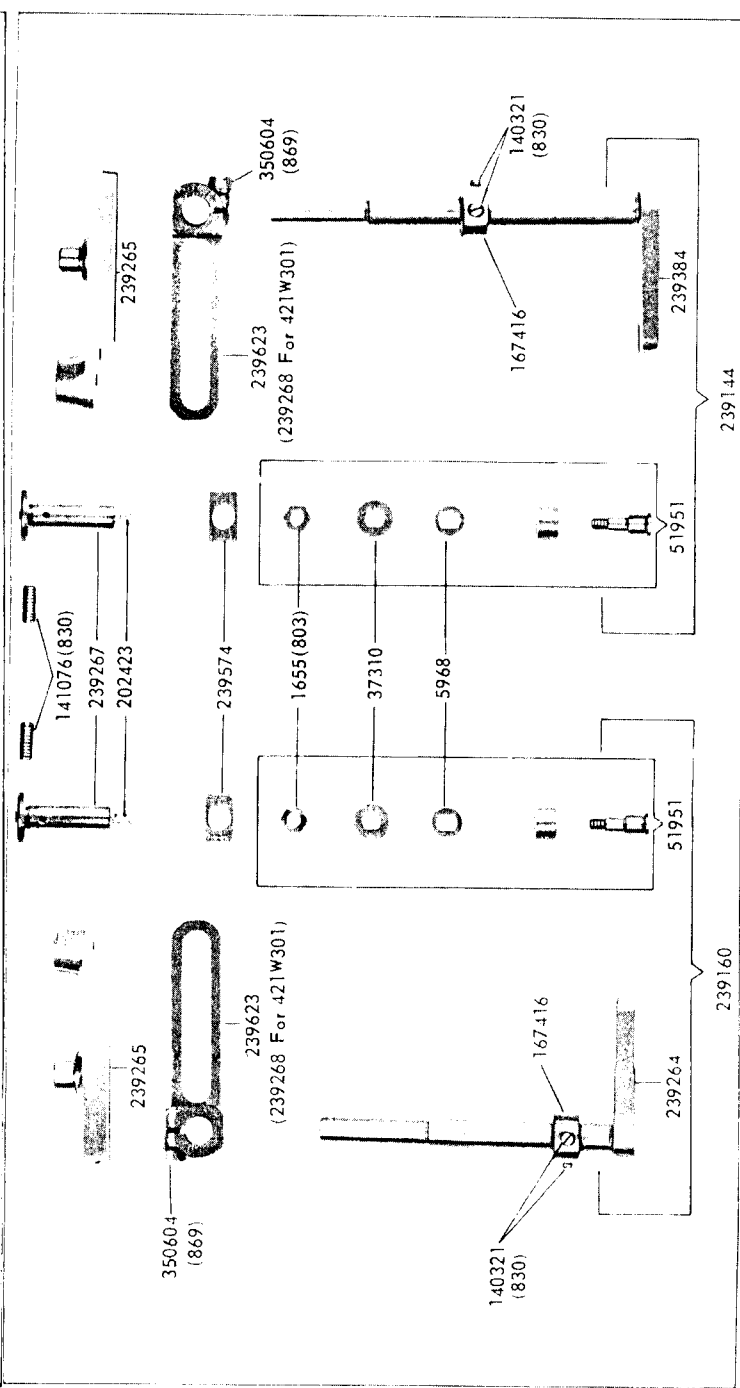
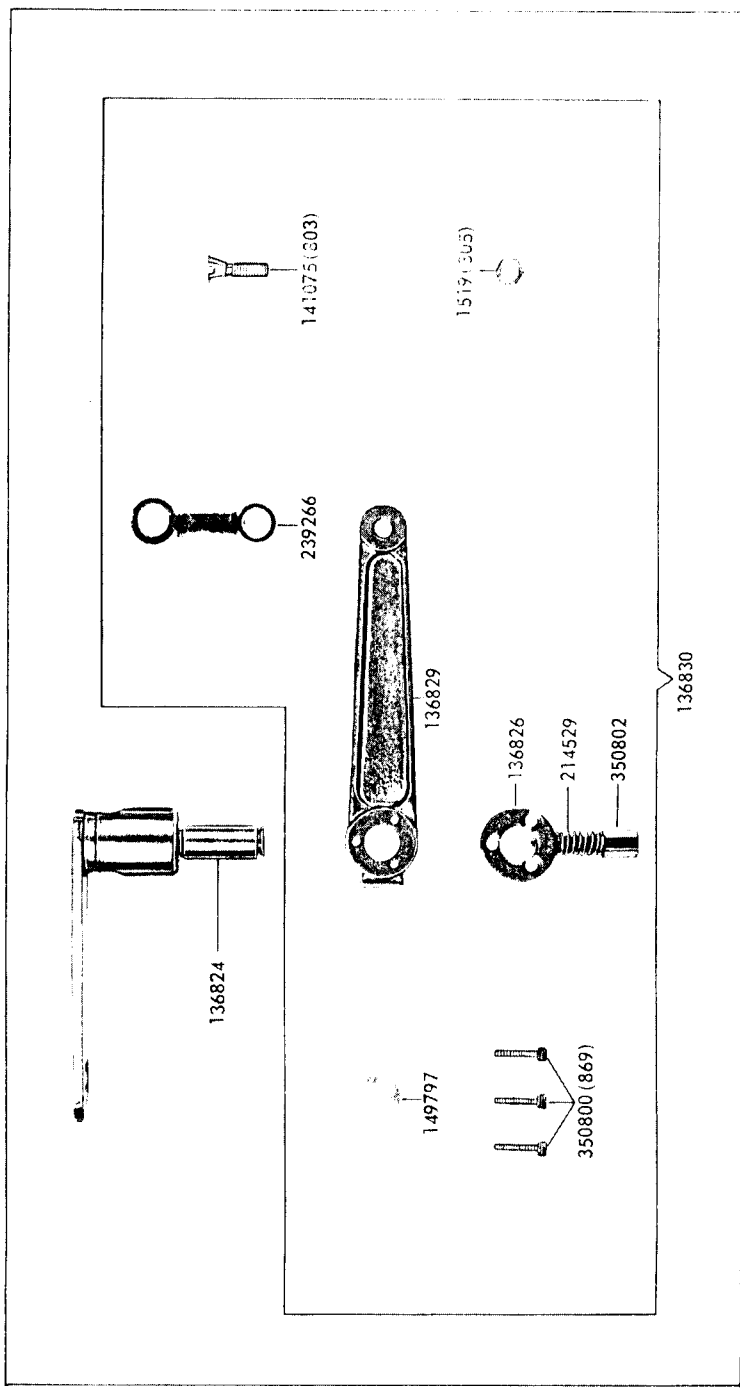

ch  
d  
d  
p  
p  
lac  
re  
R:

7201-12

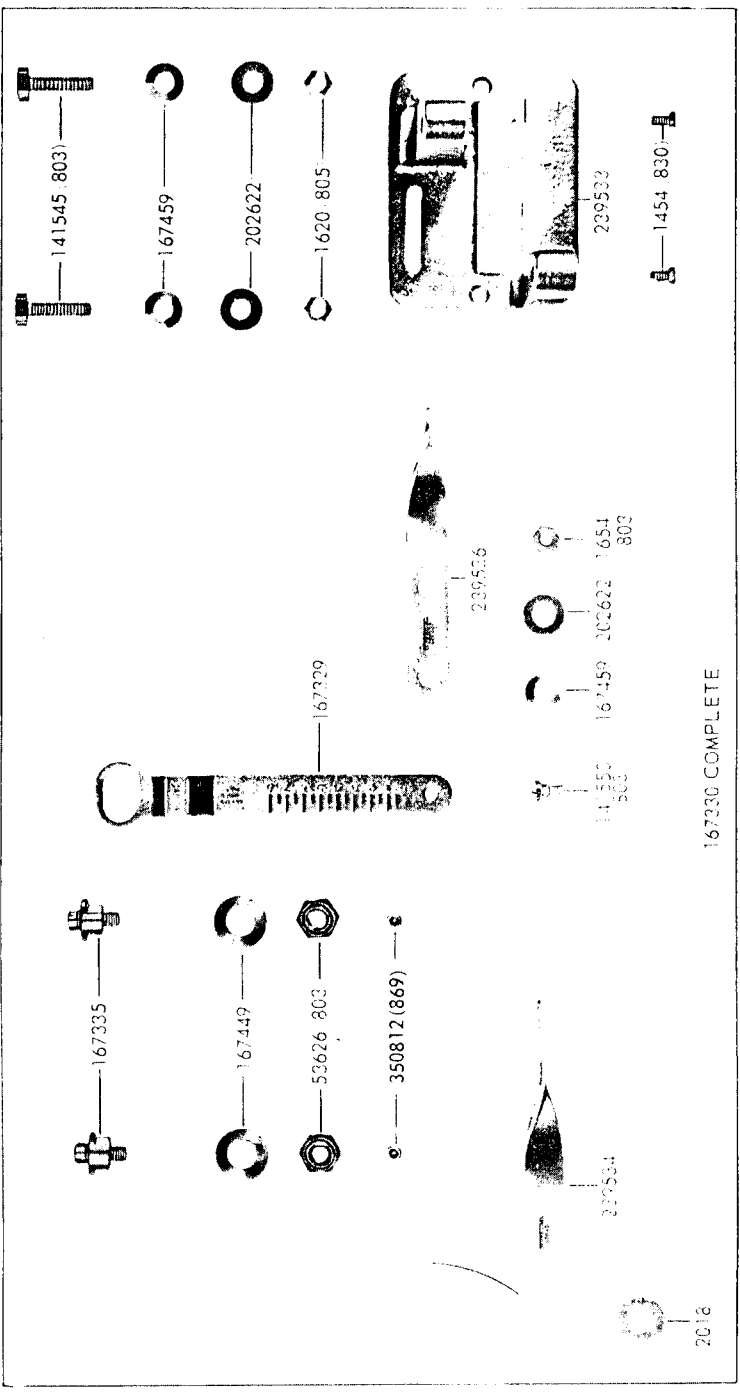

7201-13

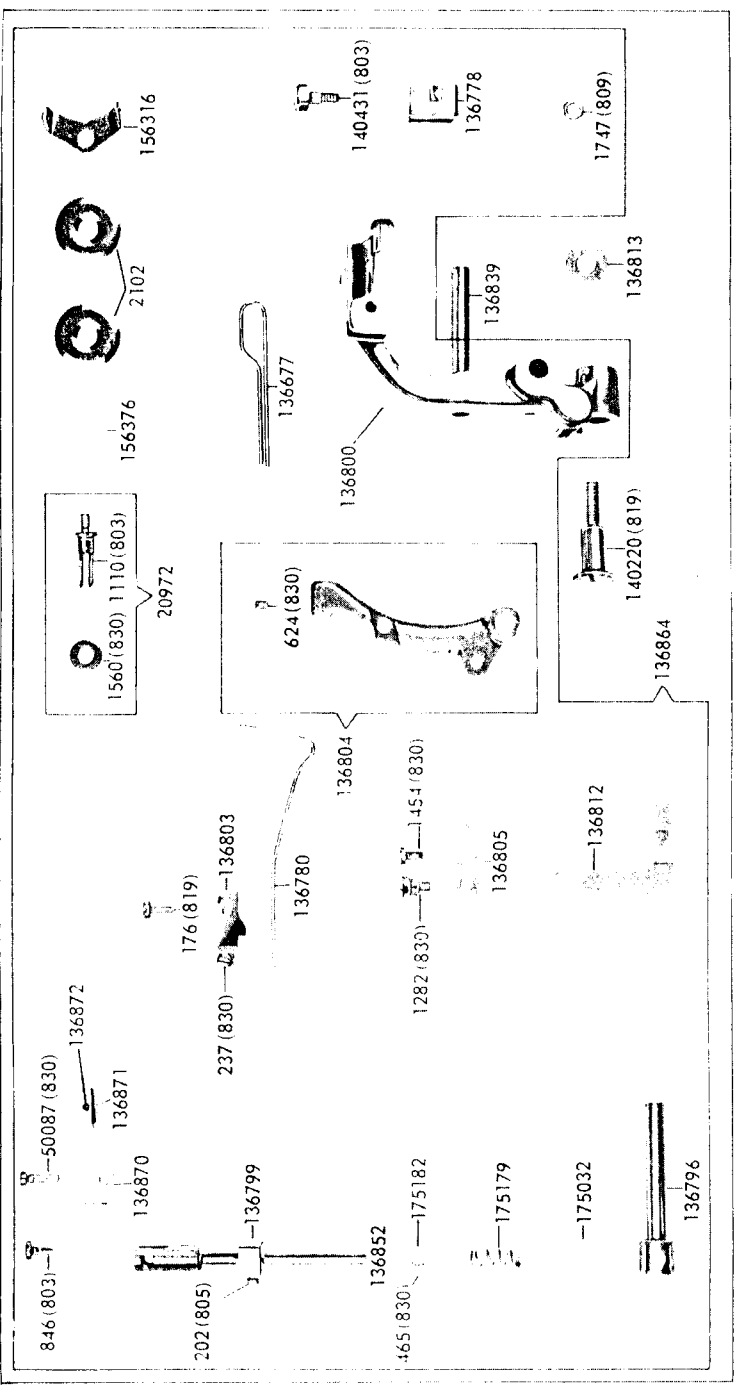

7201-14

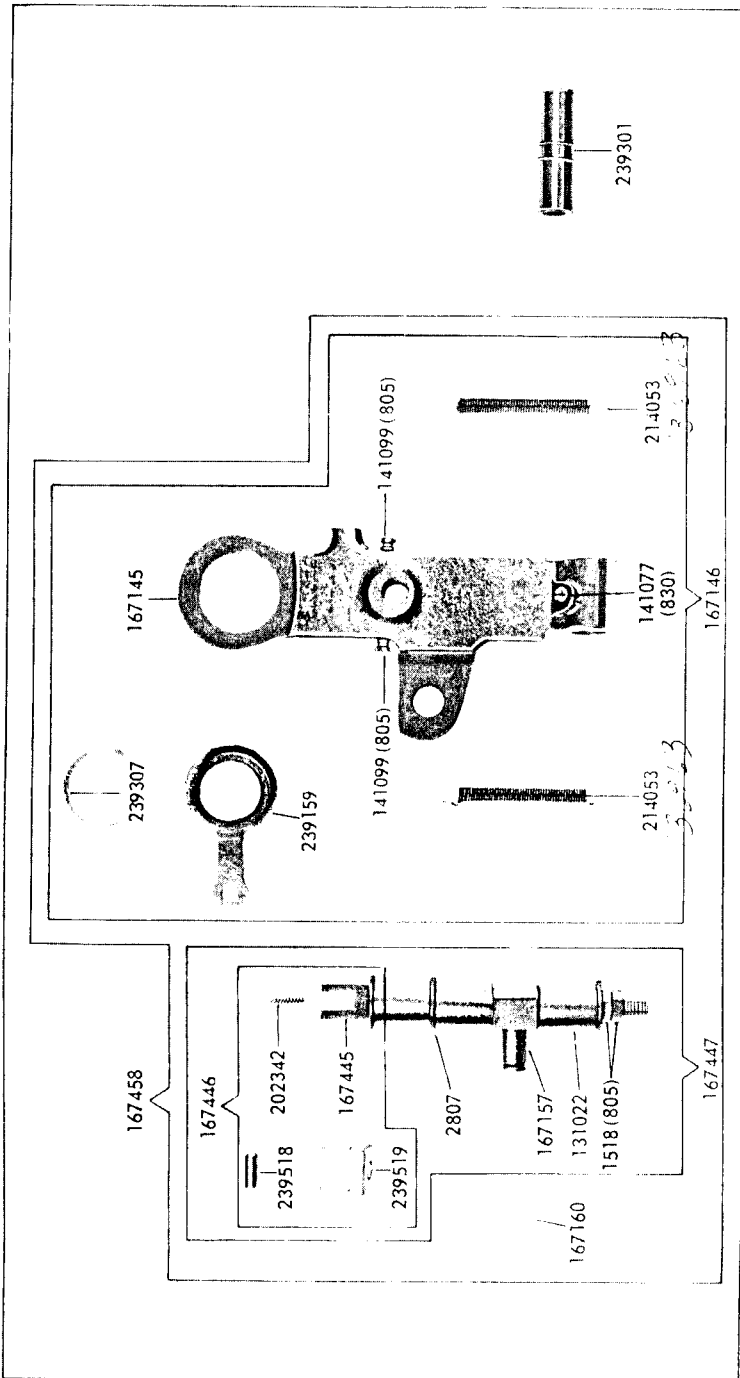

7201-15

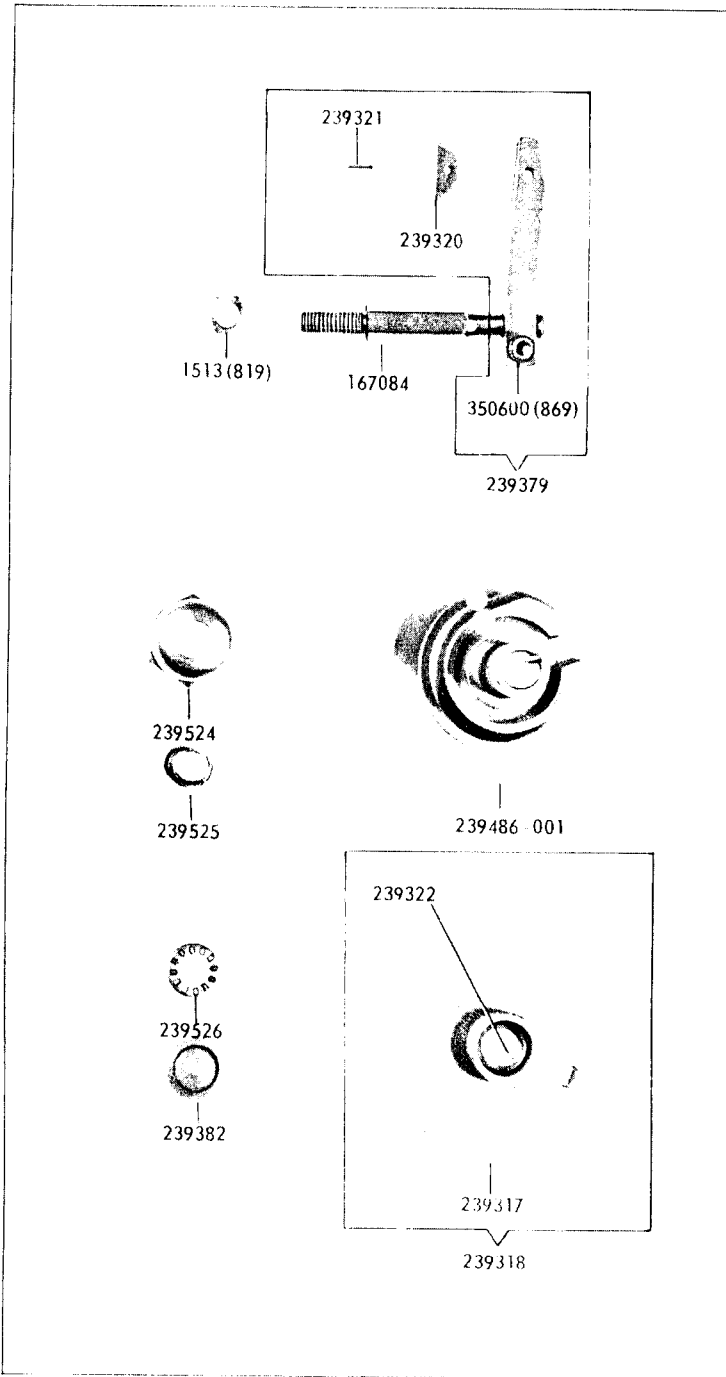

7201-16

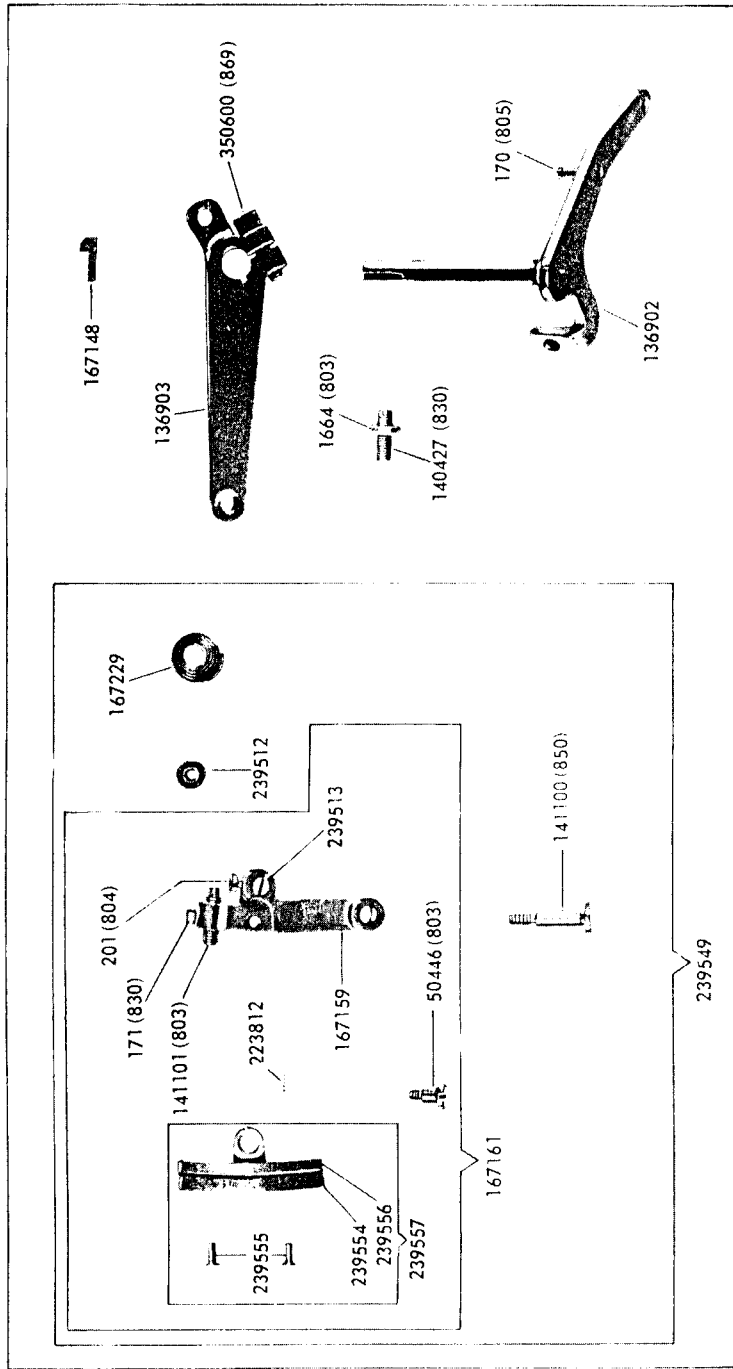

7201-17

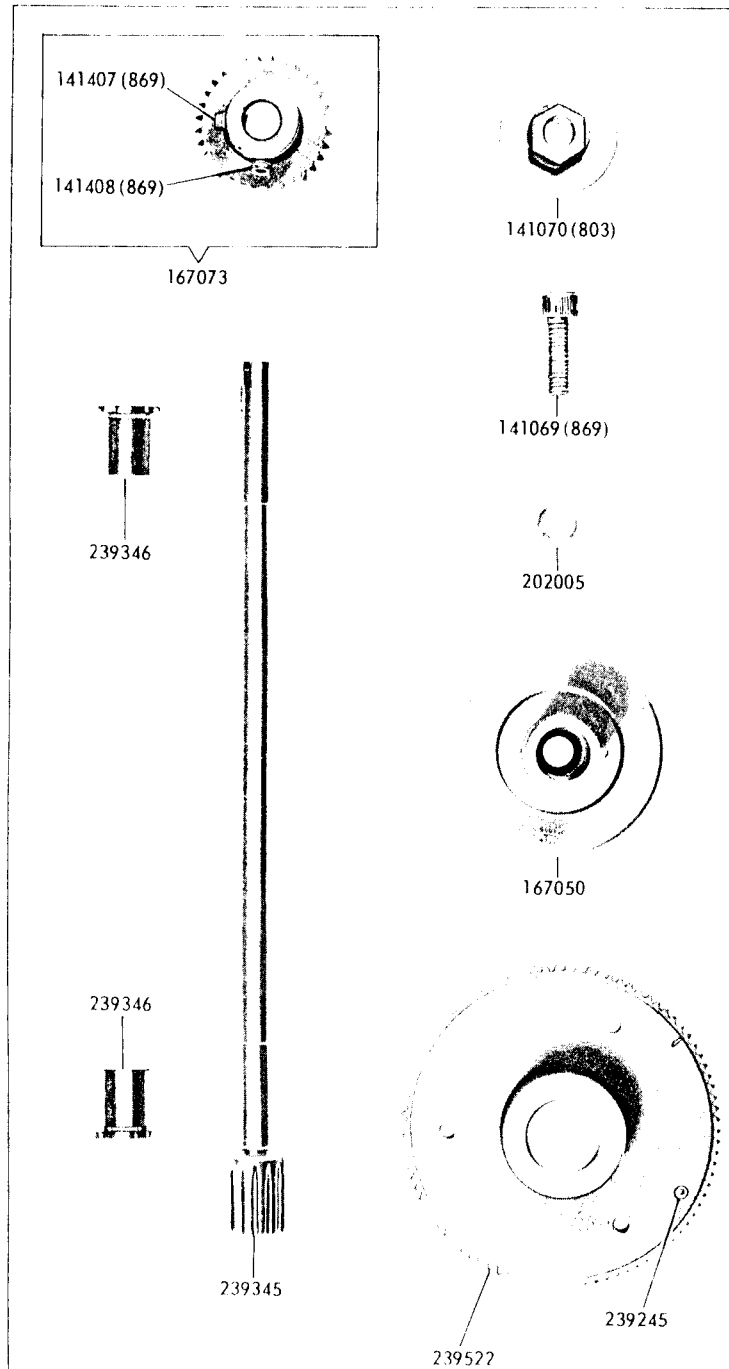

IR  
or  
la  
p  
p  
p  
p  
ch



7201-18

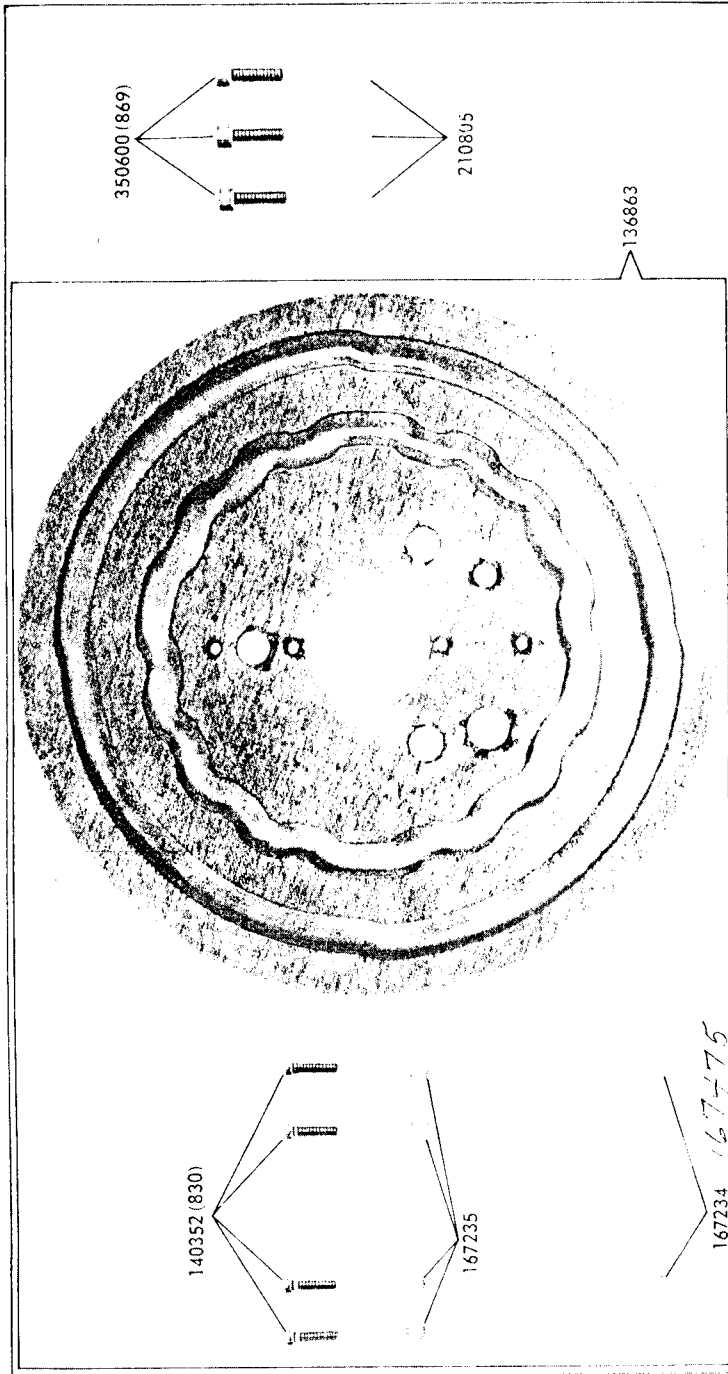

7201-19

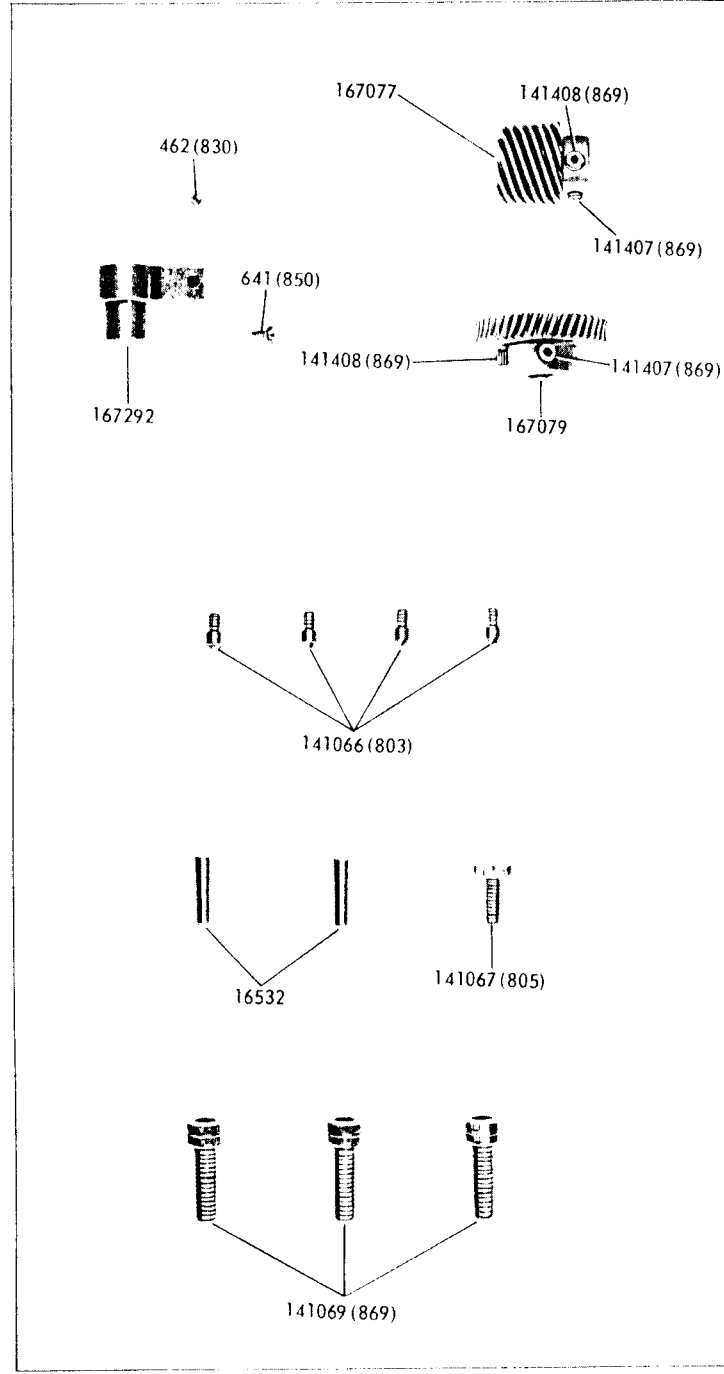

IR

r  
a

p

p

p

p

p

ch

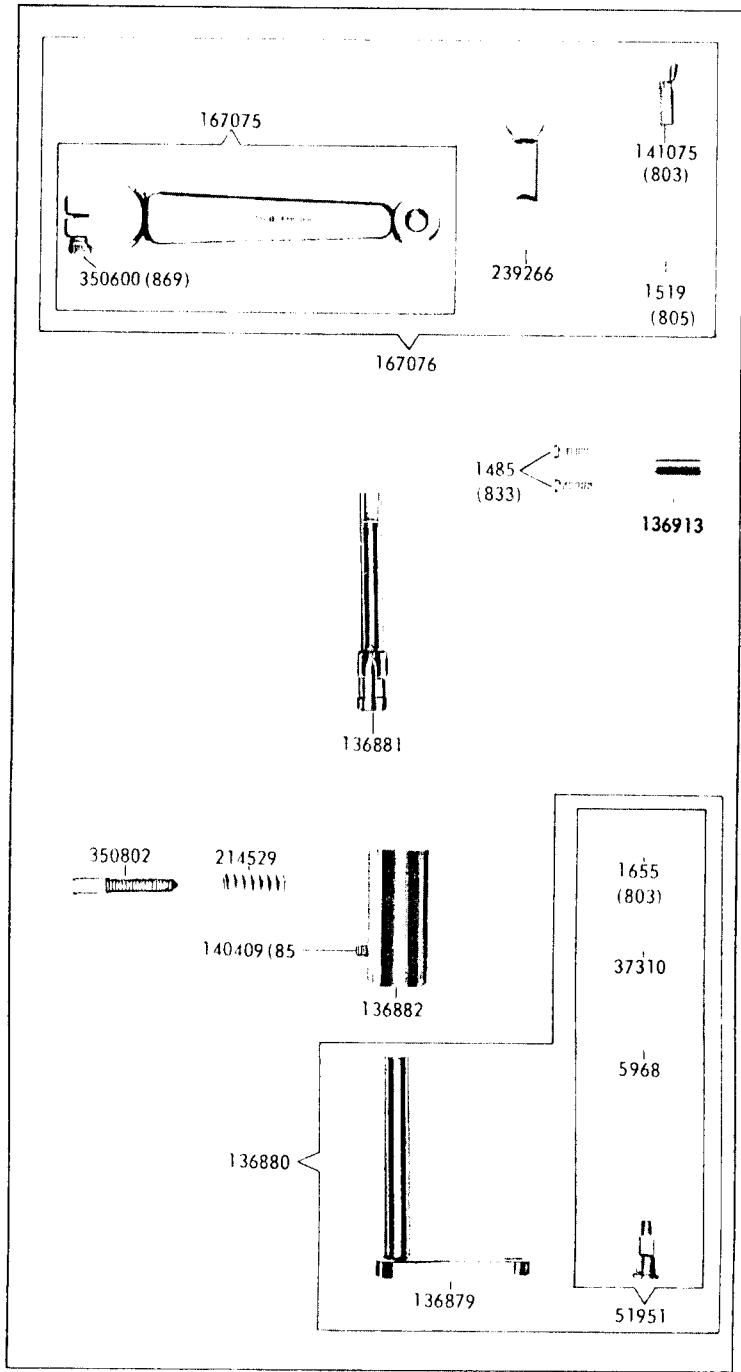
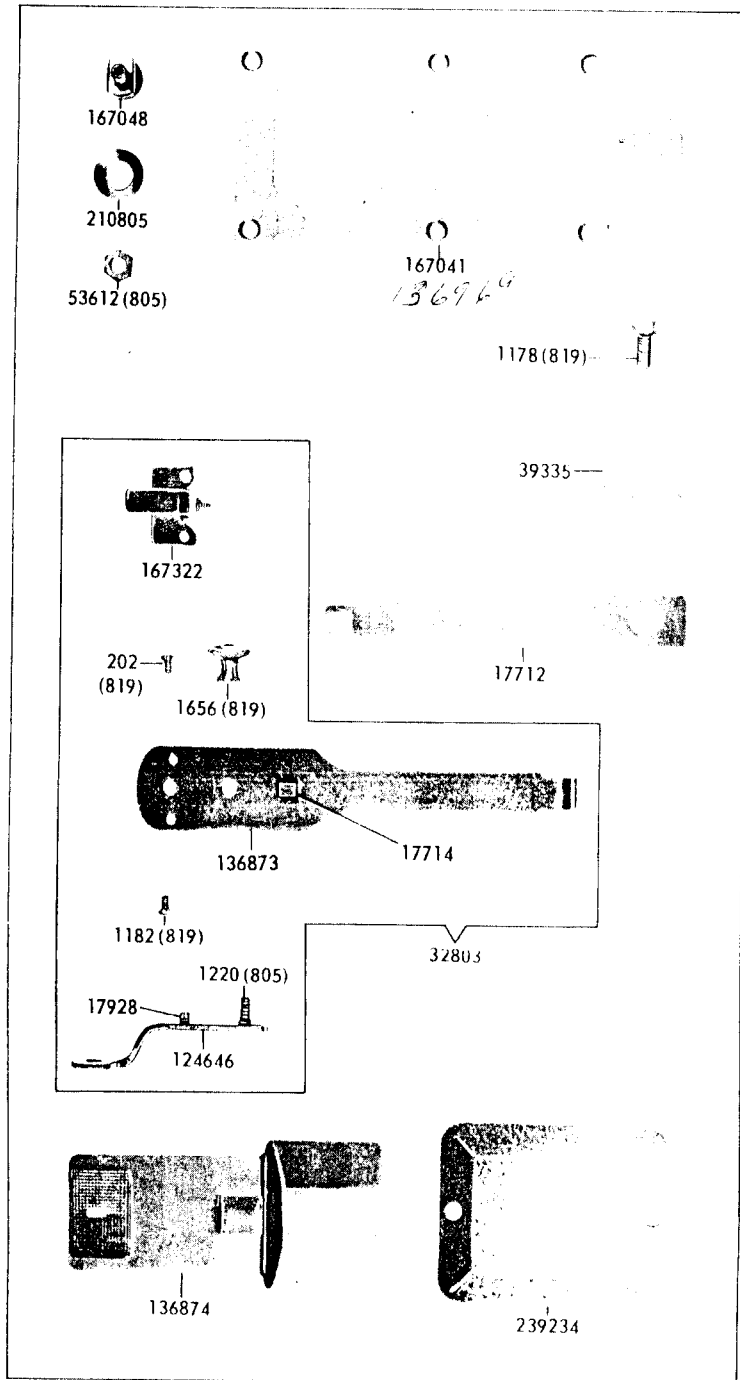

F  
r  
la  
p  
p  
p  
p  
p  
ch

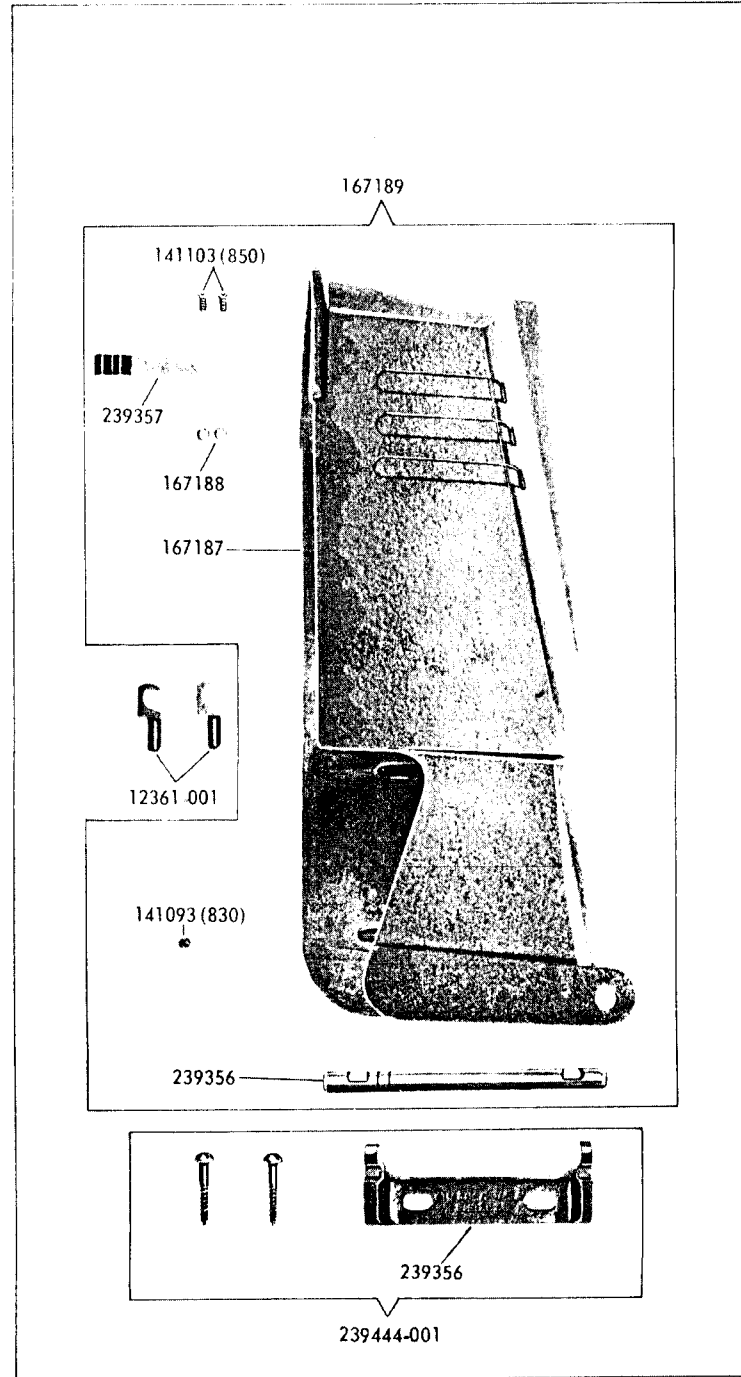
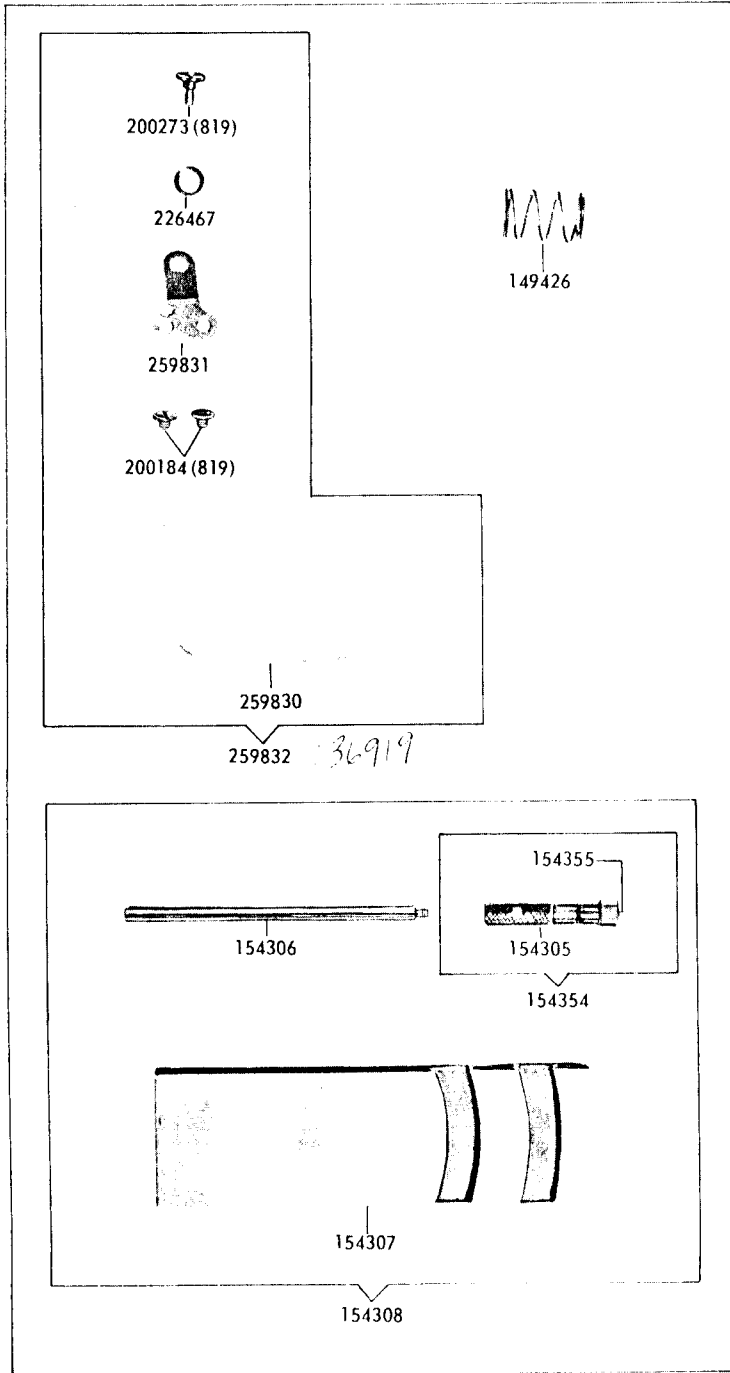

IF  
 r  
 la  
 p  
 p  
 p  
 p  
 p  
 :cl

7201-24

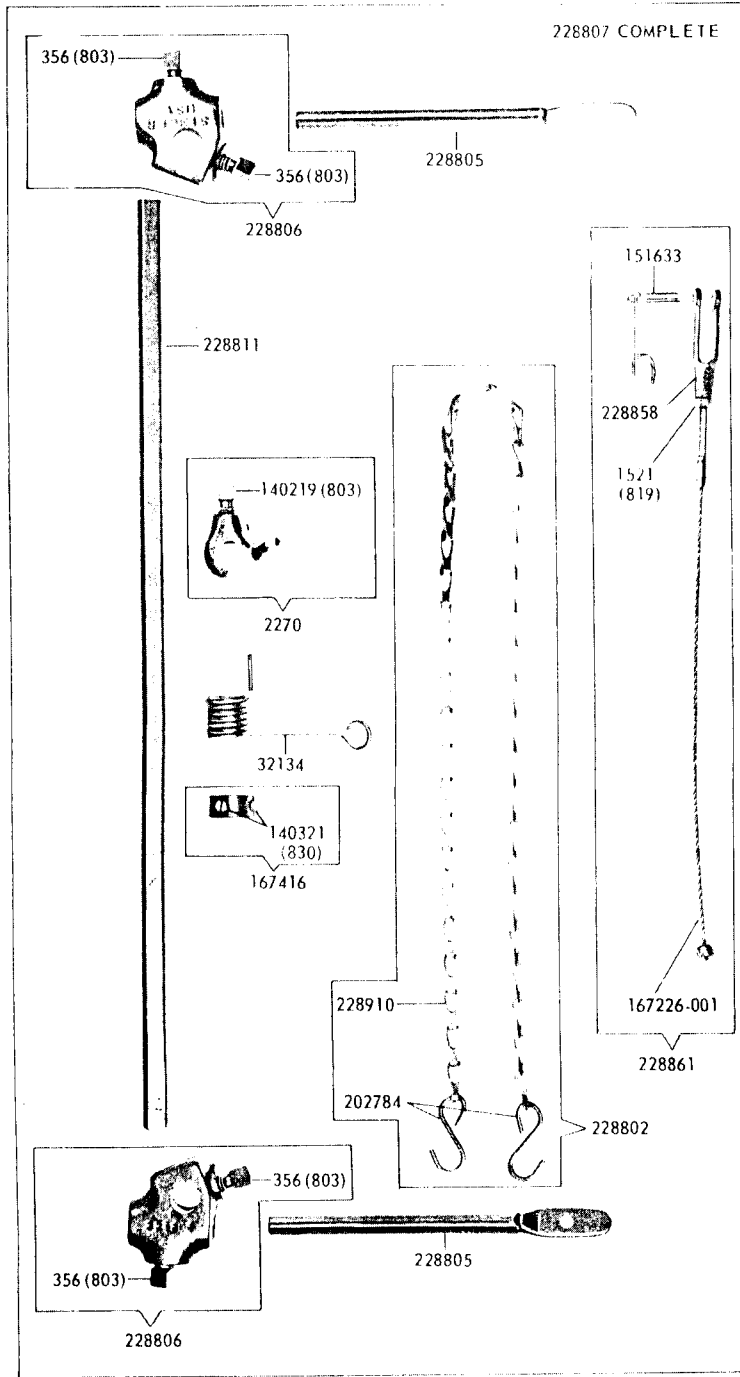

7201-25

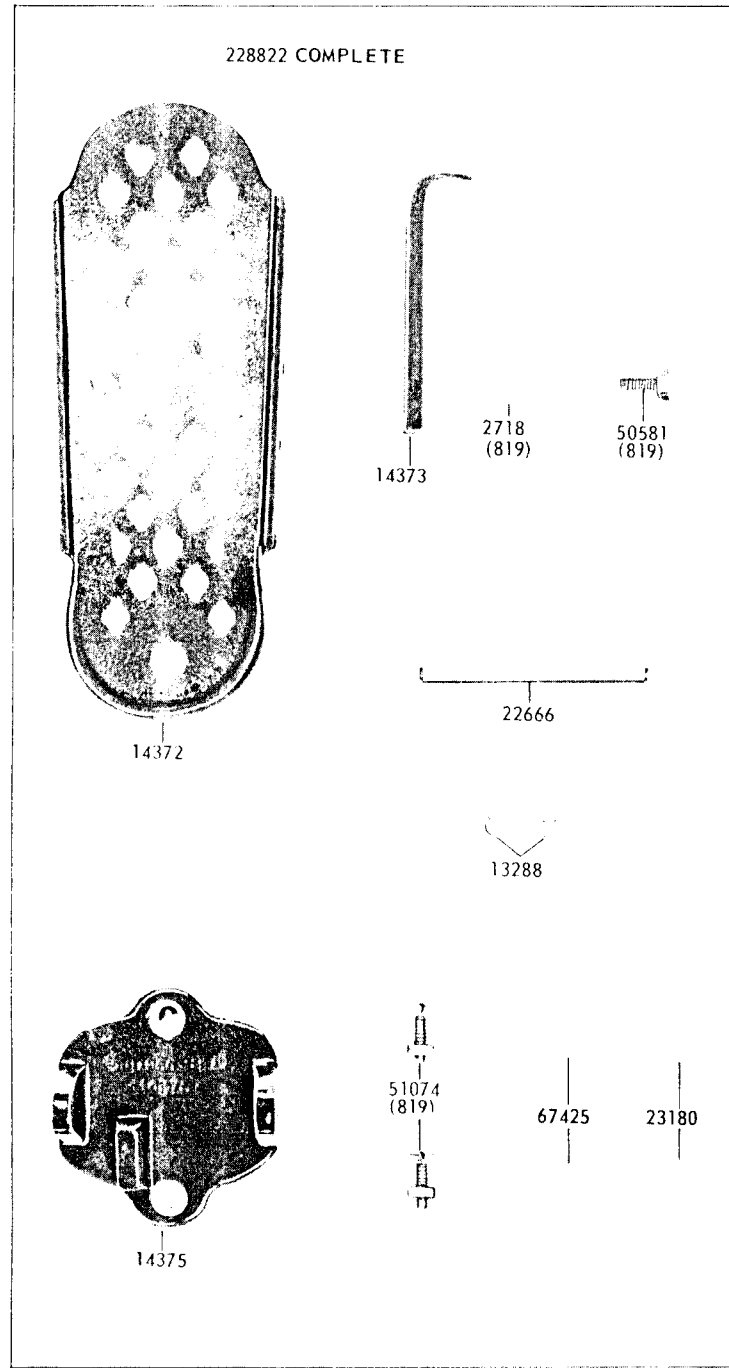

7201-26

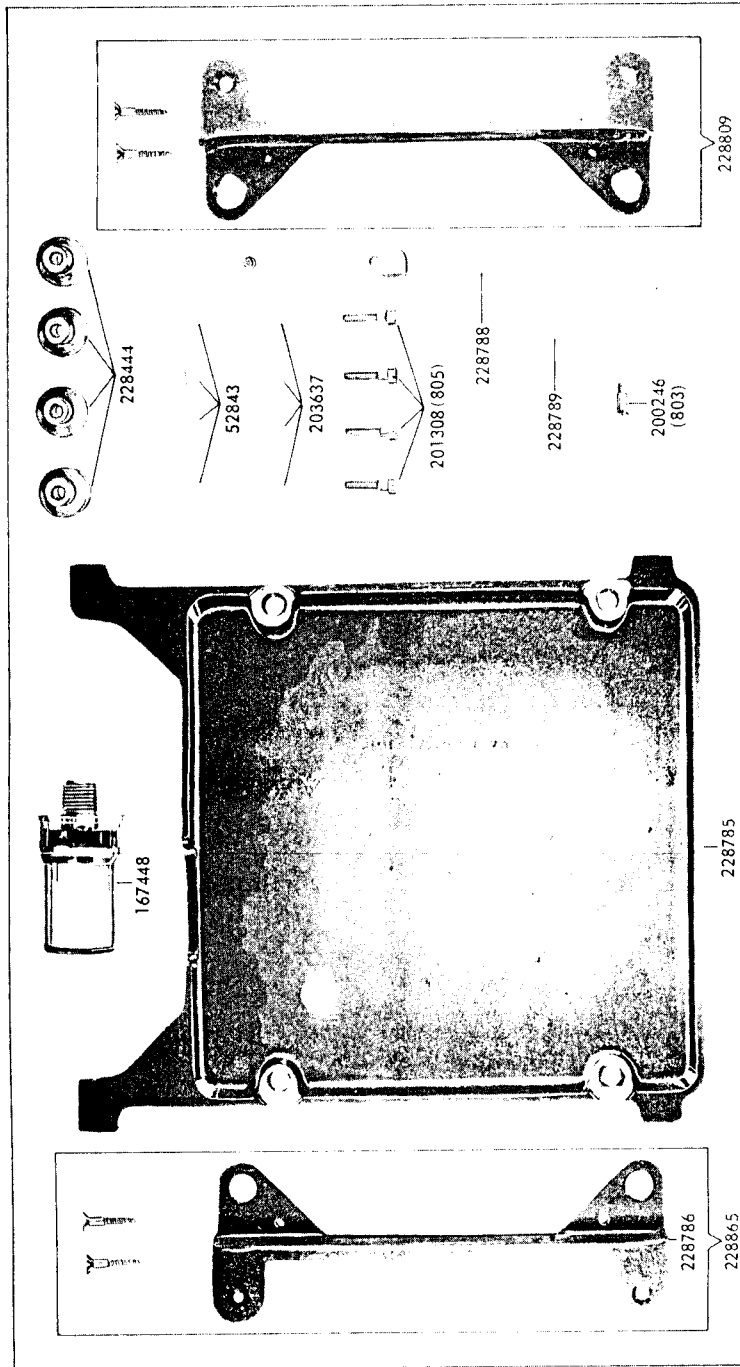

7201-27

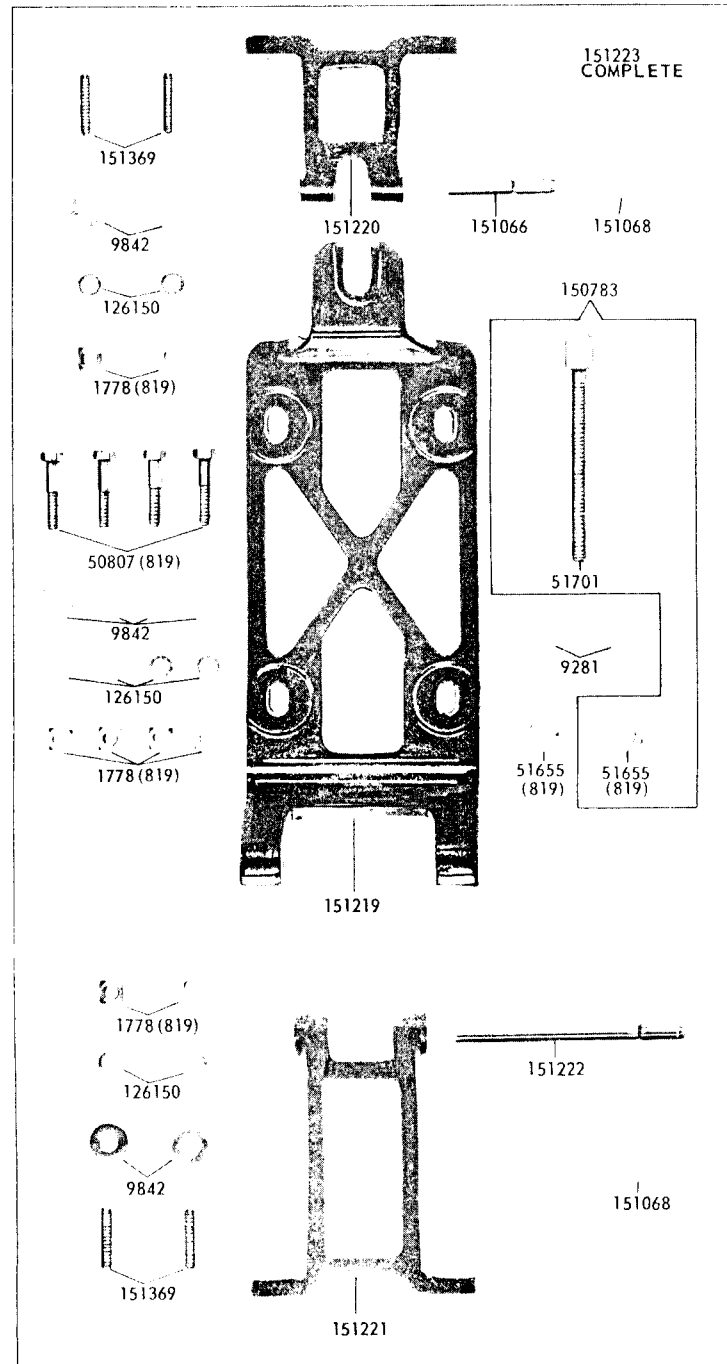

7201-28

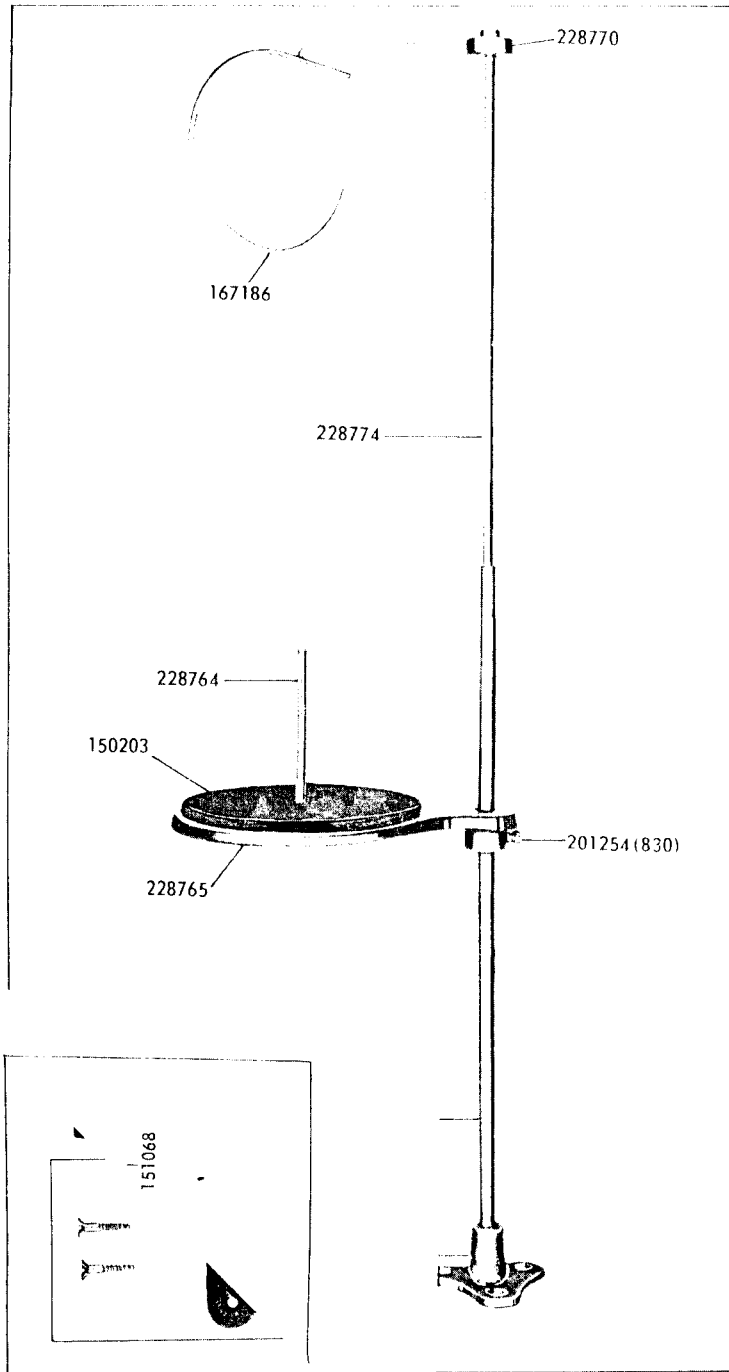

7201-29

